

# LICENSING SUB COMMITTEE

---

Wednesday, 4 April 2018 at 6.30 p.m.

The Council Chamber, Town Hall, Mulberry Place, 5 Clove Crescent,  
London, E14 2BG

This meeting is open to the public to attend.

**Contact for further enquiries:**

Farhana Zia, Senior Democratic Services Officer  
1st Floor, Town Hall, Mulberry Place, 5 Clove Crescent, E14 2BG  
Tel: 020 7364 0842  
E-mail: [farhana.zia@towerhamlets.gov.uk](mailto:farhana.zia@towerhamlets.gov.uk)  
Website: <http://www.towerhamlets.gov.uk/committee>

Scan this code  
for an electronic  
agenda





## Public Information

### **Attendance at meetings.**

The public are welcome to attend meetings of the Committee. However seating is limited and offered on a first come first served basis.

### **Audio/Visual recording of meetings.**

Should you wish to film the meeting, please contact the Committee Officer shown on the agenda front page.

### **Mobile telephones**

Please switch your mobile telephone on to silent mode whilst in the meeting.

### **Access information for the Town Hall, Mulberry Place.**

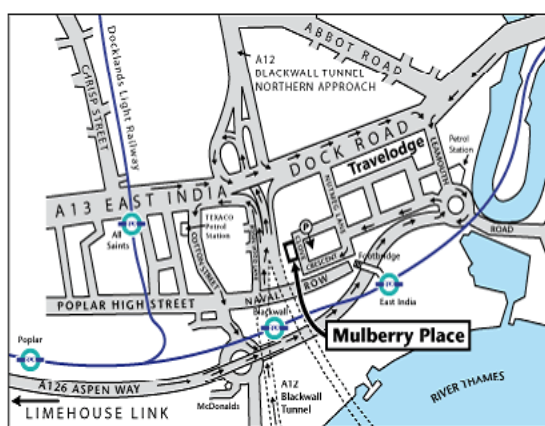

**Bus:** Routes: D3, D6, D7, D8, 15, 108, and 115 all stop near the Town Hall.

**Docklands Light Railway:** Nearest stations are

**East India:** Head across the bridge and then through the complex to the Town Hall, Mulberry Place

**Blackwall station:** Across the bus station then turn right to the back of the Town Hall complex, through the gates and archway to the Town Hall.

**Tube:** The closest tube stations are Canning Town and Canary Wharf

**Car Parking:** There is limited visitor pay and

display parking at the Town Hall (free from 6pm)

If you are viewing this on line: ([http://www.towerhamlets.gov.uk/content\\_pages/contact\\_us.aspx](http://www.towerhamlets.gov.uk/content_pages/contact_us.aspx))

### **Meeting access/special requirements.**

The Town Hall is accessible to people with special needs. There are accessible toilets, lifts to venues. Disabled parking bays and an induction loop system for people with hearing difficulties are available. Documents can be made available in large print, Braille or audio version. For further information, contact the Officers shown on the front of the agenda



### **Fire alarm**

If the fire alarm sounds please leave the building immediately by the nearest available fire exit without deviating to collect belongings. Fire wardens will direct you to the exits and to the fire assembly point. If you are unable to use the stairs, a member of staff will direct you to a safe area. The meeting will reconvene if it is safe to do so, otherwise it will stand adjourned.

### **Electronic agendas reports and minutes.**

Copies of agendas, reports and minutes for council meetings can also be found on our website from day of publication.

To access this, click [www.towerhamlets.gov.uk/committee](http://www.towerhamlets.gov.uk/committee) and search for the relevant committee and meeting date.

Agendas are available at the Town Hall, Libraries, Idea Centres and One Stop Shops and on the Mod.Gov, iPad and Android apps.



QR code for smart phone users.



## **APOLOGIES FOR ABSENCE**

To receive any apologies for absence.

### **1. DECLARATIONS OF DISCLOSABLE PECUNIARY INTEREST (Pages 7 - 10)**

To note any declarations of interest made by Members, including those restricting Members from voting on the questions detailed in Section 106 of the Local Government Finance Act, 1992. See attached note from the Monitoring Officer.

### **2. RULES OF PROCEDURE (Pages 11 - 20)**

To note the rules of procedure which are attached for information.

### **3. ITEMS FOR CONSIDERATION**

#### **3.1 Licensing Act 2003 Application for a Premises Licence for Di-Stefano Coffee Shop, 28 Hackney Road, London E2 7PA (Pages 21 - 144)**

Licensing Objectives:

- Public Nuisance
- Crime & Disorder
- Public Safety
- Prevention of Children from harm

Representations by:

- Local Resident(s)

#### **3.2 Application for a Premises Licence for Travelodge London City, 20 Middlesex Street, London E1 7EX (Pages 145 - 196)**

Licensing Objectives:

- Public Nuisance
- Crime & Disorder
- Public Safety

Representations by:

Local Resident(s)

### **4. EXTENSION OF DECISION DEADLINE: LICENSING ACT 2003**

The Sub Committee may be requested to extend the decision deadline for applications to be considered at forthcoming meetings due to the volume of applications requiring a hearing. Where necessary, details will be provided at the meeting.

This page is intentionally left blank

# Agenda Item 1

## **DECLARATIONS OF INTERESTS - NOTE FROM THE MONITORING OFFICER**

This note is for guidance only. For further details please consult the Members' Code of Conduct at Part 5.1 of the Council's Constitution.

Please note that the question of whether a Member has an interest in any matter, and whether or not that interest is a Disclosable Pecuniary Interest, is for that Member to decide. Advice is available from officers as listed below but they cannot make the decision for the Member. If in doubt as to the nature of an interest it is advisable to seek advice **prior** to attending a meeting.

### **Interests and Disclosable Pecuniary Interests (DPIs)**

You have an interest in any business of the authority where that business relates to or is likely to affect any of the persons, bodies or matters listed in section 4.1 (a) of the Code of Conduct; and might reasonably be regarded as affecting the well-being or financial position of yourself, a member of your family or a person with whom you have a close association, to a greater extent than the majority of other council tax payers, ratepayers or inhabitants of the ward affected.

You must notify the Monitoring Officer in writing of any such interest, for inclusion in the Register of Members' Interests which is available for public inspection and on the Council's Website.

Once you have recorded an interest in the Register, you are not then required to declare that interest at each meeting where the business is discussed, unless the interest is a Disclosable Pecuniary Interest (DPI).

A DPI is defined in Regulations as a pecuniary interest of any of the descriptions listed at **Appendix A** overleaf. Please note that a Member's DPIs include his/her own relevant interests and also those of his/her spouse or civil partner; or a person with whom the Member is living as husband and wife; or a person with whom the Member is living as if they were civil partners; if the Member is aware that that other person has the interest.

### **Effect of a Disclosable Pecuniary Interest on participation at meetings**

Where you have a DPI in any business of the Council you must, unless you have obtained a dispensation from the authority's Monitoring Officer following consideration by the Dispensations Sub-Committee of the Standards Advisory Committee:-

- not seek to improperly influence a decision about that business; and
- not exercise executive functions in relation to that business.

If you are present at a meeting where that business is discussed, you must:-

- Disclose to the meeting the existence and nature of the interest at the start of the meeting or when the interest becomes apparent, if later; and
- Leave the room (including any public viewing area) for the duration of consideration and decision on the item and not seek to influence the debate or decision

When declaring a DPI, Members should specify the nature of the interest and the agenda item to which the interest relates. This procedure is designed to assist the public's understanding of the meeting and to enable a full record to be made in the minutes of the meeting.

Where you have a DPI in any business of the authority which is not included in the Member's register of interests and you attend a meeting of the authority at which the business is considered, in addition to disclosing the interest to that meeting, you must also within 28 days notify the Monitoring Officer of the interest for inclusion in the Register.

### **Further advice**

For further advice please contact:-

Asmat Hussain, Corporate Director, Governance and Monitoring Officer, Tel 020 7364 4800



## APPENDIX A: Definition of a Disclosable Pecuniary Interest

(Relevant Authorities (Disclosable Pecuniary Interests) Regulations 2012, Reg 2 and Schedule)

Subject	Prescribed description
Employment, office, trade, profession or vacation	Any employment, office, trade, profession or vocation carried on for profit or gain.
Sponsorship	<p>Any payment or provision of any other financial benefit (other than from the relevant authority) made or provided within the relevant period in respect of any expenses incurred by the Member in carrying out duties as a member, or towards the election expenses of the Member.</p> <p>This includes any payment or financial benefit from a trade union within the meaning of the Trade Union and Labour Relations (Consolidation) Act 1992.</p>
Contracts	<p>Any contract which is made between the relevant person (or a body in which the relevant person has a beneficial interest) and the relevant authority—</p> <p>(a) under which goods or services are to be provided or works are to be executed; and</p> <p>(b) which has not been fully discharged.</p>
Land	Any beneficial interest in land which is within the area of the relevant authority.
Licences	Any licence (alone or jointly with others) to occupy land in the area of the relevant authority for a month or longer.
Corporate tenancies	<p>Any tenancy where (to the Member's knowledge)—</p> <p>(a) the landlord is the relevant authority; and</p> <p>(b) the tenant is a body in which the relevant person has a beneficial interest.</p>
Securities	<p>Any beneficial interest in securities of a body where—</p> <p>(a) that body (to the Member's knowledge) has a place of business or land in the area of the relevant authority; and</p> <p>(b) either—</p> <p>(i) the total nominal value of the securities exceeds £25,000 or one hundredth of the total issued share capital of that body; or</p> <p>(ii) if the share capital of that body is of more than one class, the total nominal value of the shares of any one class in which the relevant person has a beneficial interest exceeds one hundredth of the total issued share capital of that class.</p>

This page is intentionally left blank

## TOWER HAMLETS



### LICENSING COMMITTEE

#### **RULES OF PROCEDURE GOVERNING APPLICATIONS FOR PREMISES LICENCES AND OTHER PERMISSIONS UNDER THE LICENSING ACT 2003**

<b>Date Last Reviewed:</b>	<b>14<sup>th</sup> June 2016</b>
<b>Reviewed By:</b>	<b>Senior Corporate and Governance Legal Officer</b>
<b>Approved By:</b>	<b>Licensing Committee</b>
<b>Date Approved:</b>	<b>14<sup>th</sup> June 2016</b>
<b>Version No.</b>	<b>1</b>
<b>Document Owner:</b>	<b>Paul Greeno</b>
<b>Post Holder:</b>	<b>Senior Corporate and Governance Legal Officer</b>
<b>Date of Next Scheduled Review:</b>	<b>31<sup>st</sup> March 2018</b>

## **1. Interpretation**

- 1.1 These Procedures describe the way in which hearings will be conducted under the Licensing Act 2003, as set out in the Licensing Act 2003 (Hearings) Regulations 2005 (as amended) ('the Hearings Regulations'). The Procedures take into account the Licensing Act (Premises Licences and Club Premises Certificates) Regulations 2005.
- 1.2 Except where otherwise stated, references in this Code are to the Licensing Committee and its Sub-committees and the expression 'Licensing Committee' should be interpreted accordingly.
- 1.3 The Hearings Regulations provide (Regulation 21) that a Licensing Authority shall, subject to the provisions of those Regulations, determine for itself the procedure to be followed at a hearing.
- 1.4 These Procedures, therefore, set out the way in which Licensing Committee Meetings will be conducted under the Licensing Act 2003, following the requirements of the Hearings Regulations.
- 1.5 Proceedings will not be rendered void only as the result of failure to comply with any provision of the Hearings Regulations (Regulation 31) save that in any case of such an irregularity, the Licensing Committee shall, if it considers that any person may have been prejudiced as a result of the irregularity, take such steps as it thinks fit to cure the irregularity before reaching its determination (Regulation 32).

## **2. Composition of Sub-Committee**

- 2.1 The Sub-Committee will consist of three (3) members and no business shall be transacted unless three (3) members of the Licensing Committee are present and able to form a properly constituted Licensing Sub-Committee. In such cases the Chair shall have a second or casting vote.

## **3. Procedure**

- 3.1 The hearing shall take place in public save that the Licensing Committee may exclude the public from all or part of a hearing where it considers that, on balance, it is in the public interest to do so. The parties and any person representing them may be excluded in the same way as another member of the public. Any person so excluded may, before the end of the hearing, submit to the Licensing Committee in writing, any information which, they would have been entitled to give orally had they not been required to leave. Where there are a number of items on the agenda, the adjournment of that item for a short period, whilst another item is heard, may allow this process to be carried out effectively.

- 3.2 The Chair will begin by asking the parties to identify themselves and confirm whether or not they are represented.
- 3.3 The Licensing Committee should always satisfy itself that sufficient notice of the hearing has been given to all parties and if not satisfied, then the Licensing Committee should take such steps as it thinks fit to deal with that issue before reaching its determination and this could include adjourning that application to a later date.
- 3.4 The Licensing Committee will then consider any requests by a party for any other person to be heard at the hearing in accordance with the Regulations. Permission will not be unreasonably withheld provided proper notice has been given.
- 3.5 The Chair will then explain how the proceedings will be conducted, and indicate any time limits that may apply to the parties to the application. In setting time limits, the Licensing Committee will take into account the importance of ensuring that all parties receive a fair hearing, and the importance of ensuring that all applications are determined expeditiously and without undue delay. Further the Licensing Committee must have regard to the requirement to allow each party an equal amount of time.
- 3.6 If a party considers that any time limit is not sufficient then they should address the Licensing Committee and which will determine accordingly.
- 3.7 If any party has informed the Authority that they will not be attending or be represented at the hearing or any party does not give notice that they will not be attending but fails to attend and is not represented, the Licensing Committee may proceed in their absence or adjourn the hearing if it considers it to be necessary in the public interest. An adjournment will not be considered where due to the operation of the Hearing Regulations it would not be possible to adjourn.
- 3.8 If the Licensing Committee adjourns the hearing to a specified date it must specify the date, time and place to which the hearing has been adjourned and why it is considered necessary in the public interest.
- 3.9 If the Licensing Committee holds the hearing in the absence of a party, it will consider at the hearing the application, representation or notice given by that party.
- 3.10 The Chair will invite an Officer of the Licensing Section to present the report by briefly summarising the application and the number and type of the representations as set out in the papers circulated. The Officer will also advise of any discussions held with the parties; any amendments made to the application; any representations withdrawn; and any agreed conditions that the Licensing Committee is being asked to consider. The Officer shall not give

any opinion on the application or ask the Committee to make an inference based on such an opinion.

- 3.11 Members of the Licensing Committee can then ask questions of clarification of the Licensing Officer or seek legal advice from the Legal Adviser to the Licensing Committee if they require in respect of matters raised during the presentation by the Licensing Officer.
- 3.12 The Legal Adviser to the Licensing Committee will then give any relevant legal advice that the Licensing Committee need to take into consideration.
- 3.13 The Chair will then ask the applicant or their representative, if present, to present a summary of the nature and extent of the application. This should be brief, avoid repetition of material already available to the Licensing Committee in the Officer's report or otherwise, and include any reasons why an exception should be made to the Council's Licensing Policy, where appropriate, and respond to the written representations received. The submission may be followed by the evidence of any person who has been given permission by the Committee to give supporting evidence on behalf of the applicant or who has made a representation in favour of the application.
- 3.14 The application is to be presented within the time limit that has been set.
- 3.15 Where an applicant is unrepresented and having difficulty in presenting their application then the Legal Adviser to the Licensing Committee may ask questions of the applicant so that the relevant points are addressed and clarified for the Licensing Committee.
- 3.16 Members of the Licensing Committee may ask questions of the person presenting the case after their address as well as any other person who has spoken in support of the application. Members can also ask questions of the applicant as well as any other person present for the applicant who they consider can assist.
- 3.17 The Legal Adviser to the Licensing Committee may ask questions for the purpose of clarifying points for the Licensing Committee.
- 3.18 The Chair will then ask the persons who have made representations against the application to address the Licensing Committee within the time limit that has been set. They should not repeat what is already set out in their representations or notice or raise new matters. In their address they should provide clarification on any points previously requested by the Council. The submission may be followed by the evidence of any person who has been given permission by the Committee to give supporting evidence.
- 3.19 Members of the Licensing Committee may then ask questions of the persons making representations against the application and any other person who has

spoken in support of such representation. Members can also ask questions of any other person present who they consider can assist.

- 3.20 The Legal Adviser to the Licensing Committee may ask questions for the purpose of clarifying points for the Licensing Committee.
- 3.21 Petitions will be treated as representations provided they meet the requirements for relevant representations set out in the Licensing Act 2003. Members should proceed with caution when relying upon petitions used as evidence due to the structure and wording used.
- 3.22 The Licensing Committee will disregard any information given by a party, or any other person appearing at the hearing, which is not relevant to:
  - a) their application, representation or notice; and
  - b) the promotion of the licensing objectives or the crime prevention objective where notice has been given by the police.
- 3.23 The Chair will intervene at any stage of the hearing to prevent repetitious or irrelevant points being raised.
- 3.24 Cross examination of any party or any other person allowed to appear will not be allowed unless specifically permitted by the Chair.
- 3.25 There is no right for any party to sum up but they may be permitted to do at the discretion of the Chair and within time limits prescribed by the Chair.
- 3.26 The Licensing Committee will consider its decision in private save that the Legal Adviser and Democratic Services Officer will remain with them.
- 3.27 The Licensing Committee will normally return to open session to announce its decision but in cases where the prescribed time limit allows for a later determination and it is appropriate to determine the matter within that time then the Chair will advise the parties present that the decision will not be announced then but that the determination will take place within the prescribed time limit and that written notification will be dispatched to all parties advising them of the determination.

#### **4. Exclusions**

- 4.1 In addition to any exclusion under paragraph 3.1 above, The Licensing Committee may require any person attending the hearing who in their opinion is behaving in a disruptive manner to leave the hearing and may refuse to permit the person to return; or allow them to return only on such conditions as Licensing Committee may specify.

- 4.2 Any person so excluded may, before the end of the hearing, submit to the Authority in writing, any information which, they would have been entitled to give orally had they not been required to leave.



## Guidance for Licensing Sub-Committee Meetings.

### (1) Attendance at Meetings.

All meetings of the Sub-Committee are open to the public and press to attend. On rare occasions, the Sub-Committee may retire to consider private business that will be clearly marked on the agenda as such. The press and public will be excluded for those confidential items only. We try to keep confidential reports to an absolute minimum. We request that you show courtesy to all present and please keep mobile phones on silent. Meetings can reach full capacity and seats are allocated on a first come first come served basis.

### (2) Licensing Sub-Committee Role and Membership.

In summary, the Sub-Committee will consider and determine applications to grant, vary or review a license submitted under the Licensing Act 2003 where representations have been made. The full terms of reference can be found on the Committee webpages (see below). The Licensing Sub-Committee will consist of 3 Members of the main Licensing Committee. Meetings are normally held in the Town Hall Council Chamber.

#### Licensing Sub-Committee Webpages

To view go to the Committee and Member Services web page:  
[www.towerhamlets.gov.uk/committee](http://www.towerhamlets.gov.uk/committee) - 'agenda, reports, decisions and minutes', then click on 'Licensing Sub-Committee'.

The pages include:

- Terms of Reference for the Licensing Sub-Committee.
- Meeting dates, agendas and minutes.
- Agenda timetable including agenda publication dates. (To view click 'browse meetings and agendas for this committee', then 'show agenda management timetable').

### (3) Access to Committee Papers.

The agenda for Sub-Committee meetings is published five clear (working) days before the Sub-Committee meeting on the Committee webpages (except for certain types of applications where special rules apply). All Committee papers (i.e. agendas, reports, minutes and decisions) are published on the website and also available on iPad and Android tablet apps downloadable for free from their respective app stores.

### (4) Who can speak at Licensing Sub-Committee meetings?

Only interested parties may address the Sub-Committee (those who have made a valid representation) and the applicant and their representatives. Although the Sub-Committee may allow other persons to present the interested parties evidence or to give supporting evidence. If you are planning to attend the hearing to address the committee, you are advised to contact the Committee officer - see the Committee

pages and agenda front page for contact details. Speakers are advised to arrive at the start of the meeting in case the order of business is changed. Speakers will be called to speak by the Chair at the appropriate time. If speakers are not present by the time their application is heard, the Committee may consider the item in their absence.

**(5) What can be circulated?**

Should you wish to submit any material, please contact the Committee/Licensing Officer as soon as possible. The Sub-Committee may accept information at the hearing, however this is only with the agreement of all parties present.

**(6) How will the applications be considered?**

The Sub-Committee will normally consider the items in agenda order subject to the Chair’s discretion. The hearing procedure is detailed at the end of this guidance.

**(7) How can I find out about a decision?**

You can contact Democratic Services the day after the meeting to find out the decisions.

**(8) Queries on reports.**

For any questions, please contact the Officer named on the front of the report.

Typical Seating Plan for Licensing Sub - Committee Meetings in the Town Hall Council Chamber.

Public Seating		Objectors Benches		Sub-Committee Members
Public Seating				Chair
Public Seating				Legal Officer
Public Seating		Applicants Benches		Committee Officer
Public Seating				Licensing Officer

## **LICENSING SUB COMMITTEE HEARING PROCEDURE**

All interested parties to the hearing must notify Democratic Services within prescribed timescales that they intend to attend and/or be represented at the hearing and whether any witnesses will be attending on their behalf. The meeting will be in the form of a discussion led by the Sub Committee, cross examination of either party will not be permitted.

The Chair will allocate an equal amount of speaking time to each party. Where there is more than one representation raising the same or similar grounds, those parties should consider nominating a single representative to address the Sub-Committee on their behalf at the hearing.

The hearing will proceed as follows (subject to the discretion of the Chair).

1. Chair will introduce him/herself and ask Members, officers, and all interested parties present at the meeting to introduce themselves.
2. Licensing Officer to present the report.
3. Committee Members to ask questions of officer (if any).
4. The Applicant to present their case in support of their application (including any witnesses they may have).
5. Committee Members to ask questions of applicants and their witnesses or ask for points of clarification.
6. The relevant Responsible Authorities in attendance will present their case and their reasons for representation (including any witnesses they may have).
7. The Objectors/Interested Parties in attendance will present their case and their reasons for objecting (including any witnesses they may have).
8. Committee Members to ask questions of Responsible Authorities, objectors and their witnesses or ask for points of clarification.
9. Applicant (with exception and with permission of the Chair) can ask questions of the other parties to the hearing and their witnesses.
10. Interested Parties to the hearing (with exception and with the permission of the Chair) can ask questions of the applicant/other parties to the hearing and their witnesses.
11. Chair's closing remarks
12. Sub-Committee retire from the meeting with the Committee Officer and Legal Officer and consider their decision.
13. The Sub-Committee will return to the meeting and Chair announces the decision together with the reasons for the decision and any right to appeal.
14. A Decision letter will be sent to all interested parties confirming the decision made.

This page is intentionally left blank

# Agenda Item 3.1

Committee : <b>Licensing Sub Committee</b>	Date: 04/04/18	Classification <b>Unclassified</b>	Report No.	Agenda Item No.
---	-------------------	---------------------------------------	------------	-----------------

Report of : <b>David Tolley</b> <b>Head of Environmental Health &amp; Trading Standards</b>	Title: <b>Licensing Act 2003 Application for a Premises Licence for Di-Stefano Coffee Shop, 28 Hackney Road, London E2 7PA</b>
Originating Officer: <b>Mohshin Ali</b> <b>Senior Licensing Officer</b>	Ward affected: <b>Weavers</b>

## 1.0 Summary

Applicant: **Carmine Di-Stefano & Angelo Di-Stefano**

Name and **Di-Stefano Coffee Shop**

Address of Premises: **28 Hackney Road**  
**London**  
**E2 7PA**

Licence sought: **Licensing Act 2003**  
**• The Sale of Alcohol**

Representation: **Residents / other persons**

## 2.0 Recommendations

2.1 That the Licensing Committee considers the application and objections then adjudicate accordingly.

### LOCAL GOVERNMENT 2000 (Section 97) LIST OF "BACKGROUND PAPERS" USED IN THE DRAFTING OF THIS REPORT

Brief description of "background paper"

Tick if copy supplied for register

If not supplied, name and telephone number of holder

- Guidance Issued under Section 182 of the Licensing Act 2003
- Tower Hamlets Licensing Policy
- File

Mohshin Ali  
020 7364 5498

### 3.0 **Background**

3.1 This is an application for a premises licence for Di-Stefano Coffee Shop, 28 Hackney Road, London E2 7PA

3.2 A copy of the application is enclosed as **Appendix 1**.

3.3 The hours that have been applied for are as follows:-

#### **Sale of Alcohol (on and off sales)**

- Monday to Sunday from 07:00 hours to 20:00 hours

#### **Hours premises is open to the public:**

- Monday to Sunday from 07:00 hours to 20:00 hours

### 4.0 **Location and Nature of the premises**

4.1 Photographs of the venue and immediate vicinity will be provided at the hearing.

4.2 The site plan of the venue is included as **Appendix 2**.

4.3 Maps showing the vicinity are included as **Appendix 3**.

4.4 Details of other licensed venues in the immediate vicinity are included as **Appendix 4**.

### 5.0 **Licensing Policy and Government Advice**

5.1 The Council has adopted a licensing policy and this is available from the Licensing Section, and at the hearing. The revised policy came into effect on 1<sup>st</sup> November 2013.

5.2 Relevant Sections of the policy are brought to the attention of Members within the Licensing Officers report.

5.3 The Home Secretary has issued Guidance under Section 182 of the Licensing Act 2003. This is available on the Government's website, [www.homeoffice.gov.uk](http://www.homeoffice.gov.uk). It was last revised in March 2015.

5.4 Relevant Sections of this advice are brought to Members attention within the Licensing Officers report. Members should note however, that in some areas Tower Hamlets, after a proper consideration of local circumstances, has not followed the Government's advice, or has developed it further.

## 6.0 Representations

- 6.1 All representations have to meet basic legal and administrative requirements. If they fail to do so they cannot be accepted. When rejected the person sending in the representation must be written to, and an explanation for rejection given in writing
- 6.2 A responsible authority or other person can make a representation. There are two tests for other persons and only one for a responsible authority. The two tests are contained in Section 18 of the Act.
- 6.3 All representations must be “about the likely effect of the grant of the premises licence on the promotion of the licensing objectives.” Likely means something that will probably happen, i.e. on balance more likely than not.
- 6.4 Representations by responsible authorities do not have to meet the second test of not being vexatious and frivolous. Other persons have to meet this test.
- 6.5 The Home Office recommends that in borderline cases, the benefit of the doubt should be given to the interested party making the representation.
- 6.6 Section 182 Advice by the Home Office concerning relevant, vexatious and frivolous representations is attached as **Appendix 5**.
- 6.7 All the representations in this report have been considered by the relevant officer (Team Leader Licensing & Safety) and determined to have met the requirements of the Licensing Act 2003.
- 6.8 This hearing is required by the Licensing Act 2003, because relevant representations have been made by the following local residents:

<b>Local residents</b>	<b>Appendix</b>
Anita Barzey	<b>6</b>
Ann Buxton	<b>7</b>
Christiana Amao	<b>8</b>
Caroline Barlow	<b>9</b>
Cuthbert Joseph	<b>10</b>
Christina Pilkington	<b>11</b>
David Leak	<b>12</b>
Dominy Roe	<b>13</b>
Eddie Stride	<b>14</b>
Funmi Afuwape	<b>15</b>
Rev. Georgina Stride	<b>16</b>
Hayley Cotter	<b>17</b>
Juliana David French	<b>18</b>
Jake Kemp	<b>19</b>

Kate Hilton	20
Kennedy Yfeko	21
Lisa Jones	22
Louise Leak	23
Naphtalia Antia	24
Neville Reid	25
Steve Coles	26
Sifa Lobho	27
Suzy Stride	28
Susan Tredinnick	29
Rev'd Valerie Pyper	30

- 6.9 All of the responsible authorities have been consulted about this application. They are as follows:
- The Licensing Authority
  - The Metropolitan Police
  - The LFEPA (the London Fire and Emergency Planning Authority).
  - Planning
  - Health and Safety
  - Noise (Environmental Health)
  - Trading Standards
  - Child Protection
  - Primary Care Trust (Public Health England)
  - Home office Immigration Enforcement
- 6.10 In addition the application was required to be advertised in a local newspaper and by a blue poster. Only objections that relate to the following licensing objectives are relevant:
- the prevention of crime and disorder
  - public safety
  - the prevention of public nuisance
  - the protection of children from harm
- 6.11 The objections cover allegations of
- Anti-social behaviour on the premises
  - Anti social behaviour from patrons leaving the premises
  - Acting as a magnet attracting the young who then engage in anti-social behaviour
  - Close proximity to Community Hub serving the vulnerable
- 6.12 There are strict time limits to any representations. The time limits are contained in The Licensing Act 2003 (Premises licences and club premises certificates) Regulations 2005.
- 6.13 The applicant has offered measures in the operating schedule of the application that address the promotion of the Licensing Objectives. If there were no representations, the Licensing Authority would grant the licence, with conditions consistent with the operating schedule, which are relevant, proportionate and enforceable. Members are asked to consider the



schedule and incorporate any conditions as necessary to address the licensing objectives.

#### **7.0 Conditions consistent with Operating Schedule**

- 7.1 CCTV system to be maintained in good working condition with images recorded digitally at all time the premises is open for licensable activities with recordings to be made available by Authorised staff to the police upon reasonable request for up to 31 day. CCTV cameras shall be installed to cover the entrance and an external CCTV camera covering the premises external frontage.
- 7.2 Staff Training shall be completed and recorded with written training records made available upon reasonable request by a relevant officer of a Responsible Authority.
- 7.3 All alcohol displays to be behind the counter and not self service.
- 7.4 Customers waiting for takeaway orders may not consume alcohol.
- 7.5 Refusals book to be maintained on the premises and operated by all staff. Refusals books shall contain Date and time of refusal, description, reason for refusal, description of persons refused and staff members name.
- 7.6 A Challenge 25 proof of age scheme shall be operated at the premises where the only acceptable forms of identification are recognised photographic identification cards, such as a driving licence, passport or proof of age card with the PASS Hologram.
- 7.7 Notices shall be displayed prominently inside and outside the premises requesting patrons to leave the premises quietly.
- 7.8 Litter to be swept from the premises curtilage before the premises close.

#### **8.0 Conditions Agreed with Environmental Protection**

- 8.1 No sale of alcohol for consumption on the premises shall be made after 19:30 hours thereby allowing a drinking up period of 30 minutes until 20:00 hours. Sales of alcohol for consumption off the premises can still continue up to 20:00 hours.

## 9.0 Licensing Officer Comments

9.1 The Live Music Act removed licensing requirements for the following:

- amplified live music and recorded music between 8am and 11pm before audiences of no more than 500 people on premises authorised to sell alcohol for consumption on the premises;
- unamplified live music between 8am and 11pm in all venues.

Further exemptions apply see Section 16.5-16.6 of Section 182 Guidance.

9.2 The following is intended to advise Members of the relevant aspects of the Boroughs Licensing Policy, guidance from the Secretary of State, legislation and good practice. Members may depart from the Council's Licensing Policy and/or Government advice, provide they consider it appropriate to do so, and have clear reasons for their decision.

9.3 Guidance issued under section 182 of the Licensing Act 2003

- ❖ As stated in the guidance it is “provided to licensing authorities in relation to the carrying out of their functions under the 2003 Act.” It is a key medium for promoting best practice, ensuring consistent application and promoting fairness equal treatment and proportionality (1.7).
- ❖ Also “as long as licensing authorities have properly understood this Guidance, they may depart from it if they have good reason to do so and can provide full reasons. Departure from this Guidance could give rise to an appeal or judicial review, and the reasons given will then be a key consideration for the courts when considering the lawfulness and merits of any decision taken.” Therefore licensing authorities will need to give full reasons for their actions (1.9).
- ❖ Also Members should note “A Licensing Authority may depart from its own policy if the individual circumstances of any case merit such a decision in the interests of the promotion of the licensing objectives.” (1.12)
- ❖ Also, “The licensing authority may not impose any conditions unless its discretion has been exercised following receipt of relevant representations and it is satisfied as a result of a hearing (unless all parties agree a hearing is not necessary) that it is appropriate to impose conditions to promote one or more of the four licensing objectives.” Therefore, conditions may not be imposed for the purpose other than promoting the licensing objectives and in some cases no additional conditions will be appropriate. (10.8)
- ❖ Necessary conditions should emerge from a risk assessment by the applicant, which should then be reflected in the operating schedule (10.4).

- ❖ The Guidance states: “Where there are objections to an application to extend the hours during which licensable activities are to be carried on and the licensing authority determines that this would undermine the licensing objectives, it may reject the application or grant it with appropriate conditions and/or different hours from those requested.” (10.14)
  - ❖ Mandatory conditions must be imposed (10.27) and censorship avoided (10.17).
  - ❖ The Guidance states: “It is still permitted to sell alcohol using promotions (as long as they are compatible with any other licensing condition that may be in force), and the relevant person should ensure that the price of the alcohol is not less than the permitted price. Detailed guidance on the use of promotions is given in the guidance document available on the Gov.uk website.” (10.60) Also, “Licensing authorities should not attach standardised blanket conditions promoting fixed prices for alcoholic drinks to premises licences or club licences or club premises certificates in an area.” (10.21)
- 9.4 The Licensing Act 2003 permits children of any age to be on the premises which primarily sell alcohol providing they are accompanied by an adult. It is not necessary to make this a condition.
- 9.5 In all cases the Members should make their decision on the civil burden of proof, that is “the balance of probability.”
- 9.6 In all cases Members should consider whether or not primary legislation is the appropriate method of regulation and should only consider licence conditions when the circumstances in their view are not already adequately covered elsewhere.
- 9.7 The Government has advised that conditions must be tailored to the individual type, location and characteristics of the premises and events concerned. Conditions cannot seek to manage the behaviour of customers once they are beyond the direct management of the licence holder and their staff and standardised conditions should be avoided where they cannot be shown to be appropriate. (1.16/1.17)
- 9.8 The Council’s Licensing Policy generally expects applicants to address the licensing objectives and discuss how to do this with the relevant responsible authorities.
- 9.9 In **Appendices 31-35** Members are given general advice, and also have explanations of the Council’s Licensing Policy, Government advice and other legislation relating to the matters previously identified.

## 10.0 Legal Comments

10.1 The Council's legal officer will give advice at the hearing.

## 11.0 Finance Comments

11.1 There are no financial implications in this report.

## 12.0 Appendices

<b>Appendix 1</b>	A copy of the application
<b>Appendix 2</b>	Site Plan
<b>Appendix 3</b>	Maps of the surrounding area
<b>Appendix 4</b>	Other licensed venues in the area
<b>Appendix 5</b>	Section 182 Advice by the DCMS- Relevant, vexatious and frivolous representations
<b>Appendix 6-30</b>	Representations of local residents
<b>Appendix 31</b>	Licensing Officer comments on Anti-Social Behaviour on the premises
<b>Appendix 32</b>	Licensing officer comments on anti-social behaviour patrons leaving the premises
<b>Appendix 33</b>	Licensing officer comments on Acting as a magnet Attracting the Young
<b>Appendix 34</b>	Planning
<b>Appendix 35</b>	Licensing Policy relating to hours of trading

# Appendix 1

**LICENSING TEAM, LONDON BOROUGH OF TOWER HAMLETS, ONSLOW  
HOUSE, 1 EWART PLACE, LONDON, E3 5EQ.**

**Application for a premises licence to be granted  
under the Licensing Act 2003**

**PLEASE READ THE FOLLOWING INSTRUCTIONS FIRST**

Before completing this form please read the guidance notes at the end of the form. If you are completing this form by hand please write legibly in block capitals. In all cases ensure that your answers are inside the boxes and written in black ink. Use additional sheets if necessary.

You may wish to keep a copy of the completed form for your records.

I/We CARMINE DI-STEFANO & ANGELO DI-STEFANO  
*(Insert name(s) of applicant)*

**apply for a premises licence under section 17 of the Licensing Act 2003 for the premises described in Part 1 below (the premises) and I/we are making this application to you as the relevant licensing authority in accordance with section 12 of the Licensing Act 2003**

**Part 1 – Premises Details**

Postal address of premises or, if none, ordnance survey map reference or description			
DI-STEFANO COFFEE SHOP 28 HACKNEY ROAD			
<b>Post town</b>	LONDON	<b>Postcode</b>	E2 7PA

Telephone number at premises (if any)	
Non-domestic rateable value of premises	£ AGREED BAND 'A'

**Part 2 - Applicant Details**

Please state whether you are applying for a premises licence as

Please tick as appropriate

- a) an individual or individuals \*  please complete section (A)
- b) a person other than an individual \*
  - i. as a limited company  please complete section (B)
  - ii. as a partnership  please complete section (B)
  - iii. as an unincorporated association or  please complete section (B)

**LICENSING TEAM, LONDON BOROUGH OF TOWER  
HAMLETS, ONSLOW HOUSE, 1 EWART PLACE,  
LONDON, E3 5EQ**

- iv other (for example a statutory corporation)  please complete section (B)
- c) a recognised club  please complete section (B)
- d) a charity  please complete section (B)
- e) the proprietor of an educational establishment  please complete section (B)
- f) a health service body  please complete section (B)
- g) a person who is registered under Part 2 of the Care Standards Act 2000 (c14) in respect of an independent hospital in Wales  please complete section (B)
- ga) a person who is registered under Chapter 2 of Part 1 of the Health and Social Care Act 2008 (within the meaning of that Part) in an independent hospital in England  please complete section (B)
- h) the chief officer of police of a police force in England and Wales  please complete section (B)

\* If you are applying as a person described in (a) or (b) please confirm (by ticking yes to one box below):

- I am carrying on or proposing to carry on a business which involves the use of the premises for licensable activities; or
- I am making the application pursuant to a
  - statutory function or
  - a function discharged by virtue of Her Majesty's prerogative

**(A) INDIVIDUAL APPLICANTS (fill in as applicable)**

Mr <input checked="" type="checkbox"/>	Mrs <input type="checkbox"/>	Miss <input type="checkbox"/>	Ms <input type="checkbox"/>	Other Title (for example, Rev)	
<b>Surname</b> DI-STEFANO			<b>First names</b> CARMINE		
<b>Date of birth:</b> [REDACTED]		I am 18 years old or over <input checked="" type="checkbox"/> Please tick yes			
<b>Nationality:</b> ITALIAN					
<b>Current residential address if different from premises address</b>		[REDACTED]			
<b>Post town</b>	LONDON			<b>Postcode</b>	[REDACTED]
<b>Daytime contact telephone number</b>		[REDACTED]			
<b>E-mail address (optional)</b>					

**LICENSING TEAM, LONDON BOROUGH OF TOWER  
HAMLETS, ONSLOW HOUSE, 1 EWART PLACE,  
LONDON, E3 5EQ**

**SECOND INDIVIDUAL APPLICANT (if applicable)**

<input checked="" type="checkbox"/> Mr	<input type="checkbox"/> Mrs	<input type="checkbox"/> Miss	<input type="checkbox"/> Ms	Other Title (for example, Rev)	
Surname DI-STEFANO			First names ANGELO		
Date of birth		I am 18 years old or over		<input type="checkbox"/> Please tick yes	
Nationality: ITALIAN					
Current postal address if different from premises address					
Post town	LONDON		Postcode	E2 9NB	
Daytime contact telephone number					
E-mail address (optional)					

**(B) OTHER APPLICANTS**

**Please provide name and registered address of applicant in full. Where appropriate please give any registered number. In the case of a partnership or other joint venture (other than a body corporate), please give the name and address of each party concerned.**

Name
Address
Registered number (where applicable)
Description of applicant (for example, partnership, company, unincorporated association etc.)
Telephone number (if any)
E-mail address (optional)



**Part 3 Operating Schedule**

When do you want the premises licence to start?

DD	MM	YYYY
09	03	2018

If you wish the licence to be valid only for a limited period, when do you want it to end?

DD	MM	YYYY
11	11	1111

Please give a general description of the premises (please read guidance note 1)

THIS IS PART OF A NEW DEVELOPMENT ON THE HACKNEY ROAD. THE PREMISES ARE LOCATED NEXT TO AN ACCESS ROAD FOR VEHICLES AND PEDESTRIANS TO THE MAINLY RESIDENTIAL NATURE OF THE IMMEDIATE AREA BEHIND THE PREMISES. THERE ARE ALSO BUSINESSES ON BOTH SIDES OF THE MAIN ROAD. THE PREMISES INTEND TO TRADE AS A CAFÉ/COFFEE SHOP OFFERING VARIOUS SPECIALIST CONTINENTAL & ITALIAN DELICATESSEN FOODS AND BEVERAGES FOR BOTH SIT DOWN AND TAKEAWAY CUSTOMERS.

If 5,000 or more people are expected to attend the premises at any one time, please state the number expected to attend.

What licensable activities do you intend to carry on from the premises?

(Please see sections 1 and 14 of the Licensing Act 2003 and Schedules 1 and 2 to the Licensing Act 2003)

Provision of regulated entertainment

Please tick any that apply

- a) plays (if ticking yes, fill in box A)
- b) films (if ticking yes, fill in box B)
- c) indoor sporting events (if ticking yes, fill in box C)
- d) boxing or wrestling entertainment (if ticking yes, fill in box D)
- e) live music (if ticking yes, fill in box E)
- f) recorded music (if ticking yes, fill in box F)
- g) performances of dance (if ticking yes, fill in box G)
- h) anything of a similar description to that falling within (e), (f) or (g) (if ticking yes, fill in box H)

**Provision of late night refreshment** (if ticking yes, fill in box I)

**Supply of alcohol** (if ticking yes, fill in box J)

**In all cases complete boxes K, L and M**

**A**

Plays Standard days and timings (please read guidance note 6)			<b>Will the performance of a play take place indoors or outdoors or both – please tick</b> (please read guidance note 2)	Indoors	<input type="checkbox"/>
				Outdoors	<input type="checkbox"/>
				Both	<input type="checkbox"/>
Day	Start	Finish			
Mon			<b>Please give further details here</b> (please read guidance note 3)		
Tue					
Wed			<b>State any seasonal variations for performing plays</b> (please read guidance note 4)		
Thur					
Fri			<b>Non standard timings. Where you intend to use the premises for the performance of plays at different times to those listed in the column on the left, please list</b> (please read guidance note 5)		
Sat					
Sun					

**B**

<b>Films</b> Standard days and timings (please read guidance note 6)			<b>Will the exhibition of films take place indoors or outdoors or both – please tick</b> (please read guidance note 2)	Indoors	<input type="checkbox"/>
				Outdoors	<input type="checkbox"/>
				Both	<input type="checkbox"/>
Day	Start	Finish	<b>Please give further details here</b> (please read guidance note 3)		
Mon					
Tue					
Wed			<b>State any seasonal variations for the exhibition of films</b> (please read guidance note 4)		
Thur			<b>Non standard timings. Where you intend to use the premises for the exhibition of films at different times to those listed in the column on the left, please list</b> (please read guidance note 5)		
Fri					
Sat					
Sun					



**D**

<b>Boxing or wrestling entertainments</b> Standard days and timings (please read guidance note 6)			<b><u>Will the boxing or wrestling entertainment take place indoors or outdoors or both – please tick</u></b> (please read guidance note 2)	Indoors	<input type="checkbox"/>
				Outdoors	<input type="checkbox"/>
				Both	<input type="checkbox"/>
Day	Start	Finish	<b><u>Please give further details here</u></b> (please read guidance note 3)		
Mon					
Tue					
Wed			<b><u>State any seasonal variations for boxing or wrestling entertainment</u></b> (please read guidance note 4)		
Thur					
Fri			<b><u>Non standard timings. Where you intend to use the premises for boxing or wrestling entertainment at different times to those listed in the column on the left, please list</u></b> (please read guidance note 5)		
Sat					
Sun					

**E**

<b>Live music</b> Standard days and timings (please read guidance note 6)			<b>Will the performance of live music take place indoors or outdoors or both – please tick</b> (please read guidance note 2)	Indoors	<input type="checkbox"/>
				Outdoors	<input type="checkbox"/>
				Both	<input type="checkbox"/>
Day	Start	Finish			
Mon			<b>Please give further details here</b> (please read guidance note 3)		
Tue			<b>State any seasonal variations for the performance of live music</b> (please read guidance note 4)		
Wed			<b>Non standard timings. Where you intend to use the premises for the performance of live music at different times to those listed in the column on the left, please list</b> (please read guidance note 5)		
Thur					
Fri					
Sat					
Sun					

**F**

<b>Recorded music</b> Standard days and timings (please read guidance note 6)			<b>Will the playing of recorded music take place indoors or outdoors or both – please tick</b> (please read guidance note 2)	Indoors	<input type="checkbox"/>
				Outdoors	<input type="checkbox"/>
				Both	<input type="checkbox"/>
<b>Day</b>	<b>Start</b>	<b>Finish</b>	<b>Please give further details here</b> (please read guidance note 3)		
Mon					
Tue			<b>State any seasonal variations for the playing of recorded music</b> (please read guidance note 4)		
Wed					
Thur			<b>Non standard timings. Where you intend to use the premises for the playing of recorded music at different times to those listed in the column on the left, please list</b> (please read guidance note 5)		
Fri					
Sat					
Sun					

# G

<b>Performances of dance</b> Standard days and timings (please read guidance note 6)			<b><u>Will the performance of dance take place indoors or outdoors or both – please tick</u></b> (please read guidance note 2)	Indoors	<input type="checkbox"/>
				Outdoors	<input type="checkbox"/>
				Both	<input type="checkbox"/>
<b>Day</b>	<b>Start</b>	<b>Finish</b>			
Mon			<b><u>Please give further details here</u></b> (please read guidance note 3)		
Tue					
Wed			<b><u>State any seasonal variations for the performance of dance</u></b> (please read guidance note 4)		
Thur					
Fri			<b><u>Non standard timings. Where you intend to use the premises for the performance of dance at different times to those listed in the column on the left, please list</u></b> (please read guidance note 5)		
Sat					
Sun					



# H

<b>Anything of a similar description to that falling within (e), (f) or (g)</b> Standard days and timings (please read guidance note 6)			Please give a description of the type of entertainment you will be providing		
Day	Start	Finish	<b>Will this entertainment take place indoors or outdoors or both – please tick</b> (please read guidance note 2)	Indoors	<input type="checkbox"/>
Mon				Outdoors	<input type="checkbox"/>
				Both	<input type="checkbox"/>
Tue			<b>Please give further details here</b> (please read guidance note 3)		
Wed					
Thur			<b>State any seasonal variations for entertainment of a similar description to that falling within (e), (f) or (g)</b> (please read guidance note 4)		
Fri					
Sat			<b>Non standard timings. Where you intend to use the premises for the entertainment of a similar description to that falling within (e), (f) or (g) at different times to those listed in the column on the left, please list</b> (please read guidance note 5)		
Sun					

**I**



<b>Late night refreshment</b> Standard days and timings (please read guidance note 6)			<b>Will the provision of late night refreshment take place indoors or outdoors or both – please tick</b> (please read guidance note 2)	Indoors	<input type="checkbox"/>
				Outdoors	<input type="checkbox"/>
				Both	<input type="checkbox"/>
<b>Day</b>	<b>Start</b>	<b>Finish</b>	<b><u>Please give further details here</u></b> (please read guidance note 3)		
Mon					
Tue					
			<b><u>State any seasonal variations for the provision of late night refreshment</u></b> (please read guidance note 4)		
Wed					
Thur					
			<b><u>Non standard timings. Where you intend to use the premises for the provision of late night refreshment at different times, to those listed in the column on the left, please list</u></b> (please read guidance note 5)		
Fri					
Sat					
Sun					

**LICENSING TEAM, LONDON BOROUGH OF TOWER  
HAMLETS, ONSLOW HOUSE, 1 EWART PLACE,  
LONDON, E3 5EQ**

**J**

<b>Supply of alcohol</b> Standard days and timings (please read guidance note 7)			<b>Will the supply of alcohol be for consumption – please tick</b> (please read guidance note 8)	On the premises	<input checked="" type="checkbox"/>
				Off the premises	<input checked="" type="checkbox"/>
				Both	<input type="checkbox"/>
<b>Day</b>	<b>Start</b>	<b>Finish</b>	<b>State any seasonal variations for the supply of alcohol</b> (please read guidance note 5)		
Mon	07.00	20.00			
Tue	07.00	20.00			
Wed	07.00	20.00			
Thur	07.00	20.00			
Fri	07.00	20.00			
Sat	07.00	20.00			
Sun	07.00	20.00			

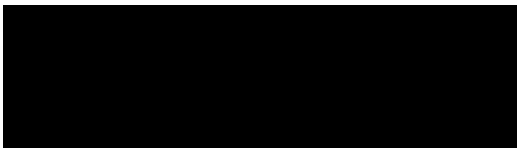
**State the name and details of the individual whom you wish to specify on the licence as designated premises supervisor (Please see declaration about the entitlement to work in the checklist at the end of the form):**

<b>Name</b> CARMINE DI-STEFANO	
<b>Date of birth</b> : 	
<b>Address</b> 	
<b>Postcode</b>	
<b>Personal licence number (if known)</b> 26092	
<b>Issuing licensing authority (if known)</b> LONDON BOROUGH OF TOWER HAMLETS	

K

**Please highlight any adult entertainment or services, activities, other entertainment or matters ancillary to the use of the premises that may give rise to concern in respect of children (please read guidance note 8).**

NONE

L

<b>Hours premises are open to the public</b> Standard days and timings (please read guidance note 6)			<b>State any seasonal variations</b> (please read guidance note 4)
Day	Start	Finish	
Mon	07.00	20.00	<b>Non standard timings. Where you intend the premises to be open to the public at different times from those listed in the column on the left, please list</b> (please read guidance note 5)
Tue	07.00	20.00	
Wed	07.00	20.00	
Thur	07.00	20.00	
Fri	07.00	20.00	
Sat	07.00	20.00	
Sun	07.00	20.00	

**LICENSING TEAM, LONDON BOROUGH OF TOWER  
HAMLETS, ONSLOW HOUSE, 1 EWART PLACE,  
LONDON, E3 5EQ**

**M** Describe the steps you intend to take to promote the four licensing objectives:

**a) General – all four licensing objectives (b, c, d and e) (please read guidance note 10)**

1. CCTV SYSTEM TO HOME OFFICE GUIDANCE STANDARDS AND MAINTAINED IN GOOD WORKING CONDITION, WITH IMAGES RECORDED DIGITALLY AT ALL TIMES THE PREMISES IS OPEN FOR LICENSABLE ACTIVITIES WITH RECORDINGS TO BE MADE AVAILABLE BY AUTHORISED STAFF TO THE POLICE UPON REASONABLE REQUEST FOR UP TO 31 DAYS, A CCTV CAMERA SHALL BE INSTALLED TO COVER THE ENTRANCE OF THE PREMISES. THERE WILL ALSO BE AN EXTERNAL CCTV CAMERA COVERING THE PREMISES EXTERNAL FRONTAGE.
2. APPROPRIATE TRAINING MANUAL UTILISED. APPROPRIATE STAFF ALCOHOL SALES TRAINING TO BE SATISFACTORILY COMPLETED AND RECORDED. WRITTEN TRAINING RECORDS CAN BE MADE AVAILABLE FOR INSPECTION UPON REASONABLE REQUEST BY A RELEVANT OFFICER OF A RESPONSIBLE AUTHORITY.
3. ALL ALCOHOL DISPLAYS TO BE BEHIND THE BAR COUNTER AND WILL NOT BE SELF SERVICE. CUSTOMERS WAITING FOR TAKEAWAY ORDERS MAY NOT CONSUME ALCOHOL.
4. REFUSALS BOOK TO BE MAINTAINED WITHIN THE PREMISES AND OPERATED BY ALL STAFF, THE FOLLOWING DETAILS TO BE NOTED IN THE REFUSAL BOOK, DATE AND TIME OF REFUSAL, THE PRODUCT DESCRIPTION, THE REASON FOR REFUSAL, THE DESCRIPTION OF THE PERSON REFUSED AND THE STAFF MEMBERS NAME.
5. CHALLENGE 25 AGE VERIFICATION POLICY TO BE ADOPTED, THE ONLY FORMS OF ID ACCEPTABLE WILL BE A PASSPORT, A PHOTO DRIVING LICENCE OR A PASS ACCREDITED PROOF OF AGE CARD SCHEME , TO BE OPERATED BY ALL STAFF.
6. APPROPRIATELY WORDED NOTICES TO BE DISPLAYED PROMINENTLY INSIDE AND OUTSIDE THE PREMISES REQUESTING PATRONS TO LEAVE THE PREMISES QUIETLY AT NIGHT.
7. LITTER WILL BE SWEEPED FROM THE PREMISES CURTILAGE BEFORE THE PREMISES CLOSE.

**b) The prevention of crime and disorder**

1. CCTV SYSTEM TO HOME OFFICE GUIDANCE STANDARDS AND MAINTAINED IN GOOD WORKING CONDITION, WITH IMAGES RECORDED DIGITALLY AT ALL TIMES THE PREMISES IS OPEN FOR LICENSABLE ACTIVITIES WITH RECORDINGS TO BE MADE AVAILABLE BY AUTHORISED STAFF TO THE POLICE UPON REASONABLE REQUEST FOR UP TO 31 DAYS, A CCTV CAMERA SHALL BE INSTALLED TO COVER THE ENTRANCE OF THE PREMISES. THERE WILL ALSO BE AN EXTERNAL CCTV CAMERA COVERING THE PREMISES EXTERNAL FRONTAGE.
2. ALL ALCOHOL DISPLAYS TO BE BEHIND THE BAR COUNTER AND WILL NOT BE SELF SERVICE. CUSTOMERS WAITING FOR TAKEAWAY ORDERS MAY NOT CONSUME ALCOHOL.

**LICENSING TEAM, LONDON BOROUGH OF TOWER  
HAMLETS, ONSLOW HOUSE, 1 EWART PLACE,  
LONDON, E3 5EQ**

3. CCTV SYSTEM TO HOME OFFICE GUIDANCE STANDARDS AND MAINTAINED IN GOOD WORKING CONDITION, WITH IMAGES RECORDED DIGITALLY AT ALL TIMES THE PREMISES IS OPEN FOR LICENSABLE ACTIVITIES WITH RECORDINGS TO BE MADE AVAILABLE BY AUTHORISED STAFF TO THE POLICE UPON REASONABLE REQUEST FOR UP TO 31 DAYS, A CCTV CAMERA SHALL BE INSTALLED TO COVER THE ENTRANCE OF THE PREMISES. THERE WILL ALSO BE AN EXTERNAL CCTV CAMERA COVERING THE PREMISES EXTERNAL FRONTAGE.
4. REFUSALS BOOK TO BE MAINTAINED WITHIN THE PREMISES AND OPERATED BY ALL STAFF, THE FOLLOWING DETAILS TO BE NOTED IN THE REFUSAL BOOK, DATE AND TIME OF REFUSAL, THE PRODUCT DESCRIPTION, THE REASON FOR REFUSAL, THE DESCRIPTION OF THE PERSON REFUSED AND THE STAFF MEMBERS NAME.
5. CHALLENGE 25 AGE VERIFICATION POLICY TO BE ADOPTED, THE ONLY FORMS OF ID ACCEPTABLE WILL BE A PASSPORT, A PHOTO DRIVING LICENCE OR A PASS ACCREDITED PROOF OF AGE CARD SCHEME , TO BE OPERATED BY ALL STAFF.

**c) Public safety**

1. CCTV SYSTEM TO HOME OFFICE GUIDANCE STANDARDS AND MAINTAINED IN GOOD WORKING CONDITION, WITH IMAGES RECORDED DIGITALLY AT ALL TIMES THE PREMISES IS OPEN FOR LICENSABLE ACTIVITIES WITH RECORDINGS TO BE MADE AVAILABLE BY AUTHORISED STAFF TO THE POLICE UPON REASONABLE REQUEST FOR UP TO 31 DAYS, A CCTV CAMERA SHALL BE INSTALLED TO COVER THE ENTRANCE OF THE PREMISES. THERE WILL ALSO BE AN EXTERNAL CCTV CAMERA COVERING THE PREMISES EXTERNAL FRONTAGE.
2. REFUSALS BOOK TO BE MAINTAINED WITHIN THE PREMISES AND OPERATED BY ALL STAFF, THE FOLLOWING DETAILS TO BE NOTED IN THE REFUSAL BOOK, DATE AND TIME OF REFUSAL, THE PRODUCT DESCRIPTION, THE REASON FOR REFUSAL, THE DESCRIPTION OF THE PERSON REFUSED AND THE STAFF MEMBERS NAME.
3. CHALLENGE 25 AGE VERIFICATION POLICY TO BE ADOPTED, THE ONLY FORMS OF ID ACCEPTABLE WILL BE A PASSPORT, A PHOTO DRIVING LICENCE OR A PASS ACCREDITED PROOF OF AGE CARD SCHEME , TO BE OPERATED BY ALL STAFF.

**LICENSING TEAM, LONDON BOROUGH OF TOWER  
HAMLETS, ONSLOW HOUSE, 1 EWART PLACE,  
LONDON, E3 5EQ**

**d) The prevention of public nuisance**

1. CCTV SYSTEM TO HOME OFFICE GUIDANCE STANDARDS AND MAINTAINED IN GOOD WORKING CONDITION, WITH IMAGES RECORDED DIGITALLY AT ALL TIMES THE PREMISES IS OPEN FOR LICENSABLE ACTIVITIES WITH RECORDINGS TO BE MADE AVAILABLE BY AUTHORISED STAFF TO THE POLICE UPON REASONABLE REQUEST FOR UP TO 31 DAYS, A CCTV CAMERA SHALL BE INSTALLED TO COVER THE ENTRANCE OF THE PREMISES. THERE WILL ALSO BE AN EXTERNAL CCTV CAMERA COVERING THE PREMISES EXTERNAL FRONTAGE.
2. CHALLENGE 25 AGE VERIFICATION POLICY TO BE ADOPTED, THE ONLY FORMS OF ID ACCEPTABLE WILL BE A PASSPORT, A PHOTO DRIVING LICENCE OR A PASS ACCREDITED PROOF OF AGE CARD SCHEME , TO BE OPERATED BY ALL STAFF.
3. APPROPRIATELY WORDED NOTICES TO BE DISPLAYED PROMINENTLY INSIDE AND OUTSIDE THE PREMISES REQUESTING PATRONS TO LEAVE THE PREMISES QUIETLY AT NIGHT.
4. LITTER WILL BE SWEEPED FROM THE PREMISES CURTILAGE BEFORE THE PREMISES CLOSE.

**e) The protection of children from harm**

1. APPROPRIATE TRAINING MANUAL UTILISED. APPROPRIATE STAFF ALCOHOL SALES TRAINING TO BE SATISFACTORILY COMPLETED AND RECORDED. WRITTEN TRAINING RECORDS CAN BE MADE AVAILABLE FOR INSPECTION UPON REASONABLE REQUEST BY A RELEVANT OFFICER OF A RESPONSIBLE AUTHORITY.
2. REFUSALS BOOK TO BE MAINTAINED WITHIN THE PREMISES AND OPERATED BY ALL STAFF, THE FOLLOWING DETAILS TO BE NOTED IN THE REFUSAL BOOK, DATE AND TIME OF REFUSAL, THE PRODUCT DESCRIPTION, THE REASON FOR REFUSAL, THE DESCRIPTION OF THE PERSON REFUSED AND THE STAFF MEMBERS NAME.
3. CHALLENGE 25 AGE VERIFICATION POLICY TO BE ADOPTED, THE ONLY FORMS OF ID ACCEPTABLE WILL BE A PASSPORT, A PHOTO DRIVING LICENCE OR A PASS ACCREDITED PROOF OF AGE CARD SCHEME , TO BE OPERATED BY ALL STAFF.

**Checklist:**

**Please tick to indicate agreement**

- I have made or enclosed payment of the fee.
- I have enclosed the plan of the premises.
- I have sent copies of this application and the plan to responsible authorities and others where applicable.
- I have enclosed the consent form completed by the individual I wish to be designated premises supervisor, if applicable.

**LICENSING TEAM, LONDON BOROUGH OF TOWER  
HAMLETS, ONSLOW HOUSE, 1 EWART PLACE,  
LONDON, E3 5EQ**

- I understand that I must now advertise my application.
- I understand that if I do not comply with the above requirements my application will be rejected.
- [Applicable to all individual applicants, including those in a partnership which is not a limited liability partnership, but not companies or limited liability partnerships] I have included documents demonstrating my entitlement to work in the United Kingdom (please read note 15).

**IT IS AN OFFENCE, UNDER SECTION 158 OF THE LICENSING ACT 2003, TO MAKE A FALSE STATEMENT IN OR IN CONNECTION WITH THIS APPLICATION. THOSE WHO MAKE A FALSE STATEMENT MAY BE LIABLE ON SUMMARY CONVICTION TO A FINE OF ANY AMOUNT.**

**IT IS AN OFFENCE UNDER SECTION 24B OF THE IMMIGRATION ACT 1971 FOR A PERSON TO WORK WHEN THEY KNOW, OR HAVE REASONABLE CAUSE TO BELIEVE, THAT THEY ARE DISQUALIFIED FROM DOING SO BY REASON OF THEIR IMMIGRATION STATUS. THOSE WHO EMPLOY AN ADULT WITHOUT LEAVE OR WHO IS SUBJECT TO CONDITIONS AS TO EMPLOYMENT WILL BE LIABLE TO A CIVIL PENALTY UNDER SECTION 15 OF THE IMMIGRATION, ASYLUM AND NATIONALITY ACT 2006 AND PURSUANT TO SECTION 21 OF THE SAME ACT, WILL BE COMMITTING AN OFFENCE WHERE THEY DO SO IN THE KNOWLEDGE, OR WITH REASONABLE CAUSE TO BELIEVE, THAT THE EMPLOYEE IS DISQUALIFIED.**

**Part 4 – Signatures** (please read guidance note 11)

**Signature of applicant or applicant’s solicitor or other duly authorised agent** (see guidance note 12). **If signing on behalf of the applicant, please state in what capacity.**

<b>Declaration</b>	<ul style="list-style-type: none"> <li>• [Applicable to individual applicants only, including those in a partnership which is not a limited liability partnership] I understand I am not entitled to be issued with a licence if I do not have the entitlement to live and work in the UK (or if I am subject to a condition preventing me from doing work relating to the carrying on of a licensable activity) and that my licence will become invalid if I cease to be entitled to live and work in the UK (please read guidance note 15).</li> <li>• The DPS named in this application form is entitled to work in the UK (and is not subject to conditions preventing him or her from doing work relating to a licensable activity) and I have seen a copy of his or her proof of entitlement to work, if appropriate (please see note 15)</li> </ul>
<b>Signature</b>	
<b>Date</b>	7 <sup>TH</sup> FEBRUARY 2018
<b>Capacity</b>	AGENT



**LICENSING TEAM, LONDON BOROUGH OF TOWER  
HAMLETS, ONSLOW HOUSE, 1 EWART PLACE,  
LONDON, E3 5EQ**

For joint applications, signature of 2<sup>nd</sup> applicant or 2<sup>nd</sup> applicant's solicitor or other authorised agent (please read guidance note 13). If signing on behalf of the applicant, please state in what capacity.

Signature	
Date	
Capacity	

Contact name (where not previously given) and postal address for correspondence associated with this application (please read guidance note 14)			
RICHARD BAKER RB RETAIL & LICENSING SERVICES 23 MAGISTER DRIVE LEE ON THE SOLENT			
Post town	PORTSMOUTH	Postcode	PO13 8GE
Telephone number (if any)	[REDACTED]		
If you would prefer us to correspond with you by e-mail, your e-mail address (optional)			
[REDACTED]			

**Notes for Guidance**

1. Describe the premises, for example the type of premises, its general situation and layout and any other information which could be relevant to the licensing objectives. Where your application includes off-supplies of alcohol and you intend to provide a place for consumption of these off-supplies, you must include a description of where the place will be and its proximity to the premises.
2. In terms of specific regulated entertainments please note that:
  - Plays: no licence is required for performances between 08:00 and 23.00 on any day, provided that the audience does not exceed 500.
  - Films: no licence is required for 'not-for-profit' film exhibition held in community premises between 08.00 and 23.00 on any day provided that the audience does not exceed 500 and the organiser (a) gets consent to the screening from a person who is responsible for the premises; and (b) ensures that each such screening abides by age classification ratings.
  - Indoor sporting events: no licence is required for performances between 08.00 and 23.00 on any day, provided that the audience does not exceed 1000.
  - Boxing or Wrestling Entertainment: no licence is required for a contest, exhibition or display of Greco-Roman wrestling, or freestyle wrestling between 08.00 and 23.00 on any day, provided that the audience does not exceed 1000. Combined fighting sports – defined as a contest, exhibition or display which combines boxing or wrestling with one or more martial arts – are licensable as a boxing or wrestling entertainment rather than an indoor sporting event.
  - Live music: no licence permission is required for:
    - a performance of unamplified live music between 08.00 and 23.00 on any day, on any premises.
    - a performance of amplified live music between 08.00 and 23.00 on any day on premises authorised to sell alcohol for consumption on those premises, provided that the audience does not exceed 500.

# Appendix 2

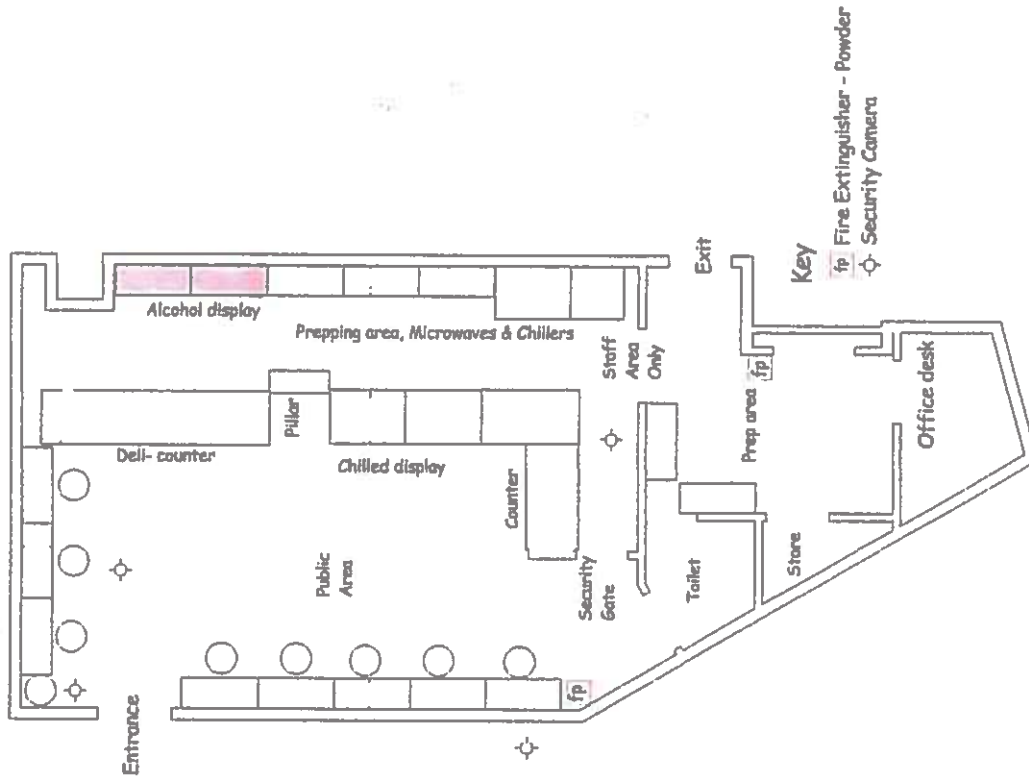

Di-Stefano Coffee Shop  
28 Hackney Road  
Tower Hamlets  
London  
E2 7PA  
Scale- 1:100  
Drawing Reference; RB/0866  
Drawn by: R Baker RB Retail & Licensing  
7<sup>th</sup> February 2018

All retail selling areas to be licensed for alcohol display. Copyright – RB Retail & Licensing Services Limited,  
23 Magister Drive, Lee on the Solent, Portsmouth PO123 8GE, Site dimensions to be used at all times

# Appendix 3



## 28 Hackney Road



Scale 1:769

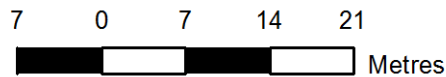

Produced by London Borough of Tower Hamlets on 19/03/2018. © Crown copyright and database rights 2012 Ordnance Survey, London Borough of Tower Hamlets 100019288.

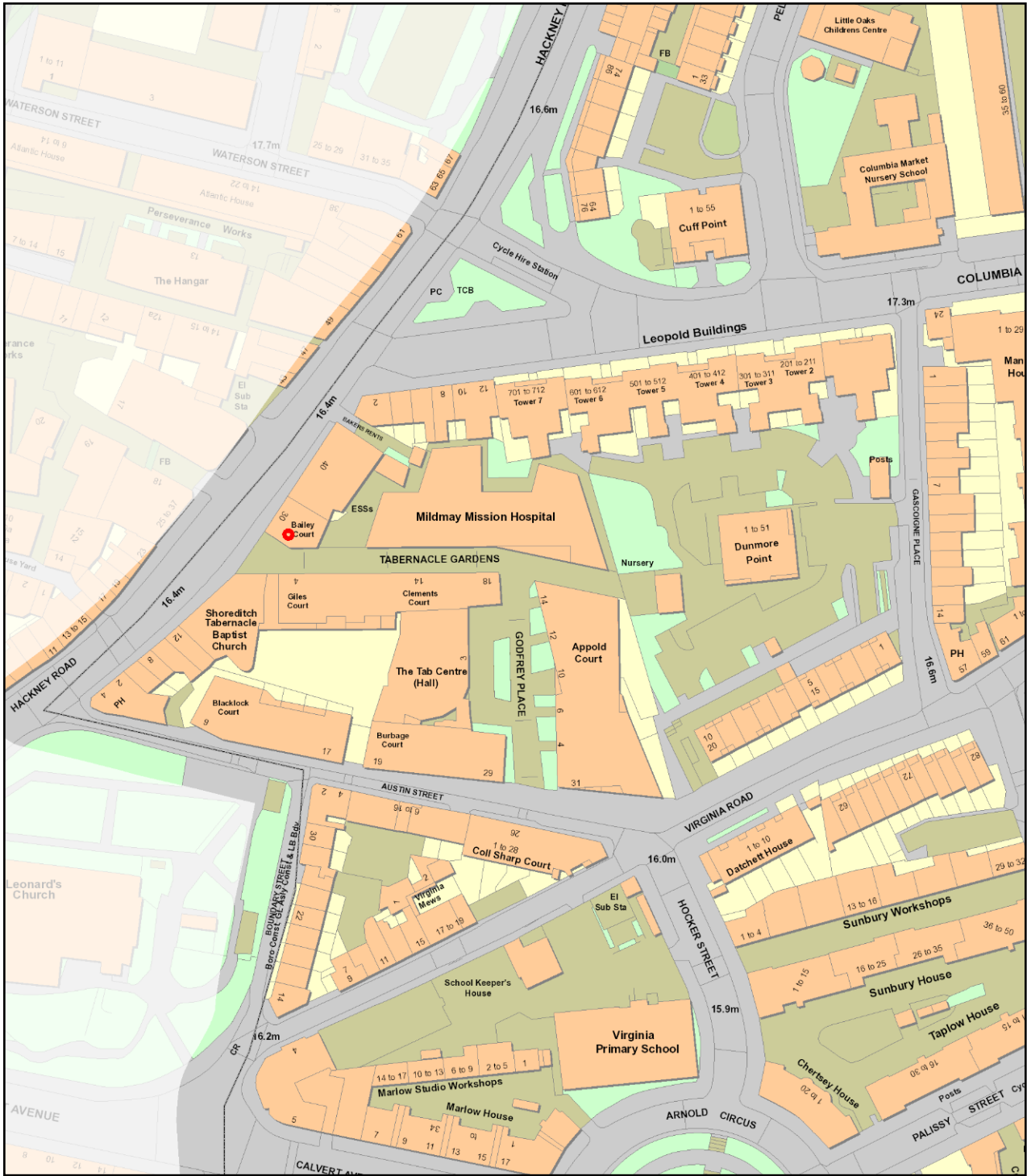

# 28 Hackney Road



Scale 1:1537

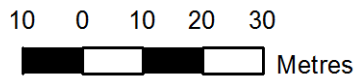

Produced by London Borough of Tower Hamlets on 19/03/2018. © Crown copyright and database rights 2012 Ordnance Survey, London Borough of Tower Hamlets 100019288.

# Appendix 4

<b>Premises name and address</b>	<b>Licensable Activities and Hours</b>	<b>Opening Hours</b>
(The George And Dragon Public House) 2 Hackney Road	<p><b>The sale by retail of alcohol:</b> Monday to Saturday from 11:00 hours to midnight Sunday from 12:00 hours to midnight</p> <p><b>Films:</b> Saturday from 11:00 to midnight</p> <p><b>Recorded Music:</b> Monday to Saturday from 11:00 hours to midnight Sunday from 12:00 hours to midnight New Years Eve from end of permitted hours to start of permitted hours New Years Day</p>	<p>Monday to Saturday from 11:00 hours to 00:30 hours the following day Sunday from 12:00 hours to 00:30 hours the following day</p>
(The Convenience Store) 12 Hackney Road	Monday to Sunday for 24 hours	Monday to Sunday for 24 hours



# Appendix 5

**Section 182 Advice by the Home Office  
Updated on April 2017**

Relevant, vexatious and frivolous representations

- 9.4 A representation is “relevant” if it relates to the likely effect of the grant of the licence on the promotion of at least one of the licensing objectives. For example, a representation from a local businessperson about the commercial damage caused by competition from new licensed premises would not be relevant. On the other hand, a representation by a businessperson that nuisance caused by new premises would deter customers from entering the local area, and the steps proposed by the applicant to prevent that nuisance were inadequate, would be relevant. In other words, representations should relate to the impact of licensable activities carried on from premises on the objectives. For representations in relation to variations to be relevant, they should be confined to the subject matter of the variation. There is no requirement for a responsible authority or other person to produce a recorded history of problems at premises to support their representations, and in fact this would not be possible for new premises.
- 9.5 It is for the licensing authority to determine whether a representation (other than a representation from responsible authority) is frivolous or vexatious on the basis of what might ordinarily be considered to be vexatious or frivolous. A representation may be considered to be vexatious if it appears to be intended to cause aggravation or annoyance, whether to a competitor or other person, without reasonable cause or justification. Vexatious circumstances may arise because of disputes between rival businesses and local knowledge will therefore be invaluable in considering such matters. Licensing authorities can consider the main effect of the representation, and whether any inconvenience or expense caused by it could reasonably be considered to be proportionate.
- 9.6 Frivolous representations would be essentially categorised by a lack of seriousness. Frivolous representations would concern issues which, at most, are minor and in relation to which no remedial steps would be warranted or proportionate.
- 9.7 Any person who is aggrieved by a rejection of their representations on either of these grounds may lodge a complaint through the local authority’s corporate complaints procedure. A person may also challenge the authority’s decision by way of judicial review.

- 9.8 Licensing authorities should not take decisions about whether representations are frivolous, vexatious or relevant to the licensing objectives on the basis of any political judgement. This may be difficult for councillors who receive complaints from residents within their own wards. If consideration is not to be delegated, contrary to the recommendation in this Guidance, an assessment should be prepared by officials for consideration by the sub- committee before any decision is taken that necessitates a hearing. Any councillor who considers that their own interests are such that they are unable to consider the matter independently should disqualify themselves.
- 9.9 It is recommended that, in borderline cases, the benefit of the doubt about any aspect of a representation should be given to the person making that representation. The subsequent hearing would then provide an opportunity for the person or body making the representation to amplify and clarify it.
- 9.10 Licensing authorities should consider providing advice on their websites about how any person can make representations to them.

# Appendix 6

**From:** Anita Barzey [REDACTED]  
**Sent:** 08 March 2018 17:00  
**To:** Mohshin Ali  
**Subject:** Re:Community Appeal against licensing application - 28 Hackney Road

**Dear Mohshin Ali,**

**Please find below a letter opposing the application to license the new coffee shop opposite our church community hub.**

**I and many others strongly oppose permission for alcohol to be sold from these premises which is just a few metres from the entrance of the new Tab church & Tab Centre community hub.**

**As a local resident/church member. I hope my voice will be heard on this matter.**

**I have lived locally for 30 years and am now raising my own child ,the rise in Anti social behavior over the last 10 years is evident . The local council should be looking at ways of reducing it .**

**Regards,  
Anita Barzey**

Dear sir/madam,

I am writing on behalf of the local community to oppose the above licensing application. You will be receiving many other letters/emails also opposing this application. This cafe immediately adjacent to a community hub that includes a church faith community building, a homeless shelter & homeless luncheon club, a service for vulnerable young people excluded from school, services for young children and services for vulnerable young people with severe disabilities and special needs.

The availability of alcohol in this immediately adjacent location will be a risk of harm to children and the other vulnerable groups that are supported by the community hub. The community hub also includes a specialist hospital for people for HIV and AIDS and Again this will be immediately adjacent to the coffee shop.

Although we recognise that the applicant is seeking to minimise crime and disorder, risk to public safety, public nuisance and harm to children through various actions, we do not believe that this will be sufficient to avoid these issues from occurring due to the close proximity of the coffee shop to the community hub. In particular the vulnerable young people that have been excluded from main stream education can potentially be affected by the immediate availability of alcohol but as importantly they can also be affected by behaviour associated with alcohol consumption on occasions.

The community hub also provides a wide range of services for young children and families, including a parents & toddlers group, kids club, youth club and an arts activities group for all ages and a full range of disabilities.

Unfortunately, the area around the Tab Centre, which is highly residential in nature, already experiences an unacceptable level of anti-social behaviour and many members of the community are concerned this would only increase should another this licence be granted.

As a faith community we have no issue with alcohol at all in the right context and location. There has been a faith community in this site for 200 years, which as well as being a place of worship has always provided a full range of community activities. We are aware that the licensing committee is sensitive to this issue given the fantastic diversity of cultures and religions that we enjoy in Tower Hamlets.

We wish to make representations to the licensing committee and therefore wish to be informed with good notice as when this is likely to take place.

Yours sincerely,

**Anita Barzey**

\_\_\_\_\_

Sent from my iPhone

# Appendix 7



**Mohshin Ali**

---

**From:** Ann Buxton [REDACTED]  
**Sent:** 08 March 2018 21:34  
**To:** Mohshin Ali  
**Subject:** Community Appeal against licensing application - 28 Hackney Road

Dear Mohshin Ali,

I am writing to oppose the application to license the new coffee shop at 28 Hackney road, which is opposite the Shoreditch Baptist Church & community hub.

The café will be immediately adjacent to a community hub that includes a church faith community building, a homeless shelter & homeless luncheon club, a service for vulnerable young people excluded from school, services for young children and services for vulnerable young people with severe disabilities and special needs. And as such will potentially put the adults who attend these services at risk.

As a Street Pastor in this area I regularly see people adversely affected by the consumption of alcohol & it seems to me that there is already a large number of premises that sell & or serve alcohol, so can not see the need for more.

Yours sincerely,

**Ann Buxton**

[REDACTED]  
[REDACTED]  
[REDACTED]

# Appendix 8

## Mohshin Ali

---

**From:** Christiana [REDACTED]  
**Sent:** 08 March 2018 14:49  
**To:** Mohshin Ali  
**Subject:** Community Appeal against licensing application - 28 Hackney Road

Dear Mohshin Ali,

Please find below a letter opposing the application to license the new coffee shop opposite our church community hub.

I and many others strongly oppose permission for alcohol to be sold from these premises which is just a few metres from the entrance of the new Tab church & Tab Centre community hub.

I have been a local church member for 22 years and have recently become a staff member on the varying projects we run here which involve work with the elderly, young people, homeless and members of the community. I hope my voice will be heard on this matter.

Regards,

Christiana Amao

Dear sir/madam,

I am writing on behalf of the local community to oppose the above licensing application. You will be receiving many other letters/emails also opposing this application. This cafe immediately adjacent to a community hub that includes a church faith community building, a homeless shelter & homeless luncheon club, a service for vulnerable young people excluded from school, services for young children and services for vulnerable young people with severe disabilities and special needs.

The availability of alcohol in this immediately adjacent location will be a risk of harm to children and the other vulnerable groups that are supported by the community hub. The community hub also includes a specialist hospital for people for HIV and AIDS and Again this will be immediately adjacent to the coffee shop.

Although we recognise that the applicant is seeking to minimise crime and disorder, risk to public safety, public nuisance and harm to children through various actions, we do not believe that this will be sufficient to avoid these issues from occurring due to the close proximity of the coffee shop to the community hub. In particular the vulnerable young people that have been excluded from main stream education can potentially

be affected by the immediate availability of alcohol but as importantly they can also be affected by behaviour associated with alcohol consumption on occasions.

The community hub also provides a wide range of services for young children and families, including a parents & toddlers group, kids club, youth club and an arts activities group for all ages and a full range of disabilities.

Unfortunately, the area around the Tab Centre, which is highly residential in nature, already experiences an unacceptable level of anti-social behaviour and many members of the community are concerned this would only increase should another this licence be granted.

As a faith community we have no issue with alcohol at all in the right context and location. There has been a faith community in this site for 200 years, which as well as being a place of worship has always provided a full range of community activities. We are aware that the licensing committee is sensitive to this issue given the fantastic diversity of cultures and religions that we enjoy in Tower Hamlets.

We wish to make representations to the licensing committee and therefore wish to be informed with good notice as when this is likely to take place.

Yours sincerely,  
Christiana Amao

[Redacted signature]

TransformShoreditch Project Support Worker

[Redacted contact information]



# Appendix 9

## Mohshin Ali

---

**From:** [REDACTED]  
**Sent:** 08 March 2018 18:03  
**To:** Mohshin Ali  
**Subject:** Community Appeal against licensing application - 28 Hackney Road

Dear Mr Ali,

I am writing to you to express my concern about the new licencing application for 28 Hackney Road. Not only is this directly opposite a church but it is also opposite The Tab Centre - a hub and place of safety for many vulnerable people from the local community.

Yet another place selling alcohol every day of the week could have a devastating effect on the people; both young and old; who attend clubs and projects at this community centre. The Mildmay HIV/AIDS Hospital is also across the road from 28 Hackney Road and they would also agree that another licenced premises so close to them will only be harmful to their clients.

Unfortunately, the area around the Tab Centre, which is highly residential in nature, already experiences an unacceptable level of anti-social behaviour and there are many people already struggling with drug and alcohol addictions. The Tab Centre and The Shoreditch Tabernacle Baptist Church have, for many years, been working hard to help and support those who are trying to move on with their lives. Many members of the community are concerned the problems would only increase should another this licence be granted.

I personally run a charity called Arts For All in The Tab Centre, working with disadvantaged families and adults with learning disabilities. I would like to appeal to you and ask you to please consider refusing this licence as I believe that it would be detrimental to the local community and cause considerable harm.

Yours sincerely

Caroline Barlow – Arts For All

# Appendix 10

## Mohshin Ali

---

**From:** C JOSEPH [REDACTED]  
**Sent:** 08 March 2018 16:34  
**To:** Mohshin Ali  
**Subject:** Community Appeal against licensing application -28 Hackney Road

Dear Mohshin Ali,

Please find below a letter opposing the application to license the new coffee shop opposite our church community hub.

I and many others strongly oppose permission for alcohol to be sold from these premises which is just a few metres from the entrance of the new Tab church & Tab Centre community hub.

As a local resident/church member/attendee of the projects I hope my voice will be heard on this matter.

Please personalise this part (if you wish) just to say who you are eg I live locally /I am involved with the church/Transform Shoreditch projects.

Regards,  
**Cuthbert Joseph**

Dear sir/madam,

I am writing on behalf of the local community to oppose the above licensing application. You will be receiving many other letters/emails also opposing this application. This cafe immediately adjacent to a community hub that includes a church faith community building, a homeless shelter & homeless luncheon club, a service for vulnerable young people excluded from school, services for young children and services for vulnerable young people with severe disabilities and special needs.

The availability of alcohol in this immediately adjacent location will be a risk of harm to children and the other vulnerable groups that are supported by the community hub. The community hub also includes a specialist hospital for people for HIV and AIDS and Again this will be immediately adjacent to the coffee shop.

Although we recognise that the applicant is seeking to minimise crime and disorder, risk to public safety, public nuisance and harm to children through various actions, we do not believe that this will be sufficient to avoid these issues from occurring due to the close proximity of the coffee shop to the community hub. In particular the vulnerable young people that have been excluded from main stream education can potentially be affected by the immediate availability of alcohol but as importantly they can also be affected by behaviour associated with alcohol consumption on occasions.



The community hub also provides a wide range of services for young children and families, including a parents & toddlers group, kids club, youth club and an arts activities group for all ages and a full range of disabilities.

Unfortunately, the area around the Tab Centre, which is highly residential in nature, already experiences an unacceptable level of anti-social behaviour and many members of the community are concerned this would only increase should another this licence be granted.

As a faith community we have no issue with alcohol at all in the right context and location. There has been a faith community in this site for 200 years, which as well as being a place of worship has always provided a full range of community activities. We are aware that the licensing committee is sensitive to this issue given the fantastic diversity of cultures and religions that we enjoy in Tower Hamlets.

We wish to make representations to the licensing committee and therefore wish to be informed with good notice as when this is likely to take place.

Yours sincerely,

**Mr Cuthbert Joseph**

████████████████████

████████████████████

██████████

██████████

# Appendix 11

**Mohshin Ali**

---

**From:** Dave & Chrissy Pilkington [REDACTED]  
**Sent:** 08 March 2018 19:47  
**To:** Mohshin Ali  
**Subject:** Community appeal against licensing application for Di-Stephano -, 28 Hackney Road

Dear Mohshin Ali,

Please find below a letter opposing the application to license the new coffee shop opposite our church community hub.

I and many others strongly oppose permission for alcohol to be sold from these premises which is just a few metres from the entrance of the new Tab church & Tab Centre community hub.

I was the project coordinator for the community projects at the Tab Centre and I hope my voice will be heard on this matter.

Regards,

Christina Pilkington

-----

Dear sir/madam,

I am writing on behalf of the local community to oppose the above licensing application. You will be receiving many other letters/emails also opposing this application. This cafe immediately adjacent to a community hub that includes a church faith community building, a homeless shelter & homeless luncheon club, a service for vulnerable young people excluded from school, services for young children and services for vulnerable young people with severe disabilities and special needs.

The availability of alcohol in this immediately adjacent location will be a risk of harm to children and the other vulnerable groups that are supported by the community hub. The

community hub also includes a specialist hospital for people for HIV and AIDS and again this will be immediately adjacent to the coffee shop.

Although we recognise that the applicant is seeking to minimise crime and disorder, risk to public safety, public nuisance and harm to children through various actions, we do not believe that this will be sufficient to avoid these issues from occurring due to the close proximity of the coffee shop to the community hub. In particular the vulnerable young people that have been excluded from main stream education can potentially be affected by the immediate availability of alcohol but as importantly they can also be affected by behaviour associated with alcohol consumption on occasions.

The community hub also provides a wide range of services for young children and families, including a parents & toddlers group, kids club, youth club and an arts activities group for all ages and a full range of disabilities.

Unfortunately, the area around the Tab Centre, which is highly residential in nature, already experiences an unacceptable level of anti-social behaviour and many members of the community are concerned this would only increase should another this licence be granted.

As a faith community we have no issue with alcohol at all in the right context and location. There has been a faith community in this site for 200 years, which as well as being a place of worship has always provided a full range of community activities. We are aware that the licensing committee is sensitive to this issue given the fantastic diversity of cultures and religions that we enjoy in Tower Hamlets.

We wish to make representations to the licensing committee and therefore wish to be informed with good notice as when this is likely to take place.

Yours sincerely,

**Christina Pilkington**

████████████████████

██████████

██████████

# Appendix 12

## Mohshin Ali

---

**From:** David Leak [REDACTED]  
**Sent:** 08 March 2018 16:33  
**To:** Mohshin Ali  
**Subject:** Appeal against licensing application - 28 Hackney Road  
**Attachments:** HackneyRd28.DiStefano.106542.RED.pdf

Appeal against licensing application - 28 Hackney Road (Copy of application attached)

[Mohshin.Ali@towerhamlets.gov.uk](mailto:Mohshin.Ali@towerhamlets.gov.uk)

Dear Mohshin Ali,

I and many others strongly oppose permission for alcohol to be sold from these premises which is just a few metres from the entrance of the new Tab church & Tab Centre community hub. As a member of the church, for over 5 years, I trust that you will consider my views on this matter. Although I do not live in the immediate area I am concerned as member of the church about the effects of granting a license would have upon the activities run by our centre and the clients that attend.

Therefore I am writing to oppose the above licensing application. This café/coffee shop is immediately adjacent to a community hub that includes a church faith community building, a homeless shelter & homeless luncheon club, a service for vulnerable young people excluded from school, services for young children and services for vulnerable young people with severe disabilities and special needs.

The availability of alcohol in this immediately adjacent location will be a risk of harm to children and the other vulnerable groups that are supported by the community hub.

Although I recognise that the applicant is seeking to minimise crime and disorder, risk to public safety, public nuisance and harm to children through various actions, I do not believe that this will be sufficient to avoid these issues from occurring due to the close proximity of the café/coffee shop to the community hub. In particular the vulnerable young people that have been excluded from main stream education can potentially be affected by the immediate availability of alcohol but as importantly they can also be affected by behaviour associated with alcohol consumption on occasions.

The community hub also provides a wide range of services for young children and families, including a parents and toddlers group, kids club, youth club and an arts activities group for all ages and a full range of disabilities.

Unfortunately, the area around the Tab Centre, which is highly residential in nature, already experiences an unacceptable level of anti-social behaviour and many members of the community are concerned this would only increase should another this licence be granted.

As a faith community we have no issue with alcohol at all in the right context and location.

Please would you inform me with good notice when the application is to be heard at the licensing committee.

Yours sincerely,

David Leak



# Appendix 13



## Mohshin Ali

---

**From:** Dominy Roe [REDACTED]  
**Sent:** 08 March 2018 18:47  
**To:** Mohshin Ali  
**Subject:** Community Appeal against licensing application - Di-Stefanos 28 Hackney Road

**Follow Up Flag:** Follow up  
**Flag Status:** Flagged

Hi Mohshin,

Thank you for all of your support so far. On reflection, I just wanted to add the following to my letter:

*We work with some of the most vulnerable people in our community - through our homeless projects, youth club, alternative education programme and elderly project. We have a number of local people that we work with and have longstanding relationships with the children and parents/guardians of our neighbours. Our projects are so important to us and we influence real change and transformation in the lives of some of the most disadvantaged and disengaged local people experiencing a multitude of barriers.*

*In 2016 the church kindly agreed to work in partnership with TransformUK to open an alternative education provision using the church's building. This has meant we are able to support up to 8 of the most 'high risk' young people in the borough in partnership with social care services, youth offending, local schools and the pupil referral unit. In addition to this we also support a number of other young people at risk of exclusion through our School Intervention Programmes. I am highlighting this as these young people are extremely vulnerable and, whilst they are highly supported by staff here, a premises serving alcohol all day right next to our building poses significant risk.*

*In addition, we ran a crowdfunding campaign last year and were extremely grateful to receive a pledge of £10,000 from LBTH which is to support our building (directly opposite this one) to be a hub for the community and include support sessions around employment, mental health, emotional wellbeing etc. It would seem strange and almost as though LBTH are contradicting the work to then approve a premises serving alcohol all day just next to us!*

I hope you understand the reason for my level of concern.

I have included it in the below too.

Many Thanks

Dominy

Dear sir/madam,

I am writing on behalf of the local community to oppose the above licensing application. You will be receiving many other letters/emails also opposing this application. This cafe immediately adjacent to a community hub that includes a church faith community building, a homeless shelter

& homeless luncheon club, a service for vulnerable young people excluded from school, services for young children and services for vulnerable young people with severe disabilities and special needs.

The availability of alcohol in this immediately adjacent location will be a risk of harm to children and the other vulnerable groups that are supported by the community hub. The community hub also includes a specialist hospital for people for HIV and AIDS and Again this will be immediately adjacent to the coffee shop.

Although we recognise that the applicant is seeking to minimise crime and disorder, risk to public safety, public nuisance and harm to children through various actions, we do not believe that this will be sufficient to avoid these issues from occurring due to the close proximity of the coffee shop to the community hub. In particular the vulnerable young people that have been excluded from main stream education can potentially be affected by the immediate availability of alcohol but as importantly they can also be affected by behaviour associated with alcohol consumption on occasions.

The community hub also provides a wide range of services for young children and families, including a parents & toddlers group, kids club, youth club and an arts activities group for all ages and a full range of disabilities.

We work with some of the most vulnerable people in our community - through our homeless projects, youth club, alternative education programme and elderly project. We have a number of local people that we work with and have longstanding relationships with the children and parents/guardians of our neighbours. Our projects are so important to us and we influence real change and transformation in the lives of some of the most disadvantaged and disengaged local people experiencing a multitude of barriers.

In 2016 the church kindly agreed to work in partnership with TransformUK to open an alternative education provision using the church's building. This has meant we are able to support up to 8 of the most 'high risk' young people in the borough in partnership with social care services, youth offending, local schools and the pupil referral unit. In addition to this we also support a number of other young people at risk of exclusion through our School Intervention Programmes. I am highlighting this as these young people are extremely vulnerable and, whilst they are highly supported by staff here, a premises serving alcohol all day right next to our building poses significant risk.

Unfortunately, the area around the Tab Centre, which is highly residential in nature, already experiences an unacceptable level of anti-social behaviour and many members of the community are concerned this would only increase should another this licence be granted.

As a faith community we have no issue with alcohol at all in the right context and location. There has been a faith community in this site for 200 years, which as well as being a place of worship has always provided a full range of community activities. We are aware that the licensing committee is sensitive to this issue given the fantastic diversity of cultures and religions that we enjoy in Tower Hamlets.

We wish to make representations to the licensing committee and therefore wish to be informed with good notice as when this is likely to take place.

Yours sincerely,

**Dominy Roe**  
**TransformShoreditch Project Director**

## Mohshin Ali

---

**From:** Dominy Roe [REDACTED]  
**Sent:** 08 March 2018 14:44  
**To:** Mohshin Ali  
**Subject:** Community Appeal against licensing application

Dear Mohshin Ali,

Please find below a letter opposing the application to license the new coffee shop opposite our church community hub.

I and many others strongly oppose permission for alcohol to be sold from these premises which is just a few metres from the entrance of the new Tab church & Tab Centre community hub.

As a local resident, church member and staff member on the youth and community projects we run here, I hope my voice will be heard on this matter.

I have lived locally for nearly four years, am the Director of our Youth and Community projects and an active local resident.

Regards,

Dominy Roe

Dear sir/madam,

I am writing on behalf of the local community to oppose the above licensing application. You will be receiving many other letters/emails also opposing this application. This cafe immediately adjacent to a community hub that includes a church faith community building, a homeless shelter & homeless luncheon club, a service for vulnerable young people excluded from school, services for young children and services for vulnerable young people with severe disabilities and special needs.

The availability of alcohol in this immediately adjacent location will be a risk of harm to children and the other vulnerable groups that are supported by the community hub. The community hub also includes a specialist hospital for people for HIV and AIDS and Again this will be immediately adjacent to the coffee shop.

Although we recognise that the applicant is seeking to minimise crime and disorder, risk to public safety, public nuisance and harm to children through various actions, we do not believe that this will be sufficient to avoid these issues from occurring due to the close proximity of the coffee shop to the community hub. In particular the vulnerable young people that have been excluded from main stream education can potentially be affected by the immediate availability of alcohol but as importantly they can also be affected by behaviour associated with alcohol consumption on occasions.

The community hub also provides a wide range of services for young children and families, including a parents & toddlers group, kids club, youth club and an arts activities group for all ages and a full range of disabilities.

Unfortunately, the area around the Tab Centre, which is highly residential in nature, already experiences an unacceptable level of anti-social behaviour and many members of the community are concerned this would only increase should another this licence be granted.

As a faith community we have no issue with alcohol at all in the right context and location. There has been a faith community in this site for 200 years, which as well as being a place of worship has always provided a full range of community activities. We are aware that the licensing committee is sensitive to this issue given the fantastic diversity of cultures and religions that we enjoy in Tower Hamlets.

We wish to make representations to the licensing committee and therefore wish to be informed with good notice as when this is likely to take place.

Yours sincerely,

**Dominy Roe**  
[Redacted]  
[Redacted]  
[Redacted]

**Dominy Roe**  
**TransformShoreditch Project Director**  
[Redacted]  
[Redacted]  
[Redacted]  
[Redacted]



TransformShoreditch  
is a partnership between Shoreditch Tab and Transform UK.



"Bringing transformational love to our local community"

# Appendix 14

## Mohshin Ali

---

**From:** Eddie Stride [REDACTED]  
**Sent:** 08 March 2018 17:34  
**To:** Mohshin Ali  
**Subject:** Re: Community Appeal against licensing application - 28 Hackney Road

Dear Mohshin Ali,

Please find below a letter opposing the application to license the new coffee shop opposite our church community hub.

I and many others strongly oppose permission for alcohol to be sold from these premises which is just a few metres from the entrance of the new Tab church & Tab Centre community hub.

As a local resident in Tower hamlets, a church member and someone who helps run some of the projects from the space, I hope my voice will be heard on this matter.

Regards

Eddie Stride

Dear sir/madam,

I am writing on behalf of the local community to oppose the above licensing application. You will be receiving many other letters/emails also opposing this application. This cafe immediately adjacent to a community hub that includes a church faith community building, a homeless shelter & homeless luncheon club, a service for vulnerable young people excluded from school, services for young children and services for vulnerable young people with severe disabilities and special needs.

The availability of alcohol in this immediately adjacent location will be a risk of harm to children and the other vulnerable groups that are supported by the community hub. The community hub also includes a specialist hospital for people for HIV and AIDS and Again this will be immediately adjacent to the coffee shop.

Although we recognise that the applicant is seeking to minimise crime and disorder, risk to public safety, public nuisance and harm to children through various actions, we do not believe that this will be sufficient to avoid these issues from occurring due to the close proximity of the coffee shop to the community hub. In particular the vulnerable young people that have been excluded from main stream education can potentially be affected by the immediate availability of alcohol but as importantly they can also be affected by behaviour associated with alcohol consumption on occasions.

The community hub also provides a wide range of services for young children and families, including a parents & toddlers group, kids club, youth club and an arts activities group for all ages and a full range of disabilities.

Unfortunately, the area around the Tab Centre, which is highly residential in nature, already experiences an unacceptable level of anti-social behaviour and many members of the community are concerned this would only increase should another this licence be granted.

As a faith community we have no issue with alcohol at all in the right context and location. There has been a faith community in this site for 200 years, which as well as being a place of worship has always provided a full range of community activities. We are aware that the licensing committee is sensitive to this issue given the fantastic diversity of cultures and religions that we enjoy in Tower Hamlets.

We wish to make representations to the licensing committee and therefore wish to be informed with good notice as when this is likely to take place.

Yours sincerely,

**Eddie Stride**  
[REDACTED]

# Appendix 15

## Mohshin Ali

---

**From:** funmi afuwape [REDACTED]  
**Sent:** 08 March 2018 20:04  
**To:** Mohshin Ali  
**Subject:** Proposed Licensing Application

Dear Mr Ali

I am writing on behalf of the local community to oppose the above licensing application. You will be receiving many other emails also opposing this application. This cafe immediately adjacent to a community hub that includes a church faith community building, a homeless shelter & homeless luncheon club, a service for vulnerable young people excluded from school, services for young children and services for vulnerable young people with severe disabilities and special needs.

The availability of alcohol in this immediately adjacent location will be a risk of harm to children and the other vulnerable groups that are supported by the community hub. The community hub also includes a specialist hospital for people for HIV and AIDS and Again this will be immediately adjacent to the coffee shop.

Although we recognise that the applicant is seeking to minimise crime and disorder, risk to public safety, public nuisance and harm to children through various actions, we do not believe that this will be sufficient to avoid these issues from occurring due to the close proximity of the coffee shop to the community hub. In particular the vulnerable young people that have been excluded from main stream education can potentially be affected by the immediate availability of alcohol but as importantly they can also be affected by behaviour associated with alcohol consumption on occasions.

The community hub also provides a wide range of services for young children and families, including a parents & toddlers group, kids club, youth club and an arts activities group for all ages and a full range of disabilities.

Unfortunately, the area around the Tab Centre, which is highly residential in nature, already experiences an unacceptable level of anti-social behaviour and many members of the community are concerned this would only increase should another this licence be granted.

As a faith community we have no issue with alcohol at all in the right context and location. There has been a faith community in this site for 200 years, which as well as being a place of worship has always provided a full range of community activities. We are aware that the licensing committee is sensitive to this issue given the fantastic diversity of cultures and religions that we enjoy in Tower Hamlets.

We wish to make representations to the licensing committee and therefore wish to be informed with good notice as when this is likely to take place.

Yours sincerely,

**Funmi Afuwape**

[REDACTED]



# Appendix 16

## Mohshin Ali

---

**From:** Georgina Stride [REDACTED]  
**Sent:** 08 March 2018 15:41  
**To:** Mohshin Ali  
**Cc:** Tom Lewis  
**Subject:** RE: 28 Hackney Road, London E2 7PA  
**Attachments:** Letter to Mohshin Ali 08 March 2018.doc

Dear Mohshin I hope you are well.

Thank you for sending me the application yesterday this was very helpful.

I have a letter attached to you and your team.

I look forward to hearing from you especially in what will be our next steps as this is all very new to me.

Once again thank you for your support and hard work.

Georgina

--

Rev. Georgina Stride  
Shoreditch Tabernacle Baptist Church

[REDACTED]

[REDACTED]

[REDACTED]

[REDACTED]

[REDACTED]

Date: 08 March 2018

Dear Mohshin,

I am writing to oppose the above licensing application and understand that you will be receiving many other letters/emails also opposing this application.

I would like to object on the basis that the licensing objectives of protection of children from harm, prevention of crime and disorder and public nuisance will be adversely affected.

This cafe immediately adjacent to a community hub that includes a church faith community building, a homeless shelter & homeless luncheon club, a service for vulnerable young people excluded from school, services for young children, services for vulnerable young people with severe disabilities and special needs.

The availability of alcohol in this location will be a risk of harm to children and the other vulnerable groups that are supported by the community hub. The community hub also includes a specialist hospital for people for HIV and AIDS and again this will be immediately adjacent to the coffee shop. The availability of alcohol that can be purchased for consumption on the premises, or taken away and consumed is of great concern.

Although we recognise that the applicant has offered various measures 'to minimise crime and disorder, risk to public safety, public nuisance and harm to children through various actions', we do not believe that this will be sufficient to avoid these issues from occurring due to the close proximity of the coffee shop to the community hub and given the hours that have been applied for. In particular the vulnerable young people that have been excluded from education can potentially be affected by the immediate availability of alcohol but as important they can also be affected by behaviour associated with alcohol consumption on occasions. Many of the control measures seem to have been 'cut and pasted' into the various sections and I suspect have simply been copied from other applications.

The community hub also provides a wide range of services for young children and families, including a parents & toddlers group, kids club, youth club and an arts activities group for all ages and a full range of disabilities.

Unfortunately, the area around the Tab Centre, which is highly residential in nature, already experiences an unacceptable level of anti-social behaviour and many members of the community are concerned this would only increase should another this licence be granted.

I have no issue with alcohol in the right context and location. There has been a faith community in this site for 200 years, which as well as being a place of worship has always provided a full range of community activities. I am aware that the licensing committee is sensitive to this issue given the fantastic diversity of cultures and religions that we enjoy in Tower Hamlets.

I wish to expand on this representation at the licensing committee and may provide additional documentation before the hearing date. Unfortunately, I have only just become aware of the application and the application documents were not published on the Council's website. The applicant has not approached me to discuss the application at all.

I would also like to draw to your attention that the application is defective as the application does not appear to have been advertised on the Council's website as required. I see that the website says that the application was lodged on the 8<sup>th</sup> February, but the site notice says it was lodged on 9<sup>th</sup> February. The application is also incomplete in a number of respects. In particular, the checklist at the end of the application has not been completed. My view is that this makes the application invalid. As the applicant was professionally represented, there should be no excuse for this omission and the application should not have been lodged in its current form.

Yours sincerely,

A large black rectangular redaction box covering the signature of Reverend Georgina Stride.

Reverend Georgina Stride

# Appendix 17

## Mohshin Ali

---

**From:** geecee da [REDACTED]  
**Sent:** 08 March 2018 16:19  
**To:** Mohshin Ali  
**Subject:** Community Appeal against licensing application - 28 Hackney Road

Dear Mohshin Ali,

Please find below a letter opposing the application to license the new coffee shop opposite our church community hub.

I and many others strongly oppose permission for alcohol to be sold from these premises which is just a few metres from the entrance of the new Tab church & Tab Centre community hub.

**As local resident of the area and with a strong affiliation to the church as my Son attends youth group at the Transform Shoreditch project, I do hope that my view and opinion is taken seriously.**

Regards,

**Hayley Cotter**

Dear sir/madam,

I am writing on behalf of the local community to oppose the above licensing application. You will be receiving many other letters/emails also opposing this application. This cafe immediately adjacent to a community hub that includes a church faith community building, a homeless shelter & homeless luncheon club, a service for vulnerable young people excluded from school, services for young children and services for vulnerable young people with severe disabilities and special needs.

The availability of alcohol in this immediately adjacent location will be a risk of harm to children and the other vulnerable groups that are supported by the community hub. The community hub also includes a specialist hospital for people for HIV and AIDS and Again this will be immediately adjacent to the coffee shop.

Although we recognise that the applicant is seeking to minimise crime and disorder, risk to public safety, public nuisance and harm to children through various actions, we do not believe that this will be sufficient to avoid these issues from occurring due to the close proximity of the coffee shop to the community hub. In particular the vulnerable young people that have been excluded from main stream education can potentially be affected by the immediate availability of alcohol but as importantly they can also be affected by behaviour associated with alcohol consumption on occasions.

The community hub also provides a wide range of services for young children and families, including a parents & toddlers group, kids club, youth club and an arts activities group for all ages and a full range of disabilities.

Unfortunately, the area around the Tab Centre, which is highly residential in nature, already experiences an unacceptable level of anti-social behaviour and many members of the community are concerned this would only increase should another this licence be granted.

As a faith community we have no issue with alcohol at all in the right context and location. There has been a faith community in this site for 200 years, which as well as being a place of worship has always provided a full range of community activities. We are aware that the licensing committee is sensitive to this issue given the fantastic diversity of cultures and religions that we enjoy in Tower Hamlets.

We wish to make representations to the licensing committee and therefore wish to be informed with good notice as when this is likely to take place.

Yours sincerely,

**Hayley Cotter**

[REDACTED]  
[REDACTED]  
[REDACTED]

# Appendix 18



## Mohshin Ali

---

**From:** Juliana David French <[REDACTED]>  
**Sent:** 08 March 2018 20:14  
**To:** Mohshin Ali  
**Subject:** Community Appeal against licensing application - 28 Hackney Road E2 7PA (Di-Stephano Coffee Shop)

Dear Mohshin,

I hope you are well.

Please find below a letter opposing the application to license the new coffee shop opposite our church community hub.

I and many others strongly oppose permission for alcohol to be sold from these premises which is just a few metres from the entrance of the new Tab church & Tab Centre community hub.

The Tab Church and Tab Centre have been at the heart of the community and host a variety of different projects and serves the local people every day. As a church member I feel strongly about opposing this licence as this would have an adverse effect on the service users who are vulnerable groups recovering from addictions and young adults who use the Tab as a safe and welcoming place.

I hope my voice will be heard and licence will not be issued.

Thank you.  
Juliana

Dear sir/madam,

I am writing on behalf of the local community to oppose the above licensing application. You will be receiving many other letters/emails also opposing this application. This cafe immediately adjacent to a community hub that includes a church faith community building, a homeless shelter & homeless luncheon club, a service for vulnerable young people excluded from school, services for young children and services for vulnerable young people with severe disabilities and special needs.

The availability of alcohol in this immediately adjacent location will be a risk of harm to children and the other vulnerable groups that are supported by the community hub. The community hub also includes a specialist hospital for people for HIV and AIDS and Again this will be immediately adjacent to the coffee shop.

Although we recognise that the applicant is seeking to minimise crime and disorder, risk to public safety, public nuisance and harm to children through various actions, we do not believe that this will be sufficient to avoid these issues from occurring due to the close proximity of the coffee shop to the community hub. In particular the vulnerable young people that have been excluded from main stream education can potentially be affected by the immediate availability of alcohol but as importantly they can also be affected by behaviour associated with alcohol consumption on occasions.

The community hub also provides a wide range of services for young children and families, including a parents & toddlers group, kids club, youth club and an arts activities group for all ages and a full range of disabilities.

Unfortunately, the area around the Tab Centre, which is highly residential in nature, already experiences an unacceptable level of anti-social behaviour and many members of the community are concerned this would only increase should another this licence be granted.

As a faith community we have no issue with alcohol at all in the right context and location. There has been a faith community in this site for 200 years, which as well as being a place of worship has always provided a full range of community activities. We are aware that the licensing committee is sensitive to this issue given the fantastic diversity of cultures and religions that we enjoy in Tower Hamlets.

We wish to make representations to the licensing committee and therefore wish to be informed with good notice as when this is likely to take place.

Yours sincerely,  
Juliana

Juliana David French

[REDACTED]  
[REDACTED]

# Appendix 19

## Mohshin Ali

---

**From:** Jake Kemp [REDACTED]  
**Sent:** 08 March 2018 16:05  
**To:** Mohshin Ali  
**Subject:** New License application - 28 Hackney Road - TAB Centre & Mildmay Hospital, Shoreditch

Dear Sir

I am writing on behalf of the local community to oppose the above licensing application. This cafe immediately adjacent to a community hub that includes a church faith community building, a homeless shelter & homeless luncheon club, a service for vulnerable young people excluded from school, services for young children and services for vulnerable young people with severe disabilities and special needs. I work at The TAB with young people and pensioners providing lunch every Tuesday during the school term.

The availability of alcohol in this immediately adjacent location will be a risk of harm to children and the other vulnerable groups that are supported by the community hub. The community hub also includes a specialist hospital for people for HIV and AIDS and Again this will be immediately adjacent to the coffee shop.

Although we recognise that the applicant is seeking to minimise crime and disorder, risk to public safety, public nuisance and harm to children through various actions, we do not believe that this will be sufficient to avoid these issues from occurring due to the close proximity of the coffee shop to the community hub. In particular the vulnerable young people that have been excluded from main stream education can potentially be affected by the immediate availability of alcohol but as importantly they can also be affected by behaviour associated with alcohol consumption on occasions.

The proximity of Acorn House (men's rehabilitation centre) and The New Hanbury Project (recovery centre) means the area is busy with vulnerable men who sometimes struggle to avoid alcohol. Another outlet in an already over-supplied market is unnecessary.

The community hub also provides a wide range of services for young children and families, including a parents & toddlers group, kids club, youth club and an arts activities group for all ages and a full range of disabilities.

Unfortunately, the area around the Tab Centre, which is highly residential in nature, already experiences an unacceptable level of anti-social behaviour and many members of the community are concerned this would only increase should another this licence be granted.

There has been a faith community in this site for 200 years, which as well as being a place of worship has always provided a full range of community activities.

We wish to make representations to the licensing committee and therefore wish to be informed with good notice as when this is likely to take place.

Yours sincerely,  
Jake

Mr J. Kemp  
[REDACTED]  
[REDACTED]

# Appendix 20

## Mohshin Ali

---

**From:** Kate Hilton <[REDACTED]>  
**Sent:** 08 March 2018 19:54  
**To:** Mohshin Ali  
**Cc:** Dominy Roe  
**Subject:** Opposing licence application 08.03.18

Dear Mohshin Ali,

Please find below a letter opposing the application to license the new coffee shop opposite our church community hub.

I and many others strongly oppose permission for alcohol to be sold from these premises which is just a few metres from the entrance of the new Tab church & Tab Centre community hub.

As a church member and employee of TransformUK a organisation in partnership with the church I hope my voice will be heard on this matter.

I am currently working on TransformUK's Alternative Provision where I work directly with vulnerable young people from tower hamlets whom this licence is likely to effect.

Regards,

Kate Hilton

TransformUK TransformShoreditch

Student Development Coach

[REDACTED]

[REDACTED]

# Appendix 21

## Mohshin Ali

---

**From:** Kennedy Yfeko [REDACTED]  
**Sent:** 08 March 2018 16:32  
**To:** Mohshin Ali  
**Subject:** Community Appeal against licensing application - 28 Hackney Road

Dear Mohshin Ali,

Please find below a letter opposing the application to license the new coffee shop opposite our church community hub.

I and many others strongly oppose permission for alcohol to be sold from these premises which is just a few metres from the entrance of the new Tab church & Tab Centre community hub.

As a church member and an employee of the projects i hope my voice will be heard on this matter.

I am involved in the church and i have been attending this church since 2014. I am also heavily involved in transform shoreditch.

Regards,  
Kennedy Yfeko

Dear sir/madam,

I am writing on behalf of the local community to oppose the above licensing application. You will be receiving many other letters/emails also opposing this application. This cafe immediately adjacent to a community hub that includes a church faith community building, a homeless shelter & homeless luncheon club, a service for vulnerable young people excluded from school, services for young children and services for vulnerable young people with severe disabilities and special needs.

The availability of alcohol in this immediately adjacent location will be a risk of harm to children and the other vulnerable groups that are supported by the community hub. The community hub also includes a specialist hospital for people for HIV and AIDS and Again this will be immediately adjacent to the coffee shop.

Although we recognise that the applicant is seeking to minimise crime and disorder, risk to public safety, public nuisance and harm to children through various actions, we do not believe that this will be sufficient to avoid these issues from occurring due to the close proximity of the coffee shop to the community hub. In particular the vulnerable young people that have been excluded from main stream education can potentially be affected by the immediate availability of alcohol but as importantly they can also be affected by behaviour associated with alcohol consumption on occasions.

The community hub also provides a wide range of services for young children and families, including a parents & toddlers group, kids club, youth club and an arts activities group for all ages and a full range of disabilities.



Unfortunately, the area around the Tab Centre, which is highly residential in nature, already experiences an unacceptable level of anti-social behaviour and many members of the community are concerned this would only increase should another this licence be granted.

As a faith community we have no issue with alcohol at all in the right context and location. There has been a faith community in this site for 200 years, which as well as being a place of worship has always provided a full range of community activities. We are aware that the licensing committee is sensitive to this issue given the fantastic diversity of cultures and religions that we enjoy in Tower Hamlets.

We wish to make representations to the licensing committee and therefore wish to be informed with good notice as when this is likely to take place.

Yours sincerely,

Kennedy Yfeko

████████████████████

████████████████

██████████████

████████

# Appendix 22

## Mohshin Ali

---

**From:** Lisa Jones [REDACTED]  
**Sent:** 08 March 2018 15:14  
**To:** Mohshin Ali

Dear Mohshin Ali,

Please find below a letter opposing the application to license the new coffee shop opposite our church community hub.

I and many others strongly oppose permission for alcohol to be sold from these premises which is just a few metres from the entrance of the new Tab church & Tab Centre community hub.

**As a local resident/church member/attendee of the projects I hope my voice will be heard on this matter.**

**Please personalise this part (if you wish) just to say who you are eg I live locally /I am involved with the church/Transform Shoreditch projects.**

Lisa Jones

Dear sir/madam,

I am writing on behalf of the local community to oppose the above licensing application. You will be receiving many other letters/emails also opposing this application. This cafe immediately adjacent to a community hub that includes a church faith community building, a homeless shelter & homeless luncheon club, a service for vulnerable young people excluded from school, services for young children and services for vulnerable young people with severe disabilities and special needs.

The availability of alcohol in this immediately adjacent location will be a risk of harm to children and the other vulnerable groups that are supported by the community hub. The community hub also includes a specialist hospital for people for HIV and AIDS and Again this will be immediately adjacent to the coffee shop.

Although we recognise that the applicant is seeking to minimise crime and disorder, risk to public safety, public nuisance and harm to children through various actions, we do not believe that this will be sufficient to avoid these issues from occurring due to the close proximity of the coffee shop to the community hub. In particular the vulnerable young people that have been excluded from main stream education can potentially be affected by the immediate availability of alcohol but as importantly they can also be affected by behaviour associated with alcohol consumption on occasions.

The community hub also provides a wide range of services for young children and families, including a parents & toddlers group, kids club, youth club and an arts activities group for all ages and a full range of disabilities.

Unfortunately, the area around the Tab Centre, which is highly residential in nature, already experiences an unacceptable level of anti-social behaviour and many members of the community are concerned this would only increase should another this licence be granted.

As a faith community we have no issue with alcohol at all in the right context and location. There has been a faith community in this site for 200 years, which as well as being a place of worship has always provided a full range of community activities. We are aware that the licensing committee is sensitive to this issue given the fantastic diversity of cultures and religions that we enjoy in Tower Hamlets.

We wish to make representations to the licensing committee and therefore wish to be informed with good notice as when this is likely to take place.

Lisa Jones

[REDACTED]

[REDACTED]

[REDACTED]

[REDACTED]

# Appendix 23

## Mohshin Ali

---

**From:** leaklouise [REDACTED]  
**Sent:** 08 March 2018 14:24  
**To:** Mohshin Ali

Dear Mohshin Ali,

Please find below a letter opposing the application to license the new coffee shop opposite our church community hub.

I and many others strongly oppose permission for alcohol to be sold from these premises which is just a few metres from the entrance of the new Tab church & Tab Centre community hub.

As a church member I hope my voice will be heard on this matter.

Regards,

Louise Leak  
[REDACTED]

Dear sir/madam,

I am writing on behalf of the local community to oppose the above licensing application. You will be receiving many other letters/emails also opposing this application. This cafe immediately adjacent to a community hub that includes a church faith community building, a homeless shelter & homeless luncheon club, a service for vulnerable young people excluded from school, services for young children and services for vulnerable young people with severe disabilities and special needs.

The availability of alcohol in this immediately adjacent location will be a risk of harm to children and the other vulnerable groups that are supported by the community hub. The community hub also includes a specialist hospital for people for HIV and AIDS and Again this will be immediately adjacent to the coffee shop.

Although we recognise that the applicant is seeking to minimise crime and disorder, risk to public safety, public nuisance and harm to children through various actions, we do not believe that this will be sufficient to avoid these issues from occurring due to the close proximity of the coffee shop to the community hub. In particular the vulnerable young people that have been excluded from main stream education can potentially be affected by the immediate availability of alcohol but as importantly they can also be affected by behaviour associated with alcohol consumption on occasions.

The community hub also provides a wide range of services for young children and families, including a parents & toddlers group, kids club, youth club and an arts activities group for all ages and a full range of disabilities.

Unfortunately, the area around the Tab Centre, which is highly residential in nature, already experiences an unacceptable level of anti-social behaviour and many members of the community are concerned this would only increase should another this licence be granted.

As a faith community we have no issue with alcohol at all in the right context and location. There has been a faith community in this site for 200 years, which as well as being a place of worship has always provided a full range of community activities. We are aware that the licensing committee is sensitive to this issue given the fantastic diversity of cultures and religions that we enjoy in Tower Hamlets.

We wish to make representations to the licensing committee and therefore wish to be informed with good notice as when this is likely to take place.

Yours sincerely,

Louise Leak

A solid black rectangular redaction box covering the signature area.

# Appendix 24



## Mohshin Ali

---

**From:** naphtalia antia [REDACTED]  
**Sent:** 08 March 2018 20:37  
**To:** Mohshin Ali  
**Subject:** Opposing Licensing representation

Dear Mohshin Ali,

Please find below a letter opposing the application to license the new coffee shop opposite our church community hub.

I and many others strongly oppose permission for alcohol to be sold from these premises which is just a few metres from the entrance of the new Tab church & Tab Centre community hub.

**As a church member I hope my voice will be heard on this matter.**

Regards,  
**Naphtalia Antia**

Dear sir/madam,

I am writing on behalf of the local community to oppose the above licensing application. You will be receiving many other letters/emails also opposing this application. This cafe immediately adjacent to a community hub that includes a church faith community building, a homeless shelter & homeless luncheon club, a service for vulnerable young people excluded from school, services for young children and services for vulnerable young people with severe disabilities and special needs.

The availability of alcohol in this immediately adjacent location will be a risk of harm to children and the other vulnerable groups that are supported by the community hub. The community hub also includes a specialist hospital for people for HIV and AIDS and Again this will be immediately adjacent to the coffee shop.

Although we recognise that the applicant is seeking to minimise crime and disorder, risk to public safety, public nuisance and harm to children through various actions, we do not believe that this will be sufficient to avoid these issues from occurring due to the close proximity of the coffee shop to the community hub. In particular the vulnerable young people that have been excluded from main stream education can potentially be affected by the immediate availability of alcohol but as importantly they can also be affected by behaviour associated with alcohol consumption on occasions.

The community hub also provides a wide range of services for young children and families, including a parents & toddlers group, kids club, youth club and an arts activities group for all ages and a full range of disabilities.

Unfortunately, the area around the Tab Centre, which is highly residential in nature, already experiences an unacceptable level of anti-social behaviour and many members of the community are concerned this would only increase should another this licence be granted.

As a faith community we have no issue with alcohol at all in the right context and location. There has been a faith community in this site for 200 years, which as well as being a place of worship has always provided a full range of community activities. We are aware that the licensing committee is sensitive to this issue given the fantastic diversity of cultures and religions that we enjoy in Tower Hamlets.

We wish to make representations to the licensing committee and therefore wish to be informed with good notice as when this is likely to take place.

Yours sincerely,

**Naphtalia Antia**

[REDACTED]

[REDACTED]

# Appendix 25

## Mohshin Ali

---

**From:** Neville Reid <[REDACTED]>  
**Sent:** 08 March 2018 15:14  
**To:** Mohshin Ali  
**Subject:** 28 Hackney Road  
**Attachments:** 28 Hackney Road objection.pdf

Dear Mohshin Ali,

I attach a letter opposing the application for an alcohol licence in the new coffee shop opposite the church community hub at Hackney Road.

I and many others strongly oppose permission for alcohol to be sold from these premises which is just a few metres from the entrance of the new Shoreditch Tab church & Tab Centre community hub.

As a regular volunteer on local night-time patrols in that area, I trust that my views will be taken into account.

Kind regards,  
Neville Reid  
[REDACTED]

Mohshin Ali, Esq.  
Licensing Officer  
London Borough of Tower Hamlets  
London E3 5EQ

8 March 2018

Dear Mr Ali,

**Licensing Application – 28 Hackney Road**

I am writing to oppose the licensing application for the above premises. Although I live in another part of the Borough, I am very familiar with this location from patrolling the surrounding area on Friday nights as a volunteer team leader with Tower Hamlets Street Pastors.

I am particularly concerned about the possibility of a late-night alcohol licence in this location. It would accentuate and increase anti-social behaviour in the surrounding residential area, proving too much of a temptation for some patrons heading to or leaving the bars and clubs not far away. The area already experiences an unacceptable level of anti-social behaviour, and it is highly likely that this would only increase should this licence be granted.

This cafe is also immediately adjacent to a community hub that includes a church faith community building, a homeless shelter & homeless luncheon club, a service for vulnerable young people excluded from school, services for young children and services for vulnerable young people with severe disabilities and special needs.

The community hub also provides a wide range of services for young children and families, including a parents & toddlers group, kids club, youth club and an arts activities group for all ages and a full range of disabilities. The community hub also includes a specialist hospital for people for HIV and AIDS.

Even without the late-night aspect, the daytime availability of alcohol in this location would add a risk of harm to children and the other vulnerable groups that are supported by the community hub.

Although we recognise that the applicant is seeking to minimise crime and disorder, risk to public safety, public nuisance and harm to children through various actions, we do not believe that this will be sufficient to avoid these issues from occurring due to the close proximity of the coffee shop to the community hub. In particular the vulnerable young people that have been excluded from mainstream education can potentially be affected by the immediate availability of alcohol but as importantly they can also be affected by behaviour associated with alcohol consumption on occasions.

Yours sincerely,

Neville Reid

# Appendix 26

## Mohshin Ali

---

**From:** Steve Coles [REDACTED]  
**Sent:** 08 March 2018 16:48  
**To:** Mohshin Ali  
**Subject:** Community Appeal against licensing application - 28 Hackney Road

Dear Mohshin Ali,

Please find below a letter opposing the application to license the new coffee shop opposite the Tab Centre church and community hub.

I write to express my discomfort with the possibility of alcohol being sold from the premises at 28 Hackney Road, which is just a few metres from the entrance of the new Tab church & Tab Centre community hub.

I write as a leader of a local addictions recovery charity and partner with the Tab Centre on various community programmes. Thank you for the opportunity to submit this appeal.

Yours sincerely,

Steve

Dear sir/madam,

I am writing on behalf of the local community to oppose the above licensing application. You will be receiving many other letters/emails also opposing this application. This cafe immediately adjacent to a community hub that includes a church faith community building, a homeless shelter & homeless luncheon club, a service for vulnerable young people excluded from school, services for young children and services for vulnerable young people with severe disabilities and special needs.

The availability of alcohol in this immediately adjacent location will be a risk of harm to children and the other vulnerable groups that are supported by the community hub. The community hub also includes a specialist hospital for people for HIV and AIDS and Again this will be immediately adjacent to the coffee shop.

Although we recognise that the applicant is seeking to minimise crime and disorder, risk to public safety, public nuisance and harm to children through various actions, we do not believe that this will be sufficient to avoid these issues from occurring due to the close proximity of the coffee shop to the community hub. In particular the vulnerable young people that have been excluded from main stream education can potentially be affected by the immediate availability of alcohol but as importantly they can also be affected by behaviour associated with alcohol consumption on occasions.

The community hub also provides a wide range of services for young children and families, including a parents & toddlers group, kids club, youth club and an arts activities group for all ages and a full range of disabilities.

Unfortunately, the area around the Tab Centre, which is highly residential in nature, already experiences an unacceptable level of anti-social behaviour and many members of the community are concerned this would only increase should another this licence be granted.

As a faith community we have no issue with alcohol at all in the right context and location. There has been a faith community in this site for 200 years, which as well as being a place of worship has always provided a full range of

community activities. We are aware that the licensing committee is sensitive to this issue given the fantastic diversity of cultures and religions that we enjoy in Tower Hamlets.

We wish to make representations to the licensing committee and therefore wish to be informed with good notice as when this is likely to take place.

Yours sincerely,

Steve Coles



**STEVE COLES**

---

-  [Redacted]
  -  [Redacted]
  -  [Redacted]
  -  [Redacted]
- 

Registered Office: [Redacted]  
Registered Charity No. 1075947, Company No. 3734793 - Registered in England and Wales  
This email and any attachments to it may be confidential and are intended solely for the use of the individual to whom it is addressed. Any views or opinions expressed are solely those of the author and do not necessarily represent those of the Spitalfields Crypt Trust. If you are not the intended recipient of this email, you must neither take any action based upon its contents, nor copy or show it to anyone. Please contact the sender if you believe you have received this email in error, or if you do not wish to receive promotional emails from the Spitalfields Crypt Trust in future.

# Appendix 27



## Mohshin Ali

---

**From:** Finance Mailbox [REDACTED]  
**Sent:** 08 March 2018 22:36  
**To:** Mohshin Ali  
**Cc:** Georgina Stride  
**Subject:** Community appeal against licensing application for Di-Stephano -, 28 Hackney Road

Dear Mohshin Ali,

Please find below a letter opposing the application to license the new coffee shop opposite our church community hub.

I and many others strongly oppose permission for alcohol to be sold from these premises which is just a few metres from the entrance of the new Tab church & Tab Centre community hub.

As I am involved with the tab church project, I hope my voice will be heard on this matter.

Regards,

Sifa

Dear sir/madam,

I am writing on behalf of the local community to oppose the above licensing application. You will be receiving many other letters/emails also opposing this application. This cafe immediately adjacent to a community hub that includes a church faith community building, a homeless shelter & homeless luncheon club, a service for vulnerable young people excluded from school, services for young children and services for vulnerable young people with severe disabilities and special needs.

The availability of alcohol in this immediately adjacent location will be a risk of harm to children and the other vulnerable groups that are supported by the community hub. The community hub also includes a specialist hospital for people for HIV and AIDS and Again this will be immediately adjacent to the coffee shop.

Although we recognise that the applicant is seeking to minimise crime and disorder, risk to public safety, public nuisance and harm to children through various actions, we do not believe that this will be sufficient to avoid these issues from occurring due to the close proximity of the coffee shop to the community hub. In particular the vulnerable young people that have been excluded from main stream education can potentially be affected by the immediate availability of alcohol can also be affected by behaviour associated with alcohol consumption on occasions.

The community hub also provides a wide range of services for young children and families, including a parents & toddlers group, kids club, youth club and an arts activities group for all ages and a full range of disabilities.

Unfortunately, the area around the Tab Centre, which is highly residential in nature, already experiences an unacceptable level of anti-social behaviour and many members of the community are concerned this would only increase should another this licence be granted.

As a faith community we have no issue with alcohol at all in the right context and location. There has been a faith community in this site for 200 years, which as well as being a place of worship has always provided a full range of community activities. We are aware that the licensing committee is sensitive to this issue given the fantastic diversity of cultures and religions that we enjoy in Tower Hamlets.

We wish to make representations to the licensing committee and therefore wish to be informed with good notice as when this is likely to take place.

Yours sincerely,

Sifa Lobho

[Redacted]

[Redacted]

--  
Sifa Lobho  
Finance Officer  
Shoreditch Tabernacle Baptist Church

[Redacted]  
[Redacted]  
[Redacted]

# Appendix 28

## Mohshin Ali

---

**From:** Suzy Stride [REDACTED]  
**Sent:** 08 March 2018 17:01  
**To:** Mohshin Ali  
**Subject:** Community Appeal against licensing application - 28 Hackney Road

Dear Mohshin Ali,

### **Community Appeal against licensing application - [28 Hackney Road](#)**

I live and work in Tower Hamlets, I was born here and have worked in education in the area for over 10 years. I am very concerned about the matter below,

Please find below a letter opposing the application to license the new coffee shop opposite our church community hub.

I and many others strongly oppose permission for alcohol to be sold from these premises which is just a few metres from the entrance of the new Tab church & Tab Centre community hub.

Regards,

**Suzy Stride**

[REDACTED]  
Dear sir/madam,

I am writing on behalf of the local community to oppose the above licensing application. You will be receiving many other letters/emails also opposing this application. This cafe immediately adjacent to a community hub that includes a church faith community building, a homeless shelter & homeless luncheon club, a service for vulnerable young people excluded from school, services for young children and services for vulnerable young people with severe disabilities and special needs.

The availability of alcohol in this immediately adjacent location will be a risk of harm to children and the other vulnerable groups that are supported by the community hub. The community hub also includes a specialist hospital for people for HIV and AIDS and Again this will be immediately adjacent to the coffee shop.

Although we recognise that the applicant is seeking to minimise crime and disorder, risk to public safety, public nuisance and harm to children through various actions, we do not believe that this will be sufficient to avoid these issues from occurring due to the close proximity of the coffee shop to the community hub. In particular the vulnerable young people that have been excluded from main stream education can potentially be affected by the immediate availability of alcohol but as importantly they can also be affected by behaviour associated with alcohol consumption on occasions.

The community hub also provides a wide range of services for young children and families, including a parents & toddlers group, kids club, youth club and an arts activities group for all ages and a full range of disabilities.

Unfortunately, the area around the Tab Centre, which is highly residential in nature, already experiences an unacceptable level of anti-social behaviour and many members of the community are concerned this would only increase should another this licence be granted.

As a faith community we have no issue with alcohol at all in the right context and location. There has been a faith community in this site for 200 years, which as well as being a place of worship has always provided a full range of community activities. We are aware that the licensing committee is sensitive to this issue given the fantastic diversity of cultures and religions that we enjoy in Tower Hamlets.

We wish to make representations to the licensing committee and therefore wish to be informed with good notice as when this is likely to take place.

Yours sincerely,

Suzy

Suzy Stride



# Appendix 29

## Mohshin Ali

---

**From:** [REDACTED]  
**Sent:** 08 March 2018 19:53  
**To:** Mohshin Ali  
**Subject:** Community appeal against licensing application for Di-Stephano coffee shop, 28 Hackney Road

Dear sir.

I am writing on behalf of the local community to oppose the above licensing application. You will be receiving many other letters/emails also opposing this application.

This cafe is immediately adjacent to a community hub that includes a church faith community building, a homeless shelter & homeless luncheon club, a service for vulnerable young people excluded from school, services for young children and services for vulnerable young people with severe disabilities and special needs.

The availability of alcohol in this immediately adjacent location will be a risk of harm to children and the other vulnerable groups which are supported by the community hub. The community hub also includes a specialist hospital for people for HIV and AIDS and again this is immediately adjacent to the coffee shop.

Although we recognise that the applicant is seeking to minimise crime and disorder, risk to public safety, public nuisance and harm to children through various actions, we do not believe that this will be sufficient to avoid these issues from occurring due to the close proximity of the coffee shop to the community hub. In particular the vulnerable young people who have been excluded from mainstream education could be affected by the immediate availability of alcohol but as importantly they can also be affected by behaviour associated with alcohol consumption on occasions.

The community hub also provides a wide range of services for young children and families, including a parents & toddlers group, kids club, youth club and an arts activities group for all ages and a full range of disabilities.

Unfortunately, the area around the Tab Centre, which is highly residential in nature, already experiences an unacceptable level of anti-social behaviour and many members of the community are concerned that this would only increase should this licence be granted.

As a faith community we have no issue with alcohol at all in the right context and location. There has been a faith community on this site for 200 years, which as well as being a place of worship has always provided a full range of community activities. We are aware that the licensing committee is sensitive to this issue given the fantastic diversity of cultures and religions that we enjoy in Tower Hamlets.

We wish to make representations to the licensing committee and therefore wish to be informed with good notice as when this is likely to take place.

Yours sincerely,

Susan Tredinnick  
[REDACTED]  
[REDACTED]  
[REDACTED]

# Appendix 30



## Mohshin Ali

---

**From:** Val Pyper [REDACTED]  
**Sent:** 08 March 2018 18:14  
**To:** Mohshin Ali  
**Subject:** licence to sell alcohol

**Follow Up Flag:** Follow up  
**Flag Status:** Flagged

Dear sir/madam,

I am writing on behalf of the local community to oppose the above licensing application. You will be receiving many other letters/emails also opposing this application. This cafe immediately adjacent to a community hub that includes a church faith community building, a homeless shelter & homeless luncheon club, a service for vulnerable young people excluded from school, services for young children and services for vulnerable young people with severe disabilities and special needs.

The availability of alcohol in this immediately adjacent location will be a risk of harm to children and the other vulnerable groups that are supported by the community hub. The community hub also includes a specialist hospital for people for HIV and AIDS and Again this will be immediately adjacent to the coffee shop.

Although we recognise that the applicant is seeking to minimise crime and disorder, risk to public safety, public nuisance and harm to children through various actions, we do not believe that this will be sufficient to avoid these issues from occurring due to the close proximity of the coffee shop to the community hub. In particular the vulnerable young people that have been excluded from main stream education can potentially be affected by the immediate availability of alcohol but as importantly they can also be affected by behaviour associated with alcohol consumption on occasions.

The community hub also provides a wide range of services for young children and families, including a parents & toddlers group, kids club, youth club and an arts activities group for all ages and a full range of disabilities.

Unfortunately, the area around the Tab Centre, which is highly residential in nature, already experiences an unacceptable level of anti-social behaviour and many members of the community are concerned this would only increase should another this licence be granted.

As a faith community we have no issue with alcohol at all in the right context and location. There has been a faith community in this site for 200 years, which as well as being a place of worship has always provided a full range of community activities. We are aware that the licensing committee is sensitive to this issue given the fantastic diversity of cultures and religions that we enjoy in Tower Hamlets.

We wish to make representations to the licensing committee and therefore wish to be informed with good notice as when this is likely to take place.

Yours sincerely,

Rev'd Valerie Pyper

# Appendix 31

## Anti-Social Behaviour on the Premises

### Licensing Policy

The Licensing Authority expects the applicant to have addressed all crime and disorder issues relating to the premises in their operating schedule and to have sought appropriate advice. (**See Section 6 of the Licensing Policy**)

The Licensing Authority will consider attaching conditions to deter crime and disorder and these may include conditions drawn from the Model Poll of Conditions relating to Crime and Disorder. (**See Appendix 3 of the Licensing Policy**). In particular Members may wish to consider (this list is not exhaustive):

- Methods of management communication
- Use of registered Door Supervisors
- Bottle Bans
- Plastic containers
- CCTV
- Restrictions on open containers for “off sales”
- Restrictions on drinking areas
- Capacity
- Proof of Age scheme
- Crime prevention notices
- Drinks promotions-aimed at stopping irresponsible promotions
- Signage
- Seating plans
- Capacity

If Members believe that there is a substantial problem of anti-social behaviour and it cannot be proportionately addressed by licensing conditions they should refuse the application.

### Police Powers

The Licensing Act 2003, Part 8 gives a senior police officer the power to close a premises for up to 24 hours where the officer believes there is, or is likely to be disorder on or in the vicinity and closure is necessary in the interests of public safety.

### Guidance Issued under Section 182 of the Licensing Act 2003

The pool of conditions, adopted by the Council is recommended (Annexe D).

The key role of the Police and SIA is acknowledged (2.1-2.2).

Conditions attached to licences cannot seek to manage the behaviour of customers once they are beyond the direct management of the licence holder

and their staff or agents, but can directly impact on the behaviour of customers in the immediate vicinity of the premises as they seek entry or leave (1.16).

Conditions are best targeted on deterrence and preventing crime and disorder (2.3) communication, CCTV, police liaison, no glasses, capacity limits are all relevant (2.3 - 2.6).

The Guidance recognises working with Home Office Immigration Enforcement in the prevention of immigration crime. Licence conditions that are considered appropriate for the prevention of illegal working in licensed premises might include requiring a premises licence holder to undertake right to work checks on all staff employed at the licensed premises or requiring that a copy of any document checked as part of a right to work check are retained at the licensed premises.

#### Guidance Issued under Section 182 of the Licensing Act 2003

Conditions can be imposed for large capacity “vertical consumption” premises (10.23 – 10.24).

#### Guidance Issued by the Office of Fair Trading

This relates to attempts to control minimum prices.

#### Other Legislation

- The Council has a duty under Section 17 of the Crime and Disorder Act 1998 to do all it reasonably can to prevent crime and disorder

# Appendix 32

## **Anti-Social Behaviour from Patrons Leaving the Premises**

### General Advice

Members need to bear in mind that once patrons have left a premises they are no longer under direct control. Members will need to be satisfied that there is a link between the way the premises is operating and the behaviour that is complained of. An example of this would be that irresponsible drinking is being encouraged. Before deciding that any particular licensing conditions are proportionate, Members will also need to be satisfied that other legislation is not a more effective route. For example, if the problem is drinking in the street it may be that the Council should designate the area as a place where alcohol cannot be consumed in public.

Members may also wish to consider whether the hours of opening relate to any problems of anti-social behaviour.

If Members believe that there is a substantial problem of anti-social behaviour and it cannot be proportionately addressed by licensing conditions they should refuse the application.

### Licensing Policy

The policy recognises that other legislation or measures may be more appropriate but also states that licensing laws are “a key aspect of such control and will always be part of an overall approach to the management of the evening and night time economy” (**see Section 4.15 and 4.16 of the Licensing Policy**).

The Licensing Authority expects the applicant to have addressed all crime and disorder issues relating to the premises in their operating schedule and to have sought appropriate advice. (**See Sections 6.2 of the Licensing Policy**)

The Licensing Authority will consider attaching conditions to deter crime and disorder and these may include Conditions drawn from the Model Poll of Conditions relating to Crime and Disorder. (**See Appendix 3 of the Licensing Policy**). In particular Members may wish to consider (this list is not exhaustive):

- Bottle Bans
- Plastic containers
- CCTV (outside the premises)
- Restrictions on open containers for “off sales”
- Proof of Age scheme
- Crime prevention notices
- Drinks promotions-aimed at stopping irresponsible promotions
- Signage

## Cumulative Impact

There is a process by which the Licensing Authority can determine that an area is saturated following representations. However, the process for this involves wide consultation and cannot come from representations about a particular application. (**See Section 8 of the Licensing Policy**).

## Police Powers

The Licensing Act 2003, Part 8 gives a senior police officer the power to close a premises for up to 24 hours where the officer believes there is, or is likely to be disorder on or in the vicinity and closure is necessary in the interests of public.

## Guidance Issued under Section 182 of the Licensing Act 2003

The key role of the Police is acknowledged (2.1).

Conditions attached to licences cannot seek to manage the behaviour of customers once they are beyond the direct management of the licence holder, but can relate to the immediate vicinity of the premises as they seek entry or leave (1.16).

Conditions are best targeted on deterrence and preventing crime and disorder (2.3) CCTV inside & out, communication, police liaison, no glasses are all relevant

There is also guidance issued around public nuisance (2.15 – 2.21).

The pool of conditions, adopted by the Council is recommended (see Appendix 3 of the Licensing Policy). Licence conditions should not duplicate other legislation (1.16).

Necessary and appropriate conditions should normally focus on the most sensitive periods and may address disturbance as customers enter or leave the premises but it is essential that conditions are focused on measures within the direct control of the licence holder (2.18/2.21).

Licensing law is not the primary mechanism for the general control of nuisance and anti-social behaviour by individuals once they are away from the licensed premises and, therefore, beyond the direct control of the individual, club or business holding the licence, certificate or authorisation concerned (14.13).

## Other Legislation

### Crime and Disorder Act 1998

The Council has a duty under Section 17 of the Crime and Disorder Act 1998 to do all it reasonably can to prevent crime and disorder.

The Act also introduced a wide range of measures designed to address anti-social behaviour committed by adults and young people. These include:

- Anti-Social Behaviour Orders
- Child Curfew Schemes
- Truancy
- Parenting Orders
- Reparation Orders
- Tackling Racism



# Appendix 33

## **Acting as a Magnet Attracting the Young who then engage in Anti-Social Behaviour**

### General Advice

Members will need to consider whether any of the problems alleged to be associated with young people are the responsibility of the premises. Are they encouraging gangs in any way? If not, there may not be any proportionate conditions that can be applied? Are these patrons of the premises?

If Members believe that there is a substantial problem of anti-social behaviour and it cannot be proportionately addressed by licensing conditions they should refuse the application. However, hours may be an important issue.

### Licensing Policy

The policy recognises that other legislation or measures may be more appropriate (in relation to the behaviour of patrons who have left the premises) but also states that licensing laws are “a key aspect of such control and will always be part of an overall approach to the management of the evening and night time economy.” **(See Section 4.10 and 4.11 of the Licensing Policy).**

The Licensing Authority expects the applicant to have addressed all crime and disorder issues relating to the premises in their operating schedule and to have sought appropriate advice. **(See Sections 5.2 of the Licensing Policy)**

The Licensing Authority will consider attaching conditions to deter crime and disorder and these may include Conditions drawn from the Model Poll of Conditions relating to Crime and Disorder. **(See Appendix 2 Annex D of the Licensing Policy).** In particular Members may wish to consider (this list is not exhaustive):

- CCTV (outside the premises)
- Restrictions on open containers for “off sales”
- Proof of Age scheme
- Crime prevention notices
- Drinks promotions-aimed at stopping irresponsible promotions
- Signage

### Cumulative Impact

There is a process by which the Licensing Authority can determine that an area is saturated following representations. However the process for this involves wide consultation and cannot come from representations about a particular application. **(See Section 6 of the Licensing Policy).**

### Police Powers

The Licensing Act 2003, Part 8 gives a senior police officer the power to close a premises for up to 24 hours where the officer believes there is, or is likely to be disorder on or in the vicinity and closure is necessary in the interests of public.

#### Guidance Issued under Section 182 of the Licensing Act 2003

Conditions can be imposed for large capacity “vertical consumption” premises (10.23 – 10.24).

#### Other Legislation

##### Crime and Disorder Act 1998

The Council has a duty under Section 17 of the Crime and Disorder Act 1998 to do all it reasonably can to prevent crime and disorder.

##### Anti-Social Behaviour Act 2003

The Act also introduced a wide range of measures designed to address anti-social behaviour committed by adults and young people. These include:

- Anti-Social Behaviour Orders
- Child Curfew Schemes
- Truancy
- Parenting Orders
- Reparation Orders
- Tackling Racism

# Appendix 34

## **Planning**

An application for a Premises Licence can be made in respect of a premises even where the premises does not have relevant Planning Permission. That application has to be considered and Members can only refuse the application where the application itself does not promote one of more of the Licensing Objectives. Members cannot refuse just because there is no planning permission. Where a Premises Licence is granted and which exceeds what is allowed by the Planning Permission and that Premises then operates in breach of planning then the operator would be liable to enforcement by Planning.

# Appendix 35

### **Licensing Policy Relating to Hours of Trading**

All applications have to be considered on their own merits.

The Council has however adopted a set of framework hours as follows:

- Monday to Thursday, from 06:00 hrs to 23:30 hrs
- Friday and Saturday, from 06:00 hrs to 00:00 hrs (midnight)
- Sunday, from 06:00 hrs to 22:30 hrs

(see 15.8 of the Licensing Policy)

In considering the applicability of frame work hours to any particular application regard should be had to the following

- Location
- Proposed hours of regulated activities, and the proposed hours the premises are open to the public
- The adequacy of the applicant's proposals to deal with issues of crime and disorder and public nuisance
- Previous history
- Access to public transport
- Proximity to other licensed premises, and their hours

(See 15.9 of the licensing policy)

Subject to any representations to the contrary in individual cases the following premises are not generally considered to contribute to late night anti-social behaviour and will therefore generally have greater freedom

- Theatres
- Cinemas
- Premises with club premises certificates

This page is intentionally left blank



# Agenda Item 3.2

Committee : <b>Licensing Sub-Committee</b>	Date 04/04/18	Classification <b>Unclassified</b>	Report No.	Agenda Item No.
---	------------------	---------------------------------------	------------	-----------------

Report of: <b>David Tolley</b> <b>Head of Environmental Health &amp; Trading Standards</b>  Originating Officer: <b>Catrina Marshall</b> <b>Licensing Officer</b>	Title: <b>Licensing Act 2003</b> <b>Application for a Premises Licence for Travelodge London City, 20 Middlesex Street, London E1 7EX</b>  Ward affected: <b>Spitalfields and Banglatown</b>
--	--

## 1.0 Summary

Applicant: **Travelodge Hotels Limited**

Name and Address of Premises: **Travelodge London City**  
**20 Middlesex Street**  
**London**  
**E1 7EX**

Licence sought: **Licensing Act 2003 – premises licence**

- **The provision of late night refreshment**
- **The Sale of Alcohol**

Representations: **Residents**

## 2.0 Recommendations

2.1 That the Licensing Committee considers the application and representations then adjudicate accordingly.

**LOCAL GOVERNMENT 2000 (Section 97)**  
**LIST OF "BACKGROUND PAPERS" USED IN THE DRAFTING OF THIS REPORT**

Brief description of "background paper"	Tick if copy supplied for register	If not supplied, name and telephone number of holder
<ul style="list-style-type: none"> <li>• Guidance Issued under Section 182 of the Licensing Act 2003</li> <li>• Tower Hamlets Licensing Policy</li> <li>• File</li> </ul>	<input type="checkbox"/>	<b>Catrina Marshall</b> <b>020 7364 2665</b>

### 3.0 **Background**

- 3.1 This is an application for a premises licence for Travelodge London City, 20 Middlesex Street, London E1 7EX
- 3.2 The applicant has described the premises as follows:  
*“The premises will operate as a Travelodge hotel with a café bar located on the ground floor”.*
- 3.3 A copy of the premises licence application form is enclosed as **Appendix 1**.
- 3.4 The licensable activities and hours applied are as follows:-

#### **Sale of alcohol**

Monday to Sunday 24 hours a day\*

\*please note a condition has been offered that restricts alcohol beyond 11pm to bonafide guests only

#### **Late Night Refreshment**

Monday to Sunday from 23:00 hours to 05:00 hours (effectively 24 hours)

#### **Opening Hours:**

Monday to Sunday 24 hours a day

### 4.0 **Location and Nature of the premises**

- 4.1 Photographs of the venue and immediate vicinity will be provided at the hearing.
- 4.2 The site plan of the venue is included as **Appendix 2**.
- 4.3 Maps showing the vicinity are included as **Appendix 3**.
- 4.4 Details of the nearest licensed venues are included as **Appendix 4**.

### 5.0 **Licensing Policy and Government Advice**

- 5.1 The Council has adopted a licensing policy and this is available from the Licensing Section, and at the hearing. The revised policy came into effect on the 1<sup>st</sup> November 2013.
- 5.2 Relevant Sections of the policy are brought to the attention of Members within the Licensing Officers report.
- 5.3 The Home Secretary has issued Guidance under Section 182 of the Licensing Act 2003. This is available on the Government’s website, [www.homeoffice.gov.uk](http://www.homeoffice.gov.uk). It was last revised in April 2017.

5.4 Relevant Sections of this advice are brought to Members attention within the Licensing Officers report. Members should note however, than in some areas Tower Hamlets, after a proper consideration of local circumstances, has not followed the Government's advice, or has developed it further.

## 6.0 Representations

6.1 All representations have to meet basic legal and administrative requirements. If they fail to do so they cannot be accepted. When rejected the person sending in the representation must be written to, and an explanation for rejection given in writing

6.2 A responsible authority or other person can make a representation. There are two tests for other persons and only one for a responsible authority. The two tests are contained in Section 18 of the Act.

6.3 All representations must be "about the likely effect of the grant of the premises licence on the promotion of the licensing objectives." Likely means something that will probably happen, i.e. on balance more likely than not.

6.4 Representations by responsible authorities do not have to meet the second test of not being vexatious and frivolous. Other persons have to meet this test.

6.5 The Home Office recommends that in borderline cases, the benefit of the doubt should be given to the interested party making the representation.

6.6 Section 182 Advice by the Home Office concerning relevant, vexatious and frivolous representations is attached as **Appendix 5**.

6.7 All the representations in this report have been considered by the relevant officer (Team Leader Licensing & Safety) and determined to have met the requirements of the Licensing Act 2003.

6.8 This hearing is required by the Licensing Act 2003, because relevant representation has been made by local residents;  
Please see **Appendix 6 for Mr. Shapiro**  
**Appendix 7 for Mr. Tyler**

6.9 All of the responsible authorities have been consulted about this application. They are as follows:

- The Licensing Authority
- The Metropolitan Police
- The LFEPA (the London Fire and Emergency Planning Authority).
- Planning
- Health and Safety
- Noise (Environmental Health)

- Trading Standards
- Child Protection
- Public Health
- Home Secretary (Home Office Immigration Enforcement)

6.10 In addition the application was required to be advertised in a local newspaper and by a blue poster. Only representations that relate to the following licensing objectives are relevant:

- the prevention of crime and disorder
- public safety
- the prevention of public nuisance
- the protection of children from harm

6.11 Essentially, the relevant parties oppose the application because in their opinion, the applicant has not explained how within the context of the application they will meet licensing objective of the prevention of public nuisance and the prevention of crime and disorder.

6.12 There are strict time limits to any representations. The time limits are contained in The Licensing Act 2003 (Premises licences and club premises certificates) Regulations 2005.

6.13 The applicant has offered measures in the operating schedule of the application that address the promotion of the Licensing Objectives. If there were no representations, the Licensing Authority would grant the licence, with conditions consistent with the operating schedule, which are relevant, proportionate and enforceable. Members are asked to consider the schedule and incorporate any conditions as necessary to address the licensing objectives.

## **7.0 Conditions consistent with Operating Schedule**

7.1 A colour digital CCTV system will be installed and maintained to the satisfaction of the Police and Licensing Authority. Recordings from the installed CCTV are to be kept for 31 days, these recordings shall be immediately available for inspection and viewing on the premises by Police and/or licensing Authority officers on request.

7.2 Hard copy recordings of CCTV footage in a playable format must be provided to Police and/or Licensing Authority Officers within 48 hours of their request.

7.3 The premises must ensure the CCTV system is operating and recording 24 hours every day (save for the purpose of maintenance).

7.4 The licence holder will ensure all members of staff are trained in the requirements of the Licensing Act and other relevant legislation.

- 7.5 Between the hours of 23:00 and 10:00 hours the sale of alcohol will be restricted to hotel residents and bona fide guests of hotel residents.
- 7.6 After 23:00 hours access to the hotel is restricted to residents with key card.
- 7.7 Notices shall be prominently displayed near all exits from the premises asking patrons to leave quietly with consideration for neighbours.
- 7.8 The emptying of bottles into outside bins will be restricted to the hours of 08:00 hours to 22:30 hours.
- 7.9 Persons under 16 years of age will be accompanied by an adult in the area where licensable activities take place.

## 8.0 **Conditions in consultation with the Responsible Authorities**

- 8.1 Trading Standards have agreed the following;

A Challenge 25 proof of age scheme shall be operated at the premises where the only acceptable forms of identification are recognised photographic identification cards, such as a driving licence, passport or proof of age card with the PASS Hologram.

## 9.0 **Licensing Officer Comments**

- 9.1 The following is intended simply to advise Members of the relevant aspects of the Boroughs Licensing Policy, guidance from the Secretary of State, legislation and good practice. Members may depart from the Council's Licensing Policy and/or Government advice, provide they consider it appropriate to do so, and have clear reasons for their decision.

## 9.2 Guidance issued under section 182 of the Licensing Act 2003

- ❖ As stated in the guidance it is "provided to licensing authorities in relation to the carrying out of their functions under the 2003 Act." It is a key medium for promoting best practice, ensuring consistent application and promoting fairness equal treatment and proportionality (1.7).

- ❖ Also “as long as licensing authorities have properly understood this Guidance, they may depart from it if they have good reason to do so and can provide full reasons. Departure from this Guidance could give rise to an appeal or judicial review, and the reasons given will then be a key consideration for the courts when considering the lawfulness and merits of any decision taken.” Therefore licensing authorities will need to give full reasons for their actions (1.9).
  - ❖ Also Members should note “A Licensing Authority may depart from its own policy if the individual circumstances of any case merit such a decision in the interests of the promotion of the licensing objectives.” (1.12)
  - ❖ Also, “The licensing authority may not impose any conditions unless its discretion has been exercised following receipt of relevant representations and it is satisfied as a result of a hearing (unless all parties agree a hearing is not necessary) that it is appropriate to impose conditions to promote one or more of the four licensing objectives.” Therefore, conditions may not be imposed for the purpose other than promoting the licensing objectives and in some cases no additional conditions will be appropriate. (10.8)
  - ❖ Necessary conditions should emerge from a risk assessment by the applicant, which should then be reflected in the operating schedule (10.4).
  - ❖ The Guidance states: “Where there are objections to an application to extend the hours during which licensable activities are to be carried on and the licensing authority determines that this would undermine the licensing objectives, it may reject the application or grant it with appropriate conditions and/or different hours from those requested.” (10.14)
  - ❖ Mandatory conditions must be imposed (10.25) and censorship avoided (10.17).
  - ❖ The Guidance states: “It is still permitted to sell alcohol using promotions (as long as they are compatible with any other licensing condition that may be in force), and the relevant person should ensure that the price of the alcohol is not less than the permitted price. Detailed guidance on the use of promotions is given in the guidance document available on the Gov.uk website.” (10.58) Also, “Licensing authorities should not attach standardised blanket conditions promoting fixed prices for alcoholic drinks to premises licences or club licences or club premises certificates in an area.” (10.21)
- 9.3 The Licensing Act 2003 permits children of any age to be on the premises which primarily sells alcohol providing they are accompanied by an adult. It is not necessary to make this a condition.

- 9.4 In all cases the Members should make their decision on the civil burden of proof, that is “the balance of probability.”
- 9.5 In all cases Members should consider whether or not primary legislation is the appropriate method of regulation and should only consider licence conditions when the circumstances in their view are not already adequately covered elsewhere.
- 9.6 The Government has advised that conditions must be tailored to the individual type, location and characteristics of the premises and events concerned. Conditions cannot seek to manage the behaviour of customers once they are beyond the direct management of the licence holder and their staff and standardised conditions should be avoided where they cannot be shown to be appropriate. (1.16/1.17)
- 9.7 The Council’s Licensing Policy generally expects applicants to address the licensing objectives and discuss how to do this with the relevant responsible authorities.
- 9.8 In **Appendices 8- 11** Members are given general advice, and also have explanations of the Council’s Licensing Policy, Government advice and other legislation relating to the matters previously identified.

#### 10.0 **Legal Comments**

10.1 The Council’s legal officer will give advice at the hearing.

#### 11.0 **Finance Comments**

11.1 There are no financial implications in this report.

#### 12.0 **Appendices**

<b>Appendix 1</b>	A copy of the application
<b>Appendix 2</b>	Site Plan
<b>Appendix 3</b>	Maps of the surrounding area
<b>Appendix 4</b>	Other licensed venues in the area
<b>Appendix 5</b>	Section 182 Guidance by the Home Office
<b>Appendix 6</b>	Representation from Mr. Shapiro
<b>Appendix 7</b>	Representation from Mr. Tyler
<b>Appendix 8</b>	Licensing Officer comments on ASB from patrons leaving the premises

<b>Appendix 9</b>	Licensing Policy on CIZ
<b>Appendix 10</b>	Planning
<b>Appendix 11</b>	Licensing Policy relating to hours of trading



# Appendix 1

**Application for a premises licence to be granted  
under the Licensing Act 2003**

**PLEASE READ THE FOLLOWING INSTRUCTIONS FIRST**

Before completing this form please read the guidance notes at the end of the form. If you are completing this form by hand please write legibly in block capitals. In all cases ensure that your answers are inside the boxes and written in black ink. Use additional sheets if necessary.

You may wish to keep a copy of the completed form for your records.

I/We Travelodge Hotels Limited

*(Insert name(s) of applicant)*

apply for a premises licence under section 17 of the Licensing Act 2003 for the premises described in Part 1 below (the premises) and I/we are making this application to you as the relevant licensing authority in accordance with section 12 of the Licensing Act 2003

**Part 1 – Premises Details**

Postal address of premises or, if none, ordnance survey map reference or description			
Travelodge London City 20 Middlesex Street			
Post town	London	Postcode	E1 7EX

Telephone number at premises (if any)	
Non-domestic rateable value of premises	£ not yet rated

**Part 2 - Applicant Details**

Please state whether you are applying for a premises licence as

Please tick as appropriate

- a) an individual or individuals \*  please complete section (A)
- b) a person other than an individual \*
  - i. as a limited company  please complete section (B)
  - ii. as a partnership  please complete section (B)
  - iii. as an unincorporated association or  please complete section (B)
  - iv. other (for example a statutory corporation)  please complete section (B)
- c) a recognised club  please complete section (B)

TRADING STANDARDS

26 JAN 2018

LICENSING

- d) a charity  please complete section (B)
- e) the proprietor of an educational establishment  please complete section (B)
- f) a health service body  please complete section (B)
- g) a person who is registered under Part 2 of the Care Standards Act 2000 (c14) in respect of an independent hospital in Wales  please complete section (B)
- ga) a person who is registered under Chapter 2 of Part 1 of the Health and Social Care Act 2008 (within the meaning of that Part) in an independent hospital in England  please complete section (B)
- h) the chief officer of police of a police force in England and Wales  please complete section (B)

\* If you are applying as a person described in (a) or (b) please confirm:

Please tick yes

I am carrying on or proposing to carry on a business which involves the use of the premises for licensable activities; or

I am making the application pursuant to a  
 statutory function or   
 a function discharged by virtue of Her Majesty's prerogative

**(A) INDIVIDUAL APPLICANTS (fill in as applicable)**

Mr <input type="checkbox"/>	Mrs <input type="checkbox"/>	Miss <input type="checkbox"/>	Ms <input type="checkbox"/>	Other Title (for example, Rev)	
Surname			First names		
I am 18 years old or over				<input type="checkbox"/>	Please tick yes
Current postal address if different from premises address					
Post town		Postcode			
Daytime contact telephone number					
E-mail address (optional)					

**SECOND INDIVIDUAL APPLICANT (if applicable)**

Mr <input type="checkbox"/>	Mrs <input type="checkbox"/>	Miss <input type="checkbox"/>	Ms <input type="checkbox"/>	Other Title (for example, Rev)	
Surname			First names		
I am 18 years old or over					<input type="checkbox"/> Please tick yes
Current postal address if different from premises address					
Post town		Postcode			
Daytime contact telephone number					
E-mail address (optional)					

**(B) OTHER APPLICANTS**

Please provide name and registered address of applicant in full. Where appropriate please give any registered number. In the case of a partnership or other joint venture (other than a body corporate), please give the name and address of each party concerned.

Name Travelodge Hotels Limited
Address Sleepy Hollow Aylesbury Road Thame Oxon OX9 3AT
Registered number (where applicable) 00769170
Description of applicant (for example, partnership, company, unincorporated association etc.) Limited Company
Telephone number (if any)
E-mail address (optional)

### Part 3 Operating Schedule

When do you want the premises licence to start?    ASAP

DD	MM	YYYY

If you wish the licence to be valid only for a limited period, when do you want it to end?

DD	MM	YYYY

Please give a general description of the premises (please read guidance note 1)

The premises will operate as a Travelodge hotel with a café bar located on the ground floor.

The hotel will be open 24 hours a day. Between the hours of 23:00 and 10:00 the sale of alcohol will be restricted to hotel residents and bona fide guests of hotel residents.

If 5,000 or more people are expected to attend the premises at any one time, please state the number expected to attend.

N/A
-----

What licensable activities do you intend to carry on from the premises?

(Please see sections 1 and 14 of the Licensing Act 2003 and Schedules 1 and 2 to the Licensing Act 2003)

Provision of regulated entertainment

Please tick any that apply

- a) plays (if ticking yes, fill in box A)
- b) films (if ticking yes, fill in box B)
- c) indoor sporting events (if ticking yes, fill in box C)
- d) boxing or wrestling entertainment (if ticking yes, fill in box D)
- e) live music (if ticking yes, fill in box E)
- f) recorded music (if ticking yes, fill in box F)
- g) performances of dance (if ticking yes, fill in box G)
- h) anything of a similar description to that falling within (e), (f) or (g) (if ticking yes, fill in box H)

Provision of late night refreshment (if ticking yes, fill in box I)

Supply of alcohol (if ticking yes, fill in box J)

In all cases complete boxes K, L and M

**A**

<b>Plays</b> Standard days and timings (please read guidance note 6)			<b><u>Will the performance of a play take place indoors or outdoors or both – please tick</u></b> (please read guidance note 2)		Indoors	<input type="checkbox"/>
					Outdoors	<input type="checkbox"/>
Day	Start	Finish			Both	<input type="checkbox"/>
Mon			<b><u>Please give further details here</u></b> (please read guidance note 3)			
Tue			<b><u>State any seasonal variations for performing plays</u></b> (please read guidance note 4)			
Wed			<b><u>Non standard timings. Where you intend to use the premises for the performance of plays at different times to those listed in the column on the left, please list</u></b> (please read guidance note 5)			
Thur						
Fri						
Sat						
Sun						

**B**

<b>Films</b> Standard days and timings (please read guidance note 6)			<b><u>Will the exhibition of films take place indoors or outdoors or both – please tick</u></b> (please read guidance note 2)		Indoors	<input type="checkbox"/>
					Outdoors	<input type="checkbox"/>
Day	Start	Finish			Both	<input type="checkbox"/>
Mon			<b><u>Please give further details here</u></b> (please read guidance note 3)			
Tue			<b><u>State any seasonal variations for the exhibition of films</u></b> (please read guidance note 4)			
Wed						
Thur						

			<p><b>Non standard timings. Where you intend to use the premises for the exhibition of films at different times to those listed in the column on the left, please list</b> (please read guidance note 5)</p>
Fri			
Sat			
Sun			

C

<p><b>Indoor sporting events</b> Standard days and timings (please read guidance note 6)</p>			<p><b>Please give further details</b> (please read guidance note 3)</p>
Day	Start	Finish	<p><b>State any seasonal variations for indoor sporting events</b> (please read guidance note 4)</p>
Mon			
Tue			
Wed			
Thur			<p><b>Non standard timings. Where you intend to use the premises for indoor sporting events at different times to those listed in the column on the left, please list</b> (please read guidance note 5)</p>
Fri			
Sat			
Sun			

**D**

<b>Boxing or wrestling entertainments</b> Standard days and timings (please read guidance note 6)			<b>Will the boxing or wrestling entertainment take place indoors or outdoors or both – please tick</b> (please read guidance note 2)	Indoors	<input type="checkbox"/>
				Outdoors	<input type="checkbox"/>
				Both	<input type="checkbox"/>
Day	Start	Finish	<b>Please give further details here</b> (please read guidance note 3)		
Mon					
Tue					
Wed					
Thur					
Fri					
Sat					
Sun					
			<b>State any seasonal variations for boxing or wrestling entertainment</b> (please read guidance note 4)		
			<b>Non standard timings. Where you intend to use the premises for boxing or wrestling entertainment at different times to those listed in the column on the left, please list</b> (please read guidance note 5)		

**E**

<b>Live music</b> Standard days and timings (please read guidance note 6)			<b>Will the performance of live music take place indoors or outdoors or both – please tick</b> (please read guidance note 2)	Indoors	<input type="checkbox"/>			
				Outdoors	<input type="checkbox"/>			
				Both	<input type="checkbox"/>			
Day	Start	Finish	<b>Please give further details here</b> (please read guidance note 3)					
Mon								
Tue								
Wed								
						<b>State any seasonal variations for the performance of live music</b> (please read guidance note 4)		



Thur			<p><b><u>Non standard timings. Where you intend to use the premises for the performance of live music at different times to those listed in the column on the left, please list</u></b> (please read guidance note 5)</p>
Fri			
Sat			
Sun			

**F**

<p><b>Recorded music</b> Standard days and timings (please read guidance note 6)</p>			<p><b><u>Will the playing of recorded music take place indoors or outdoors or both – please tick</u></b> (please read guidance note 2)</p>	<p>Indoors <input type="checkbox"/></p>
Day	Start	Finish		<p>Outdoors <input type="checkbox"/></p>
				<p>Both <input type="checkbox"/></p>
Mon			<p><b><u>Please give further details here</u></b> (please read guidance note 3)</p>	
Tue				
Wed			<p><b><u>State any seasonal variations for the playing of recorded music</u></b> (please read guidance note 4)</p>	
Thur				
Fri			<p><b><u>Non standard timings. Where you intend to use the premises for the playing of recorded music at different times to those listed in the column on the left, please list</u></b> (please read guidance note 5)</p>	
Sat				
Sun				

# G

<b>Performances of dance</b> Standard days and timings (please read guidance note 6)			<b>Will the performance of dance take place indoors or outdoors or both – please tick</b> (please read guidance note 2)		Indoors	<input type="checkbox"/>
					Outdoors	<input type="checkbox"/>
					Both	<input type="checkbox"/>
Day	Start	Finish				
Mon			<b>Please give further details here</b> (please read guidance note 3)			
Tue						
Wed			<b>State any seasonal variations for the performance of dance</b> (please read guidance note 4)			
Thur						
Fri			<b>Non standard timings. Where you intend to use the premises for the performance of dance at different times to those listed in the column on the left, please list</b> (please read guidance note 5)			
Sat						
Sun						

# H

<b>Anything of a similar description to that falling within (e), (f) or (g)</b> Standard days and timings (please read guidance note 6)			Please give a description of the type of entertainment you will be providing			
Day	Start	Finish	<b>Will this entertainment take place indoors or outdoors or both – please tick</b> (please read guidance note 2)		Indoors	<input type="checkbox"/>
Mon					Outdoors	<input type="checkbox"/>
					Both	<input type="checkbox"/>
Tue			<b>Please give further details here</b> (please read guidance note 3)			
Wed						

Thur			<b><u>State any seasonal variations for entertainment of a similar description to that falling within (e), (f) or (g) (please read guidance note 4)</u></b>
Fri			
Sat			<b><u>Non standard timings. Where you intend to use the premises for the entertainment of a similar description to that falling within (e), (f) or (g) at different times to those listed in the column on the left, please list (please read guidance note 5)</u></b>
Sun			

**I**

<b>Late night refreshment</b> Standard days and timings (please read guidance note 6)			<b>Will the provision of late night refreshment take place indoors or outdoors or both – please tick</b> (please read guidance note 2)	Indoors	<input checked="" type="checkbox"/>
				Outdoors	<input type="checkbox"/>
				Both	<input type="checkbox"/>
Day	Start	Finish			
Mon	23:00	05:00	<b><u>Please give further details here</u></b> (please read guidance note 3) Provision of hot food and drinks		
Tue	23:00	05:00			
Wed	23:00	05:00	<b><u>State any seasonal variations for the provision of late night refreshment</u></b> (please read guidance note 4)		
Thur	23:00	05:00			
Fri	23:00	05:00	<b><u>Non standard timings. Where you intend to use the premises for the provision of late night refreshment at different times, to those listed in the column on the left, please list</u></b> (please read guidance note 5)		
Sat	23:00	05:00			
Sun	23:00	05:00			

**J**

<b>Supply of alcohol</b> Standard days and timings (please read guidance note 6)			<b>Will the supply of alcohol be for consumption – please tick</b> (please read guidance note 7)	On the premises	<input type="checkbox"/>
				Off the premises	<input type="checkbox"/>
				Both	<input checked="" type="checkbox"/>
<b>Day</b>	<b>Start</b>	<b>Finish</b>	<b>State any seasonal variations for the supply of alcohol</b> (please read guidance note 4)		
Mon	00:00	24:00			
	24	hours			
Tue	00:00	24:00			
	24	hours			
Wed	00:00	24:00			
	24	hours			
Thur	00:00	24:00			
	24	hours			
Fri	00:00	24:00			
	24	hours			
Sat	00:00	24:00			
	24	hours			
Sun	00:00	24:00			
	24	hours			
			<b>Non standard timings. Where you intend to use the premises for the supply of alcohol at different times to those listed in the column on the left, please list</b> (please read guidance note 5)		

**State the name and details of the individual whom you wish to specify on the licence as designated premises supervisor:**

<b>Name</b> Niki Keith Edward Brightman	
<b>Date of Birth</b>	[REDACTED]
<b>Address</b> [REDACTED]	
<b>Postcode</b>	[REDACTED]
<b>Personal licence number (if known)</b> [REDACTED]	
<b>Issuing licensing authority (if known)</b> Aylesbury Vale District Council	

K

Please highlight any adult entertainment or services, activities, other entertainment or matters ancillary to the use of the premises that may give rise to concern in respect of children (please read guidance note 8).

N/A

L

Hours premises are open to the public Standard days and timings (please read guidance note 6)			State any seasonal variations (please read guidance note 4)
Day	Start	Finish	
Mon	00:00	24:00	<p><b>Non standard timings. Where you intend the premises to be open to the public at different times from those listed in the column on the left, please list</b> (please read guidance note 5)</p>
	24	hours	
Tue	00:00	24:00	
	24	hours	
Wed	00:00	24:00	
	24	hours	
Thur	00:00	24:00	
	24	hours	
Fri	00:00	24:00	
	24	hours	
Sat	00:00	24:00	
	24	hours	
Sun	00:00	24:00	
	24	hours	

**M** Describe the steps you intend to take to promote the four licensing objectives:

**a) General – all four licensing objectives (b, c, d and e) (please read guidance note 9)**

Please see b), d) and e) below.

**b) The prevention of crime and disorder**

1. A colour digital CCTV system will be installed and maintained to the satisfaction of the Police and licensing authority. Recordings from the installed CCTV are to be kept for 31 days. These recordings shall be immediately available for inspection and viewing on the premises by Police and/or licensing authority officers on request.
2. Hard copy recordings of CCTV footage in a playable format must be provided to Police and/or licensing authority officers within 48 hours of their request.
3. The premises must ensure the CCTV system is operating and recording 24 hours every day (save for the purpose of maintenance).
4. The licence holder will ensure all members of staff are trained in the requirements of the Licensing Act and other relevant legislation.
5. The premises licence holder will adopt a Challenge 21 scheme at the premises and display appropriate notices advising the scheme is in place at the hotel.
6. Between the hours of 23:00 to 10:00 hours the sale of alcohol will be restricted to hotel residents and bona fide guests of hotel residents.
7. After 23.00 access to the hotel is restricted to residents with a key card.

**c) Public safety**

Please see (b) above and (e) below.

**d) The prevention of public nuisance**

8. Notices shall be prominently displayed near all exits from the premises asking patrons to leave quietly with consideration for neighbours.
9. The emptying of bottles into outside bins will be restricted to the hours of 08:00 to 22:30 hours.

**e) The protection of children from harm**

10. Persons under 16 years of age will be accompanied by an adult in the area where licensable activities take place.

**Checklist:**

Please tick to indicate agreement

- I have made or enclosed payment of the fee.
- I have enclosed the plan of the premises.
- I have sent copies of this application and the plan to responsible authorities and others where applicable.
- I have enclosed the consent form completed by the individual I wish to be designated premises supervisor, if applicable.
- I understand that I must now advertise my application.
- I understand that if I do not comply with the above requirements my application will be rejected.
- [Applicable to all individual applicants, including those in a partnership which is not a limited liability partnership, but not companies or limited liability partnerships] I have included documents demonstrating my entitlement to work in the United Kingdom (please read note 15).

**IT IS AN OFFENCE, UNDER SECTION 158 OF THE LICENSING ACT 2003, TO MAKE A FALSE STATEMENT IN OR IN CONNECTION WITH THIS APPLICATION. THOSE WHO MAKE A FALSE STATEMENT MAY BE LIABLE ON SUMMARY CONVICTION TO A FINE OF ANY AMOUNT.**

**IT IS AN OFFENCE UNDER SECTION 24B OF THE IMMIGRATION ACT 1971 FOR A PERSON TO WORK WHEN THEY KNOW, OR HAVE REASONABLE CAUSE TO BELIEVE, THAT THEY ARE DISQUALIFIED FROM DOING SO BY REASON OF THEIR IMMIGRATION STATUS. THOSE WHO EMPLOY AN ADULT WITHOUT LEAVE OR WHO**

IS SUBJECT TO CONDITIONS AS TO EMPLOYMENT WILL BE LIABLE TO A CIVIL PENALTY UNDER SECTION 15 OF THE IMMIGRATION, ASYLUM AND NATIONALITY ACT 2006 AND PURSUANT TO SECTION 21 OF THE SAME ACT, WILL BE COMMITTING AN OFFENCE WHERE THEY DO SO IN THE KNOWLEDGE, OR WITH REASONABLE CAUSE TO BELIEVE, THAT THE EMPLOYEE IS DISQUALIFIED.

**Part 4 – Signatures** (please read guidance note 10)

**Signature of applicant or applicant’s solicitor or other duly authorised agent** (see guidance note 11).  
**If signing on behalf of the applicant, please state in what capacity.**

<b>Declaration</b>	<ul style="list-style-type: none"> <li>[Applicable to individual applicants only, including those in a partnership which is not a limited liability partnership] I understand I am not entitled to be issued with a licence if I do not have the entitlement to live and work in the UK (or if I am subject to a condition preventing me from doing work relating to the carrying on of a licensable activity) and that my licence will become invalid if I cease to be entitled to live and work in the UK (please read guidance note 15)</li> <li>The DPS named in this application form is entitled to work in the UK (and is not subject to conditions preventing him or her from doing work relating to a licensable activity) and I have seen a copy of his or her proof of entitlement to work, if appropriate (please see note 15)</li> </ul>
<b>Signature</b>	[REDACTED]
<b>Date</b>	25 January 2018
<b>Capacity</b>	Woods Whur 2014 Limited - Solicitors for the Applicant

**For joint applications, signature of 2<sup>nd</sup> applicant or 2<sup>nd</sup> applicant’s solicitor or other authorised agent** (please read guidance note 12). **If signing on behalf of the applicant, please state in what capacity.**

<b>Signature</b>	
<b>Date</b>	
<b>Capacity</b>	

<b>Contact name (where not previously given) and postal address for correspondence associated with this application</b> (please read guidance note 13)			
Carole Collingwood Woods Whur 2014 Limited Devonshire House 38 York Place			
<b>Post town</b>	Leeds	<b>Postcode</b>	LS1 2ED
<b>Telephone number (if any)</b>	[REDACTED]		
<b>If you would prefer us to correspond with you by e-mail, your e-mail address (optional)</b>			
[REDACTED]			



# Appendix 2

GENERAL ARRANGEMENT

- 1.000
- 1.001
- 1.002
- 1.003
- 1.004
- 1.005
- 1.006
- 1.007
- 1.008
- 1.009
- 1.010
- 1.011
- 1.012
- 1.013
- 1.014
- 1.015
- 1.016
- 1.017
- 1.018
- 1.019
- 1.020
- 1.021
- 1.022
- 1.023
- 1.024
- 1.025
- 1.026
- 1.027
- 1.028
- 1.029
- 1.030
- 1.031
- 1.032
- 1.033
- 1.034
- 1.035
- 1.036
- 1.037
- 1.038
- 1.039
- 1.040
- 1.041
- 1.042
- 1.043
- 1.044
- 1.045
- 1.046
- 1.047
- 1.048
- 1.049
- 1.050
- 1.051
- 1.052
- 1.053
- 1.054
- 1.055
- 1.056
- 1.057
- 1.058
- 1.059
- 1.060
- 1.061
- 1.062
- 1.063
- 1.064
- 1.065
- 1.066
- 1.067
- 1.068
- 1.069
- 1.070
- 1.071
- 1.072
- 1.073
- 1.074
- 1.075
- 1.076
- 1.077
- 1.078
- 1.079
- 1.080
- 1.081
- 1.082
- 1.083
- 1.084
- 1.085
- 1.086
- 1.087
- 1.088
- 1.089
- 1.090
- 1.091
- 1.092
- 1.093
- 1.094
- 1.095
- 1.096
- 1.097
- 1.098
- 1.099
- 1.100
- 1.101
- 1.102
- 1.103
- 1.104
- 1.105
- 1.106
- 1.107
- 1.108
- 1.109
- 1.110
- 1.111
- 1.112
- 1.113
- 1.114
- 1.115
- 1.116
- 1.117
- 1.118
- 1.119
- 1.120
- 1.121
- 1.122
- 1.123
- 1.124
- 1.125
- 1.126
- 1.127
- 1.128
- 1.129
- 1.130
- 1.131
- 1.132
- 1.133
- 1.134
- 1.135
- 1.136
- 1.137
- 1.138
- 1.139
- 1.140
- 1.141
- 1.142
- 1.143
- 1.144
- 1.145
- 1.146
- 1.147
- 1.148
- 1.149
- 1.150
- 1.151
- 1.152
- 1.153
- 1.154
- 1.155
- 1.156
- 1.157
- 1.158
- 1.159
- 1.160
- 1.161
- 1.162
- 1.163
- 1.164
- 1.165
- 1.166
- 1.167
- 1.168
- 1.169
- 1.170
- 1.171
- 1.172
- 1.173
- 1.174
- 1.175
- 1.176
- 1.177
- 1.178
- 1.179
- 1.180
- 1.181
- 1.182
- 1.183
- 1.184
- 1.185
- 1.186
- 1.187
- 1.188
- 1.189
- 1.190
- 1.191
- 1.192
- 1.193
- 1.194
- 1.195
- 1.196
- 1.197
- 1.198
- 1.199
- 1.200

LBTH  
TRADING STANDARDS  
26 JAN 2018  
LICENSING

ISA  
INFORMATION  
1527 (LIC) 001  
TRADING STANDARDS  
26 JAN 2018  
LICENSING DRAWING

DRAWN: DATE: SCALE: CHECKED: DATE: SCALE: CHECKED: DATE: SCALE: CHECKED: DATE: SCALE: CHECKED:

GOULSTON STREET



MIDDLESEX STREET

MIDDLESEX STRE-

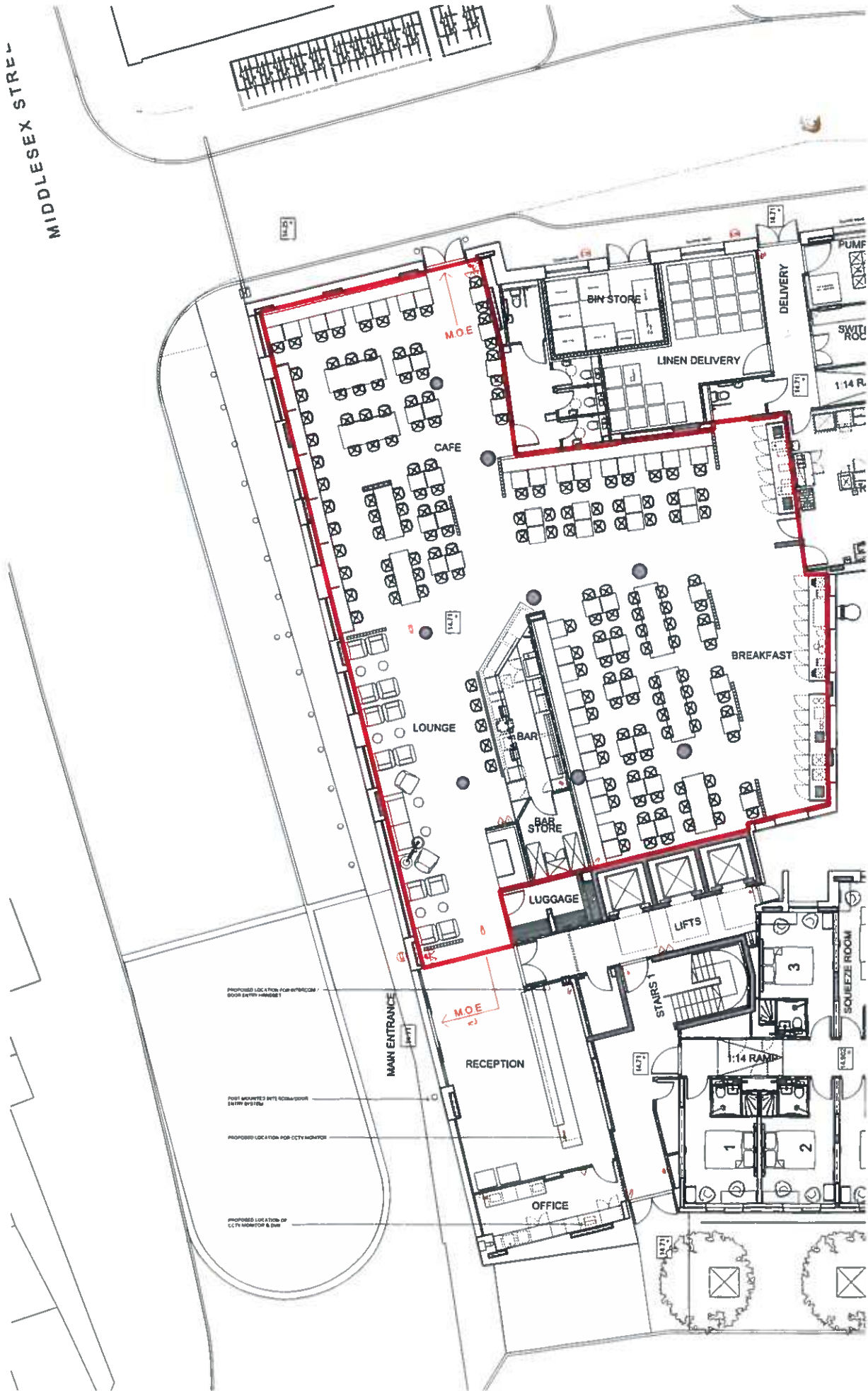

**GENERAL ARRANGEMENT**

- FIRE ALARM CALL POINT (SMALL BLASS - 100MM APX TO CP/PS)
- ▲ Exit of Fire/Smoke
- ▲ MET (METERS) IN TERRAZZO
- ▲ FIRE ALARM/ST
- ▲ FLOOR IS PROTECTED
- EVACUATION AREA TO BE USED FOR EMERGENCY ACTIVITIES
- FLOOR CCTV CAMERA
- FLOOR CCTV CAMERA WITH FACIAL RECOGNITION
- DIFFERENTIAL DOME CCTV CAMERA
- CAMERA OF ESCAPE

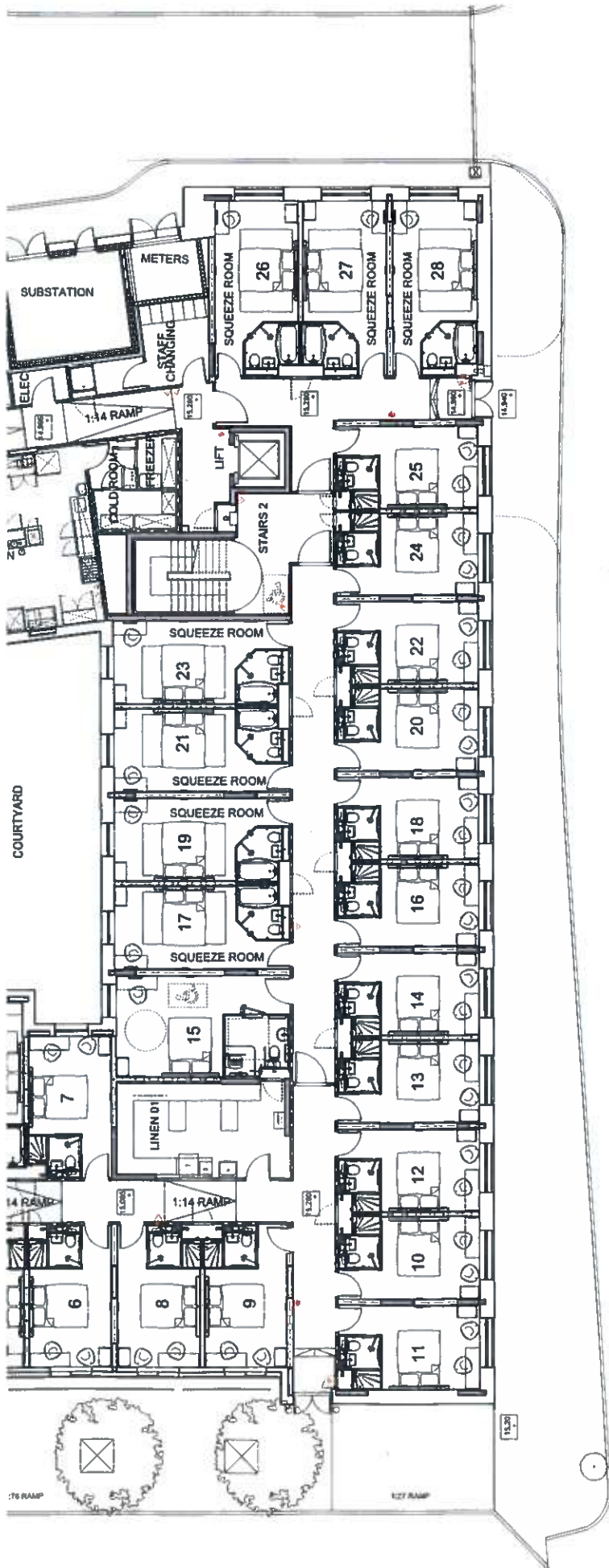

GOULSTON STREET

**LBTH**  
**TRADING STANDARDS**  
 26 JAN 2018  
**LICENSING**



**ISA**

**INFORMATION**  
 1527 (LIC) 001

TOLENT CONSTRUCTION LTD  
 TRAVELODGE - MADLSEK STREET HOTEL,  
 20 MADLSEK STREET, E1 7EX

LICENSING DRAWING

DRAWN:	DATE:	SCALE:	CHECKED:
DS	JAN 2018	1:100@A1	CM

Approved for use in accordance with the provisions of the Building Regulations 2010. This drawing is the property of ISA and is not to be used for any other purpose without the written consent of ISA. All dimensions are in millimetres unless otherwise stated.

# Appendix 3



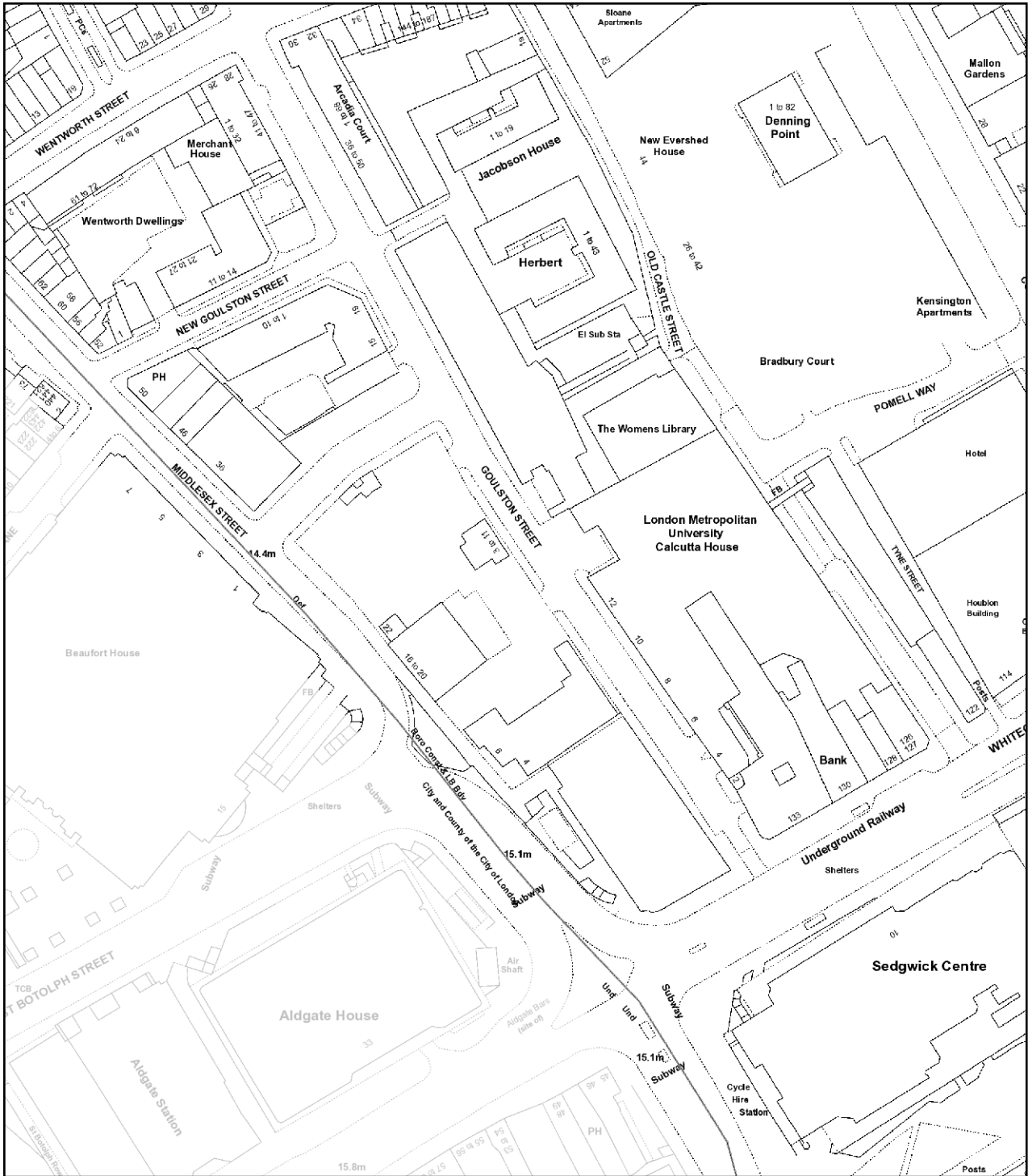

## 20 Middlesex Street



Scale 1:1537

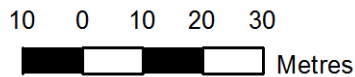

Produced by London Borough of Tower Hamlets on 14/03/2018. © Crown copyright and database rights 2012 Ordnance Survey, London Borough of Tower Hamlets 100019288.

# Appendix 4

**20 Middlesex Street – Nearest licences**

<b>Name and address</b>	<b>Licensable activities and hours</b>	<b>Opening hours</b>
<b>(Moo Grill)</b> 40 - 42 Middlesex Street	<p><b>The sale by retail of alcohol</b> Monday to Sunday, from 09:00 hours to 23:00 hours</p> <p><b>The provision of regulated entertainment - Indoors</b> <u>(Recorded music only)</u> Monday to Sunday, from 09:00 hours to 23:00 hours</p>	Monday to Sunday, from 06:30 hours to 23:00 hours
<b>(The Bell)</b> 50 Middlesex Street London E1 7EX	<p><b>The sale by retail of alcohol</b></p> <p><b>The provision of regulated entertainment consisting of:</b> <b>Recorded music, Live Music, Films</b></p> <p><b>The provision of late night refreshment:</b> Monday to Saturday from 10:00 hours to midnight Sunday from 08:00 hours to midnight</p> <p>An additional hour on 15 occasions per annum. Such occasions to be agreed in advance with the Licensing Authority on seven days notice.</p> <p>New Years Eve throughout the night until start of permitted hours on New Years Day</p>	<p>Monday to Saturday from 10:00 hours to 01:00 hours Sunday from 08:00 hours to 01:00 hours</p> <p>An additional hour on 15 occasions per annum. Such occasions to be agreed in advance with the Licensing Authority on seven days notice.</p> <p>New Years Eve throughout the night until start of permitted hours on New Years Day</p>
<b>(Co-Operative)</b> 74 – 80 Middlesex Street	<p><b>The sale by retail of alcohol</b> Monday to Sunday, from 07:00 hours to Midnight</p>	Monday to Sunday, from 07:00 hours to Midnight
<b>(HappyDays)</b> 44 Goulston Street	<p><b>The sale by retail of alcohol</b> Monday to Sunday 11 00 hrs to 23 00 hrs</p>	Monday to Sunday 11 00 hrs to 23 00 hrs



# Appendix 5

**Section 182 Advice by the Home Office  
Updated on April 2017**

Relevant, vexatious and frivolous representations

- 9.4 A representation is “relevant” if it relates to the likely effect of the grant of the licence on the promotion of at least one of the licensing objectives. For example, a representation from a local businessperson about the commercial damage caused by competition from new licensed premises would not be relevant. On the other hand, a representation by a businessperson that nuisance caused by new premises would deter customers from entering the local area, and the steps proposed by the applicant to prevent that nuisance were inadequate, would be relevant. In other words, representations should relate to the impact of licensable activities carried on from premises on the objectives. For representations in relation to variations to be relevant, they should be confined to the subject matter of the variation. There is no requirement for a responsible authority or other person to produce a recorded history of problems at premises to support their representations, and in fact this would not be possible for new premises.
- 9.5 It is for the licensing authority to determine whether a representation (other than a representation from responsible authority) is frivolous or vexatious on the basis of what might ordinarily be considered to be vexatious or frivolous. A representation may be considered to be vexatious if it appears to be intended to cause aggravation or annoyance, whether to a competitor or other person, without reasonable cause or justification. Vexatious circumstances may arise because of disputes between rival businesses and local knowledge will therefore be invaluable in considering such matters. Licensing authorities can consider the main effect of the representation, and whether any inconvenience or expense caused by it could reasonably be considered to be proportionate.
- 9.6 Frivolous representations would be essentially categorised by a lack of seriousness. Frivolous representations would concern issues which, at most, are minor and in relation to which no remedial steps would be warranted or proportionate.
- 9.7 Any person who is aggrieved by a rejection of their representations on either of these grounds may lodge a complaint through the local authority’s corporate complaints procedure. A person may also challenge the authority’s decision by way of judicial review.

- 9.8 Licensing authorities should not take decisions about whether representations are frivolous, vexatious or relevant to the licensing objectives on the basis of any political judgement. This may be difficult for councillors who receive complaints from residents within their own wards. If consideration is not to be delegated, contrary to the recommendation in this Guidance, an assessment should be prepared by officials for consideration by the sub- committee before any decision is taken that necessitates a hearing. Any councillor who considers that their own interests are such that they are unable to consider the matter independently should disqualify themselves.
- 9.9 It is recommended that, in borderline cases, the benefit of the doubt about any aspect of a representation should be given to the person making that representation. The subsequent hearing would then provide an opportunity for the person or body making the representation to amplify and clarify it.
- 9.10 Licensing authorities should consider providing advice on their websites about how any person can make representations to them.

# Appendix 6

---

**From:** Jon Shapiro [REDACTED]  
**Sent:** 22 February 2018 13:45  
**To:** Licensing  
**Subject:** Licensing Application by "Travelodge London City", 20 Middlesex Street, E1 7EX

Dear Sir or Madam,

I would like to request that aspects of this Licence Application should be reduced and/or removed on the grounds of:

- The prevention of crime and disorder
- Public safety
- The prevention of public nuisance.

I would like to see two restrictions placed on the requested licence application:

1. I believe that there are already far too many premises selling "off-sales" alcohol within Spitalfields & Banglatown, and request that "off-sales" should be refused.  
(I fully accept that the premises are outside the Brick Lane "Cumulative Impact Zone" (CIZ) but I see no need for them to require "off-sales".)
2. I think the hours restricted to selling alcohol to "hotel residents and bona fide guests of hotel residents" should be increased to:  
**22.00 to 10.00**  
rather than allowing the requested 23.00 to 10.00.

Spitalfields & Banglatown absolutely does not need any additional "off-sales" outlets which inevitably could have an impact extending into the Brick Lane area CIZ.

The Brick Lane area has always been stated by our Borough Police Commanders to be the "number one policing problem in Tower Hamlets". Until and unless this area ceases to be such a policing problem I believe that additional "Off-Sales" licences should not be granted to any premises more premises within Spitalfields & Banglatown.

The Brick Lane area is plagued by ASB and hospital admissions to A&E, and I believe that the Licensing Committee should be assisting the Police and other authorities in reducing any and all encouragement to provide increase the consumption of alcohol by drinkers anywhere nearby.

For the reasons quoted above I request that the two restrictions above should be made to the Licence granted to "Travelodge London City".

Yours faithfully,  
Jon Shapiro.

Resident at:

[REDACTED]  
[REDACTED]  
[REDACTED]  
[REDACTED]  
[REDACTED]

# Appendix 7

## Catrina Marshall

---

**From:** Dick Tyler [REDACTED]  
**Sent:** 23 February 2018 15:14  
**To:** Licensing  
**Subject:** Objection to licensing application for "Travelodge London City", 20 Middlesex Street, E1 7EX

**Follow Up Flag:** Follow up  
**Flag Status:** Completed

Dear Licensing Department,

I wish to object to the licensing application for "**Travelodge London City**", 20 Middlesex Street, E1 7EX on the grounds of the prevention of public nuisance, public safety and the prevention of crime and disorder.

I believe that applications within the Brick Lane CIZ should only be approved for the following hours:

- Sunday to Wednesday: Alcohol until midnight, food until midnight, close at 00:30
- Thursday to Saturday: Alcohol until 00:30, food until 01:00 and close at 01:30
- Licences for off sales should only be granted where the applicant can show a clear need for them and, if granted, that they should only extend until 22:00.

I also believe that licences should be refused or more restrictive hours imposed where there is a history of anti-social behaviour associated with the applicant.

The application is for both on and "**off-sales**" 24 hours a day, seven days a week. If the Licensing Committee grants a licence at all, it should conform to the above criteria.

Yours sincerely,

Dick Tyler  
[REDACTED]

**Dick Tyler**  
[REDACTED]  
[REDACTED]  
[REDACTED]  
[REDACTED]  
[REDACTED]

# Appendix 8



## **Anti-Social Behaviour from Patrons Leaving the Premises**

### General Advice

Members need to bear in mind that once patrons have left a premises they are no longer under direct control. Members will need to be satisfied that there is a link between the way the premises is operating and the behaviour that is complained of. An example of this would be that irresponsible drinking is being encouraged. Before deciding that any particular licensing conditions are proportionate, Members will also need to be satisfied that other legislation is not a more effective route. For example, if the problem is drinking in the street it may be that the Council should designate the area as a place where alcohol cannot be consumed in public.

Members may also wish to consider whether the hours of opening relate to any problems of anti-social behaviour.

If Members believe that there is a substantial problem of anti-social behaviour and it cannot be proportionately addressed by licensing conditions they should refuse the application.

### Licensing Policy

The policy recognises that other legislation or measures may be more appropriate but also states that licensing laws are “a key aspect of such control and will always be part of an overall approach to the management of the evening and night time economy” (**see Section 4.15 and 4.16 of the Licensing Policy**).

The Licensing Authority expects the applicant to have addressed all crime and disorder issues relating to the premises in their operating schedule and to have sought appropriate advice. (**See Sections 6.2 of the Licensing Policy**)

The Licensing Authority will consider attaching conditions to deter crime and disorder and these may include Conditions drawn from the Model Poll of Conditions relating to Crime and Disorder. (**See Appendix 3 of the Licensing Policy**). In particular Members may wish to consider (this list is not exhaustive):

- Bottle Bans
- Plastic containers
- CCTV (outside the premises)
- Restrictions on open containers for “off sales”
- Proof of Age scheme
- Crime prevention notices
- Drinks promotions-aimed at stopping irresponsible promotions
- Signage

## Cumulative Impact

There is a process by which the Licensing Authority can determine that an area is saturated following representations. However, the process for this involves wide consultation and cannot come from representations about a particular application. (**See Section 8 of the Licensing Policy**).

## Police Powers

The Licensing Act 2003, Part 8 gives a senior police officer the power to close a premises for up to 24 hours where the officer believes there is, or is likely to be disorder on or in the vicinity and closure is necessary in the interests of public.

## Guidance Issued under Section 182 of the Licensing Act 2003

The key role of the Police is acknowledged (2.1).

Conditions attached to licences cannot seek to manage the behaviour of customers once they are beyond the direct management of the licence holder, but can relate to the immediate vicinity of the premises as they seek entry or leave (1.16).

Conditions are best targeted on deterrence and preventing crime and disorder (2.3) CCTV inside & out, communication, police liaison, no glasses are all relevant

There is also guidance issued around public nuisance (2.15 – 2.21).

The pool of conditions, adopted by the Council is recommended (see Appendix 3 of the Licensing Policy). Licence conditions should not duplicate other legislation (1.16).

Necessary and appropriate conditions should normally focus on the most sensitive periods and may address disturbance as customers enter or leave the premises but it is essential that conditions are focused on measures within the direct control of the licence holder (2.18/2.21).

Licensing law is not the primary mechanism for the general control of nuisance and anti-social behaviour by individuals once they are away from the licensed premises and, therefore, beyond the direct control of the individual, club or business holding the licence, certificate or authorisation concerned (14.13).

## Other Legislation

### Crime and Disorder Act 1998

The Council has a duty under Section 17 of the Crime and Disorder Act 1998 to do all it reasonably can to prevent crime and disorder.

The Act also introduced a wide range of measures designed to address anti-social behaviour committed by adults and young people. These include:

- Anti-Social Behaviour Orders
- Child Curfew Schemes
- Truancy
- Parenting Orders
- Reparation Orders
- Tackling Racism

# Appendix 9

## Licensing Policy

### **8 Special Cumulative Impact Policy for the Brick Lane Area**

- 8.1 As with many other London Borough's the majority of late night licensed premises are concentrated within one area of the Borough. Following guidance issued under the Licensing Act 2003 a cumulative impact policy was adopted on 18th September 2013 by the Council.
- 8.2 After consultation the Council recognises that because of the number and density of licensed premises selling alcohol, on and off the premises and the provision of late night refreshment (sale of hot food after 11pm) within the Brick Lane Area as defined in Figure One, there might be exceptional problems of nuisance, disturbance and/or disorder outside or away from those licensed premises as a result of their combined effect.
- 8.3 The Licensing Authority is now of the view that the number, type and density of premises selling alcohol for consumption on and off the premises and/or the provision of late night refreshment in the area highlighted in Figure One is having a cumulative impact on the licensing objectives and has therefore declared a cumulative impact zone.
- 8.4 The effect of this Special Cumulative Impact Policy is to create a rebuttable presumption for applications in respect of the sale or supply of alcohol on or off the premises and/or late Night Refreshment for new Premises Licences, Club Premises Certificates or Provisional Statements and applications for variations of existing Premises Licences, Club Premises Certificates (where the modifications are relevant to the issue of cumulative impact for example increases in hours or capacity). Where the premises are situated in the cumulative impact zone and a representation is received, the licence will be refused. To rebut this presumption the applicant would be expected to show through the operating schedule and where appropriate with supporting evidence that the operation of the premises will not add to the cumulative impact already being experienced. This policy does not act as an absolute prohibition on granting/varying new licences in the Cumulative Impact Zone.
- 8.5 The Special Cumulative Impact policy will not be used to revoke an existing licence or certificate and will not be applicable during the review of existing licences.

Figure One

**The Cumulative Impact Zone in the Brick Lane area**

The Cumulative Impact Zone is detailed in the map below. The map shows all of the premises (dots) currently licensed under the Licensing Act 2003 in the Brick Lane Area. The Cumulative Impact Zone is defined by the dark line.

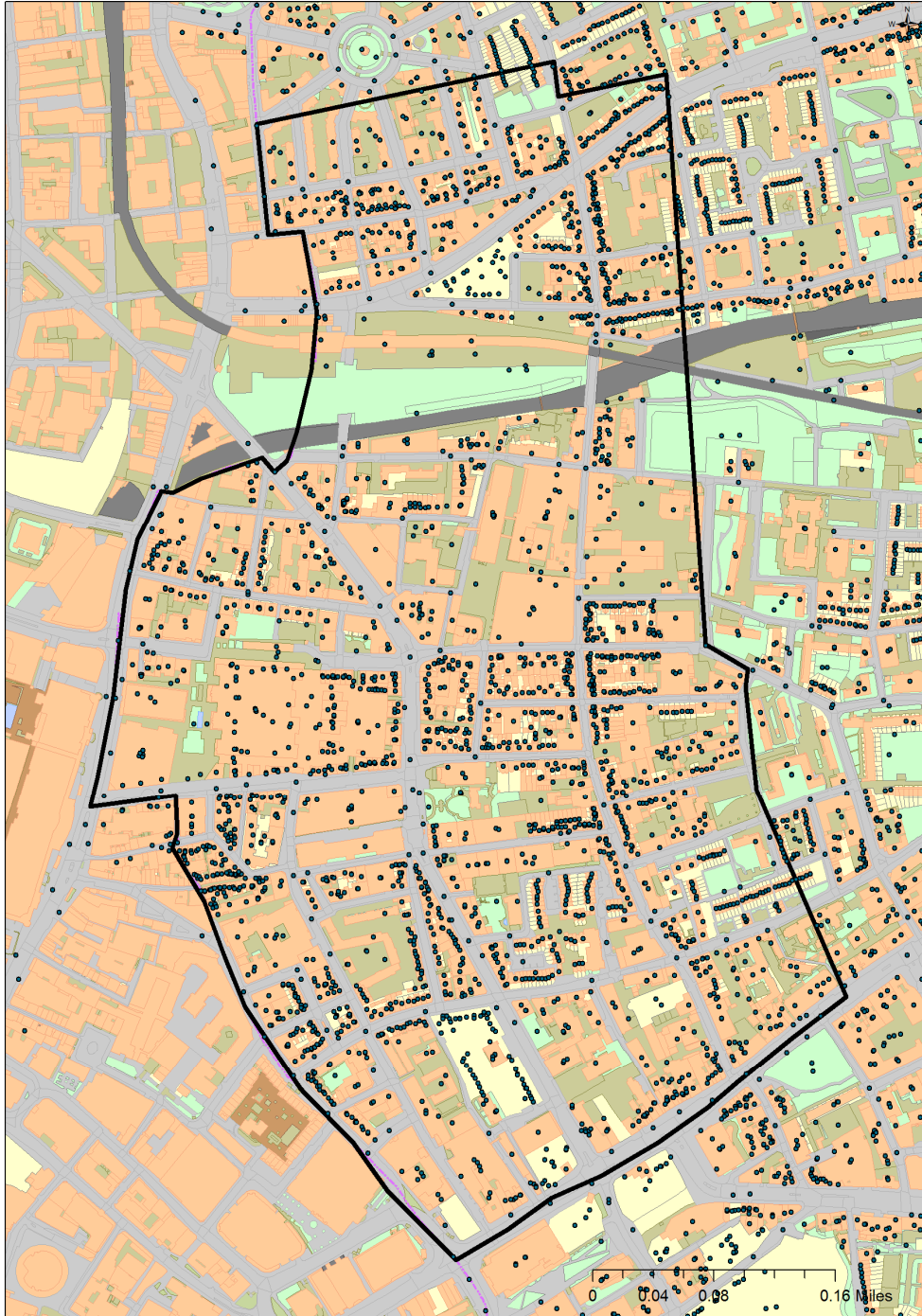



# Cumulative Impact Zone

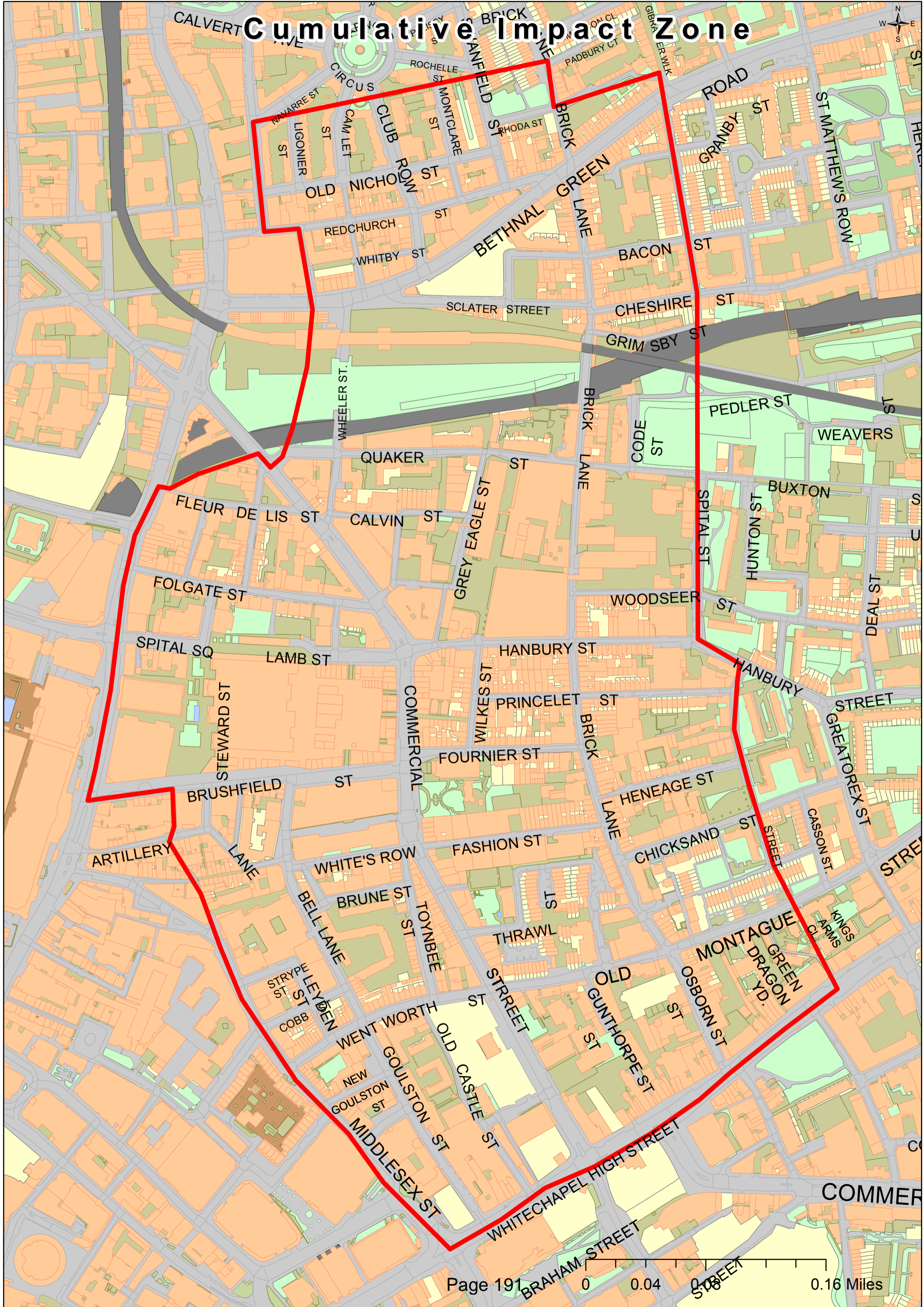

# Appendix 10



## **Planning**

An application for a Premises Licence can be made in respect of a premises even where the premises does not have relevant Planning Permission. That application has to be considered and Members can only refuse the application where the application itself does not promote one of more of the Licensing Objectives. Members cannot refuse just because there is no planning permission. Where a Premises Licence is granted and which exceeds what is allowed by the Planning Permission and that Premises then operates in breach of planning then the operator would be liable to enforcement by Planning.

# Appendix 11

### **Licensing Policy Relating to Hours of Trading**

All applications have to be considered on their own merits.

The Council has however adopted a set of framework hours as follows:

- Monday to Thursday, from 06:00 hrs to 23:30 hrs
- Friday and Saturday, from 06:00 hrs to 00:00 hrs (midnight)
- Sunday, from 06:00 hrs to 22:30 hrs

(see 15.8 of the Licensing Policy)

In considering the applicability of frame work hours to any particular application regard should be had to the following

- Location
- Proposed hours of regulated activities, and the proposed hours the premises are open to the public
- The adequacy of the applicant's proposals to deal with issues of crime and disorder and public nuisance
- Previous history
- Access to public transport
- Proximity to other licensed premises, and their hours

(See 15.9 of the licensing policy)

Subject to any representations to the contrary in individual cases the following premises are not generally considered to contribute to late night anti-social behaviour and will therefore generally have greater freedom

- Theatres
- Cinemas
- Premises with club premises certificates

This page is intentionally left blank